

JUMPING RECTANGULAR 14

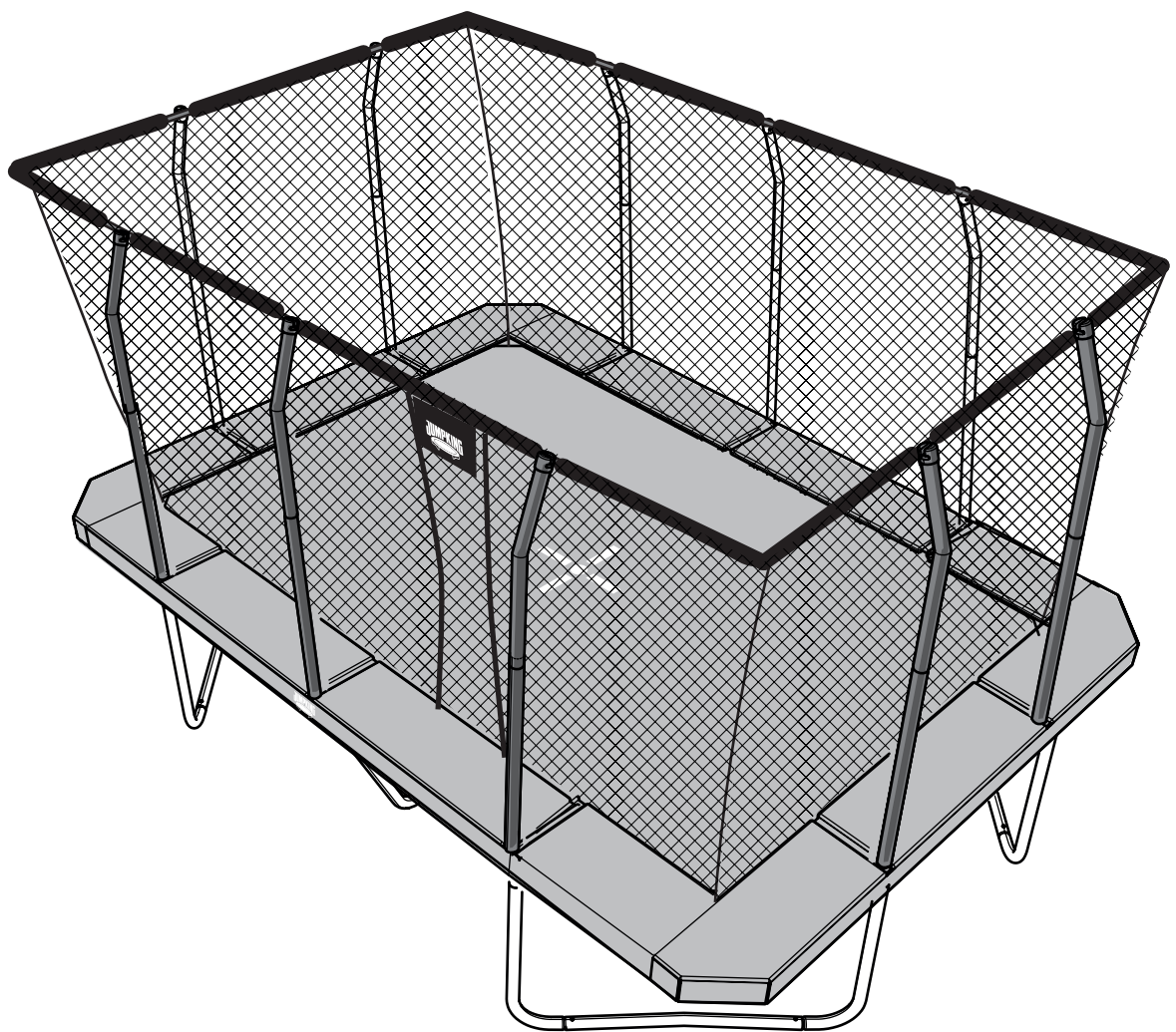

Jumpking Studsmattor Sweden AB is not liable or bound by warranty if these instructions are not adhered to during assemble, or if the equipment is modified without written consent from the manufacturer.

Copyright © 2020 Jumpking Studsmattor Sweden AB

Jumpking Studsmattor Sweden AB can accept no responsibility for possible errors in catalogues, brochures and other printed material. Jumpking Studsmattor Sweden AB reserves the right to alter its products without notice. This also applies to products already on order provided that such alterations can be made without sub sequential changes being necessary in specifications already agreed.

All rights reserved.

All other trademarks are the properties of their respective owners.

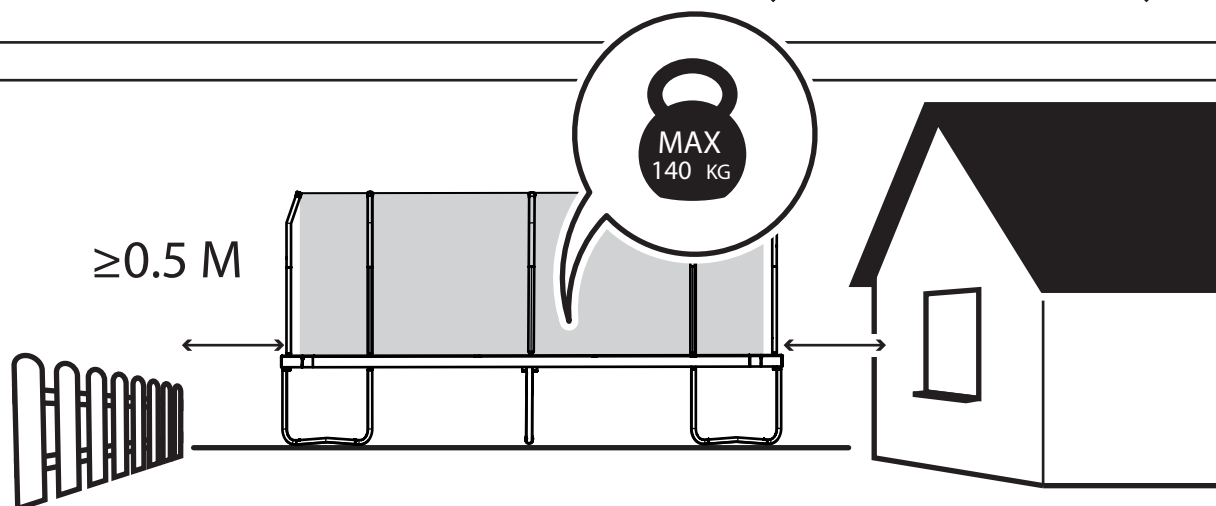
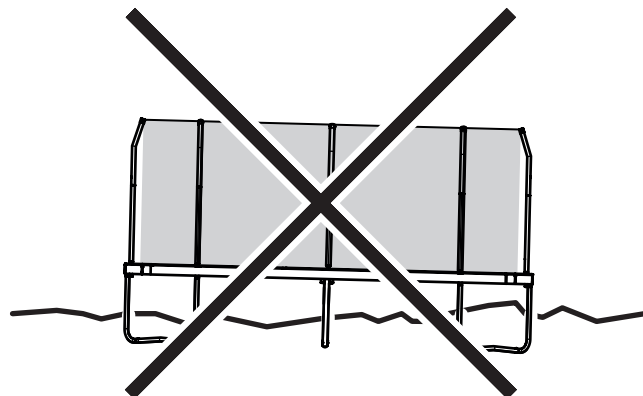
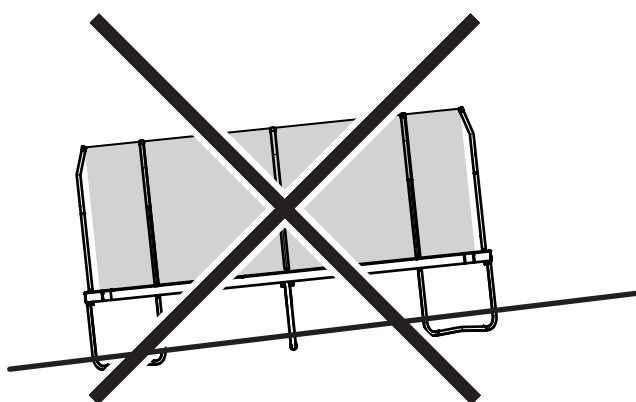
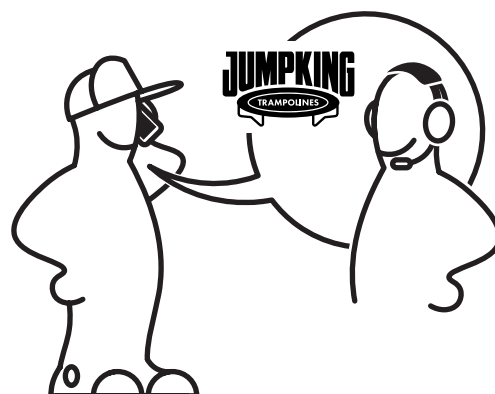
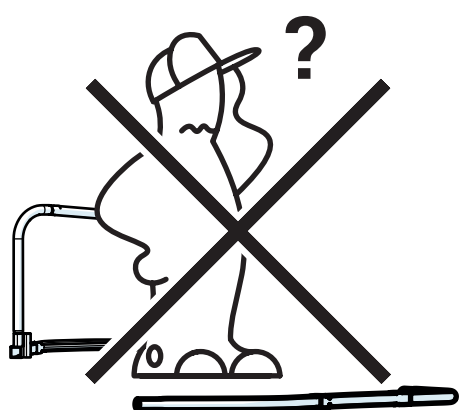
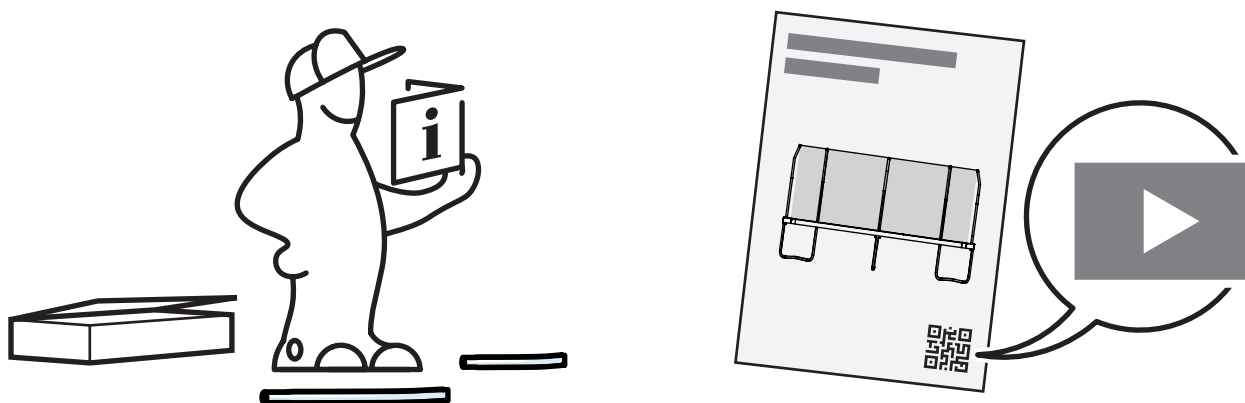

For information regarding care and maintenance, visit your local Jumpking website.

ASSEMBLE THE CORNER SECTIONS

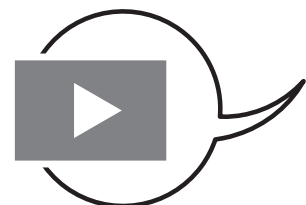
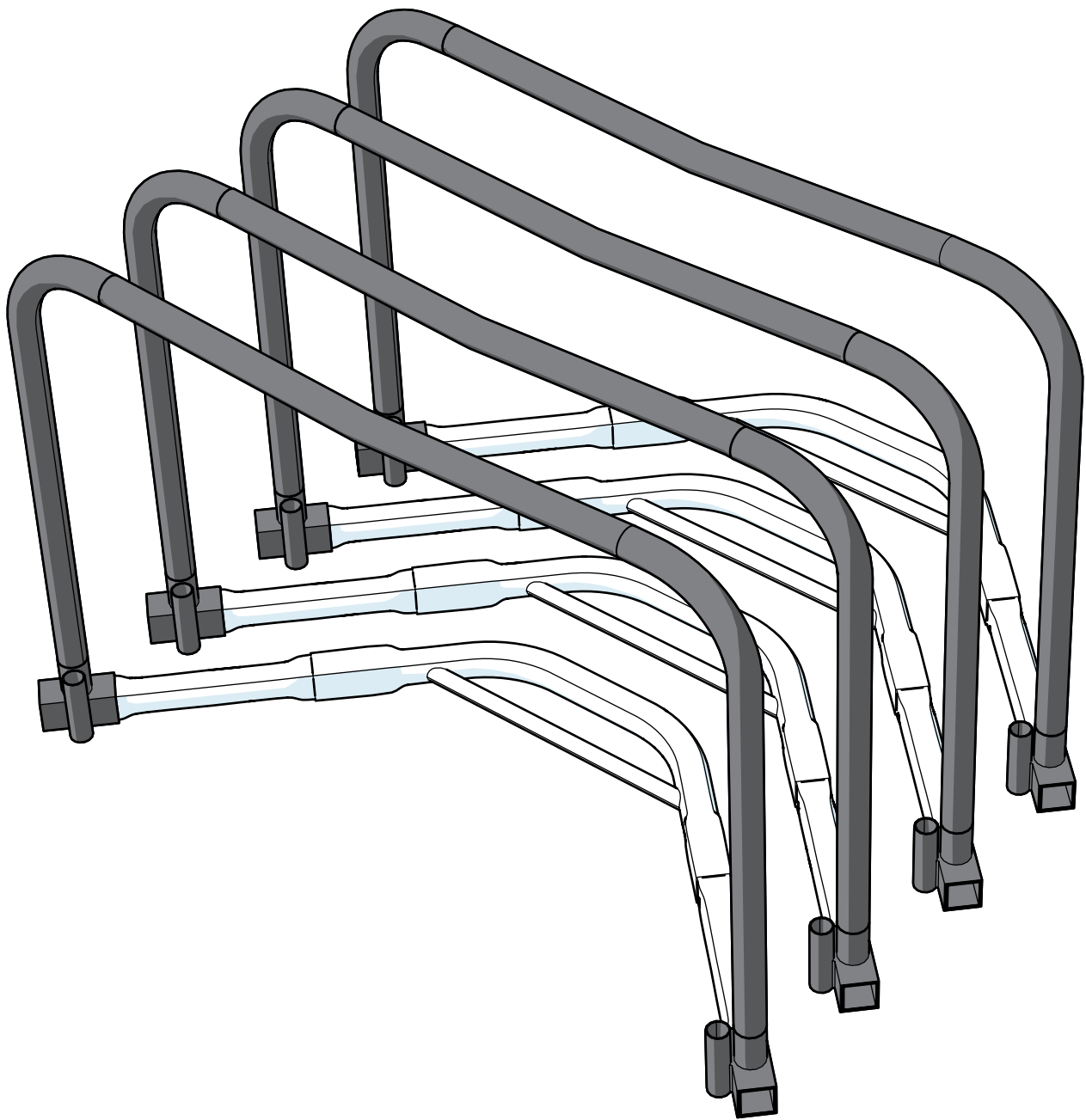

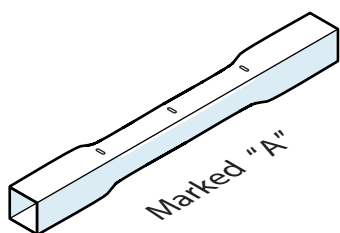
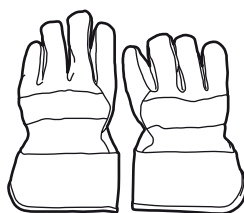
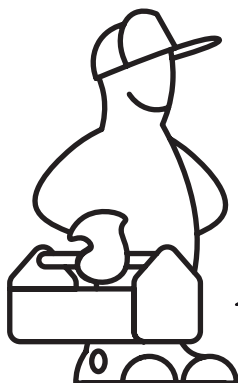

x8
(box 2)

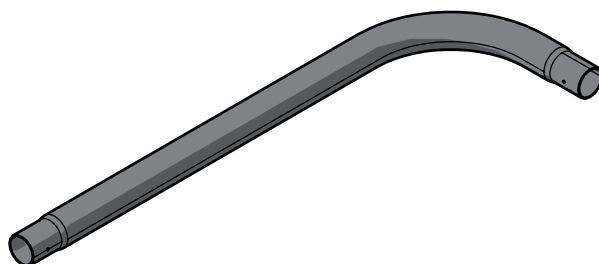

x8
(box 1)

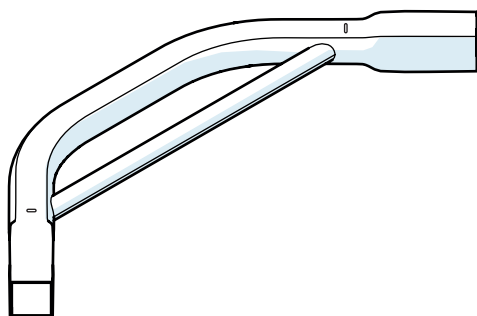

x4
(box 2)

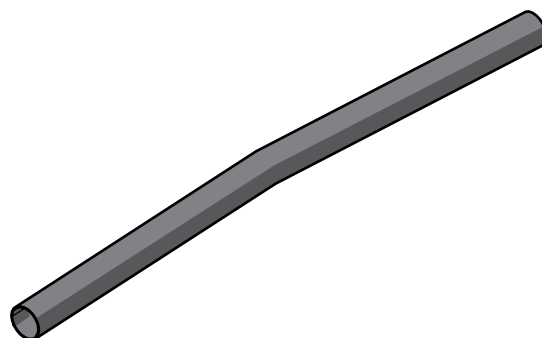

x4
(box 1)



x16
(box 1)

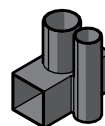

x8
(box 2)

1

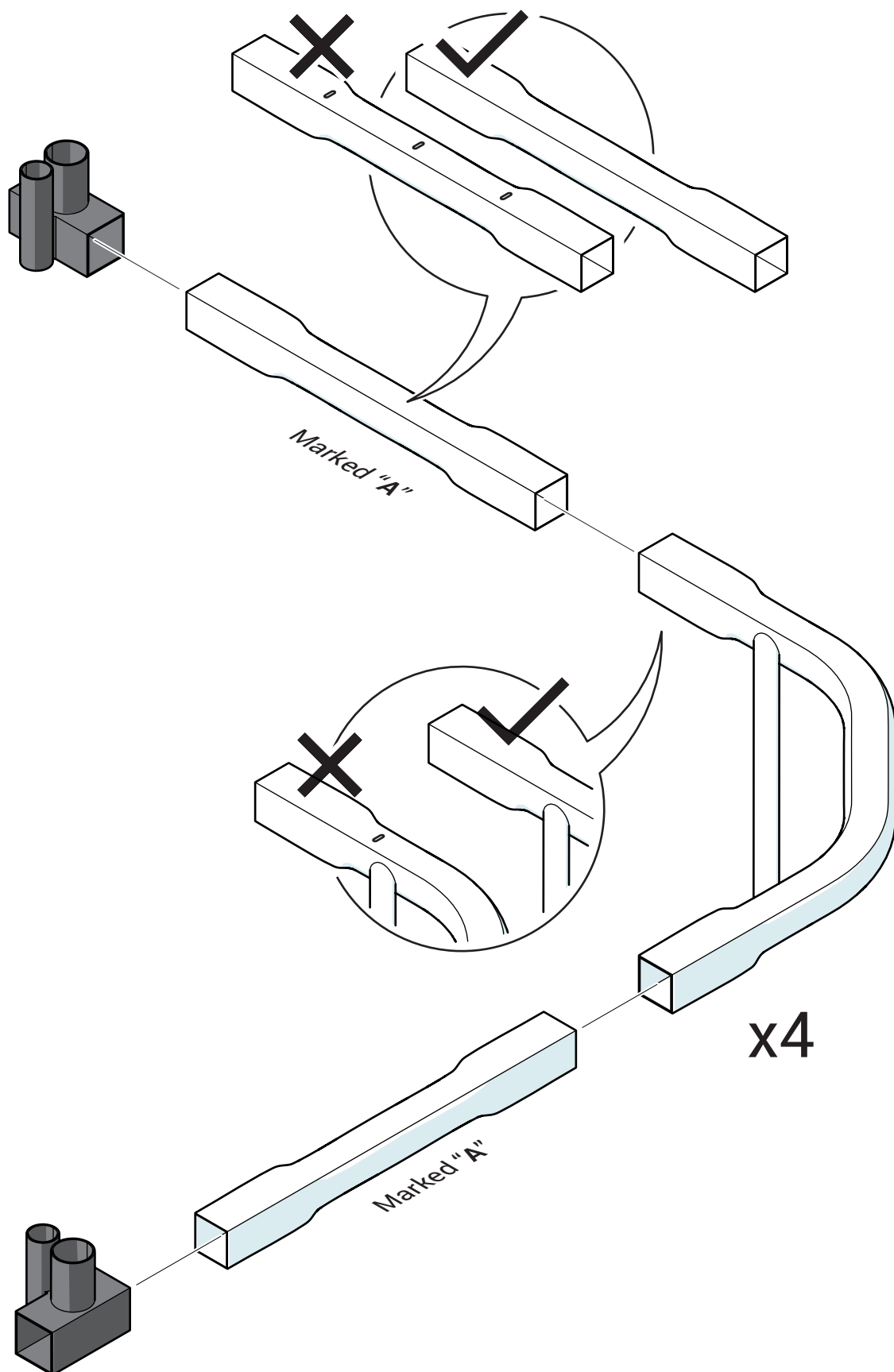

2

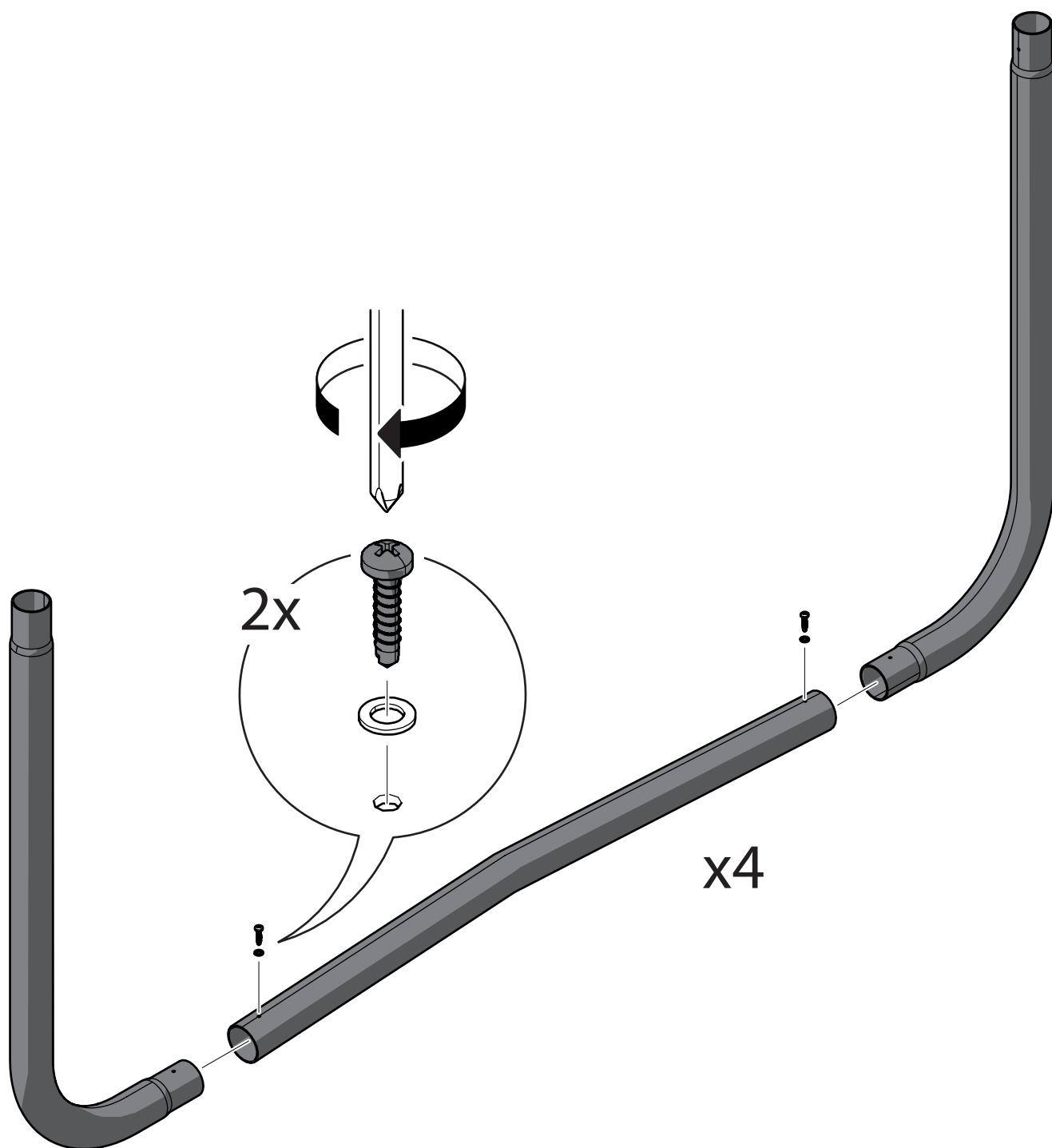

3

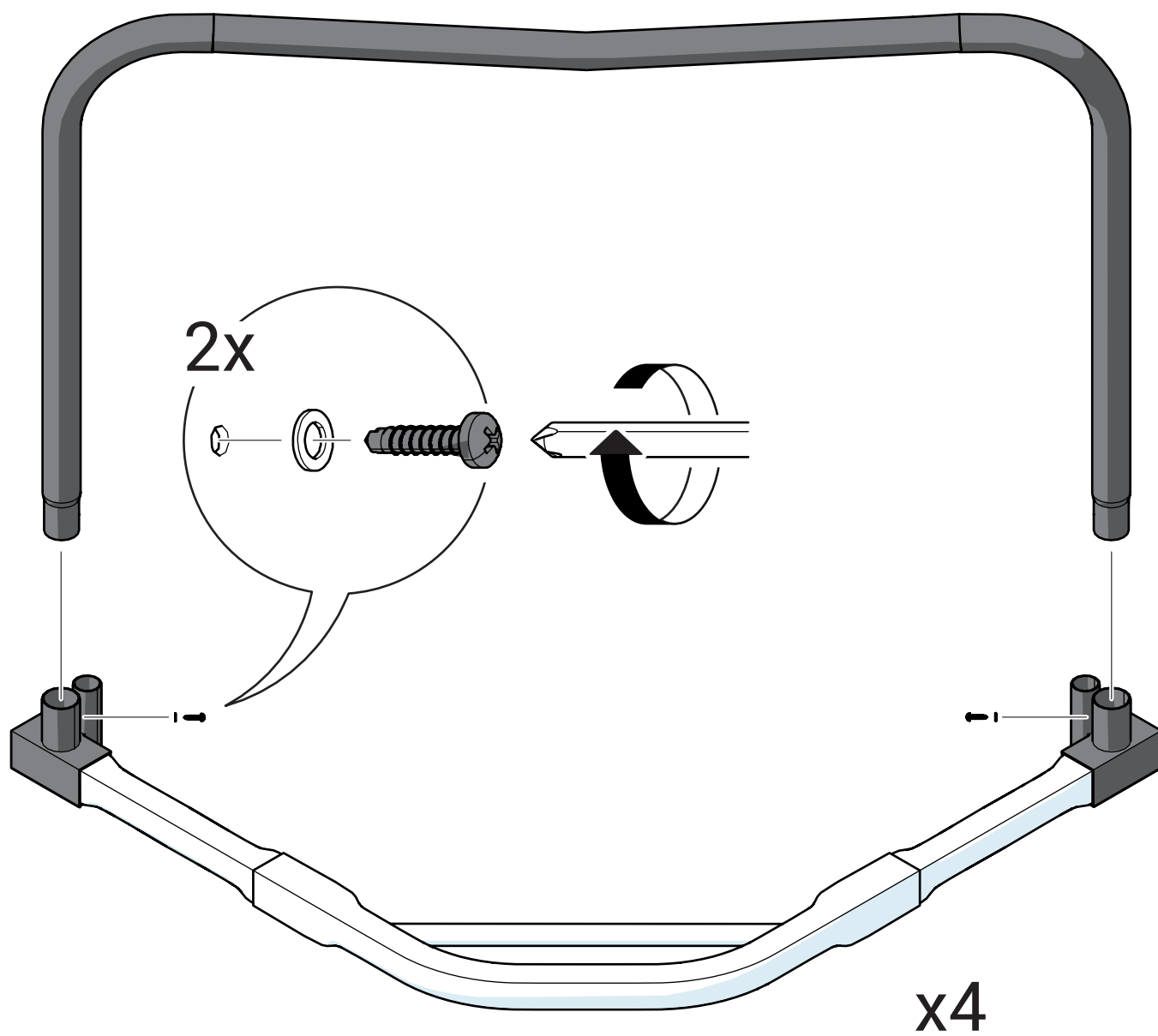

ASSEMBLE THE CENTRE SUPPORT SECTION



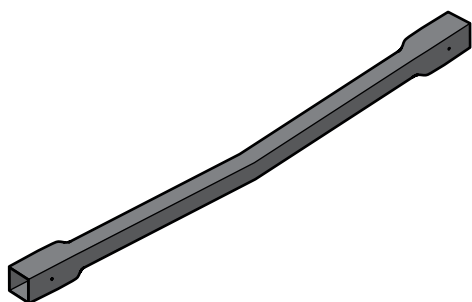
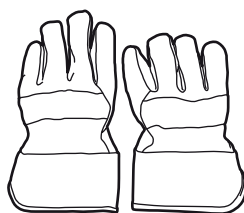
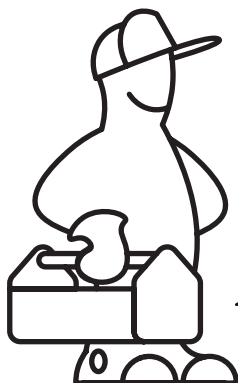

x1
(box 1 and 3)

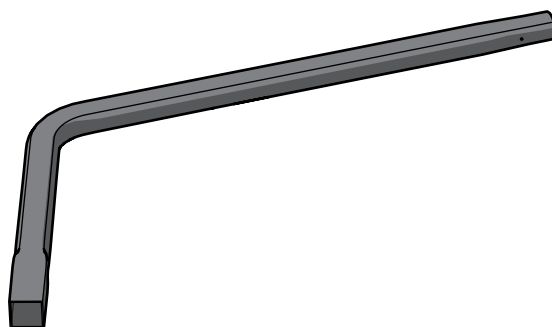

x2
(box 1 and 3)

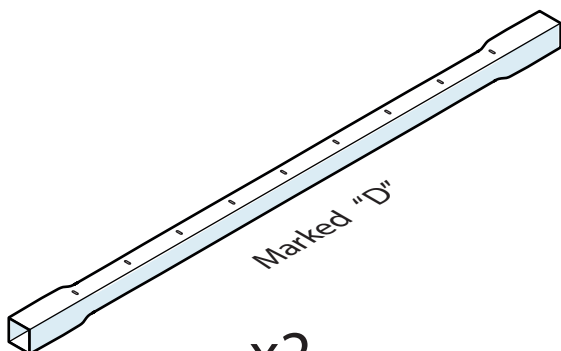

x2
(box 3)

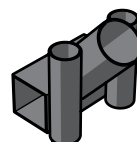

x2
(box 3)



x4
(box 1)

1

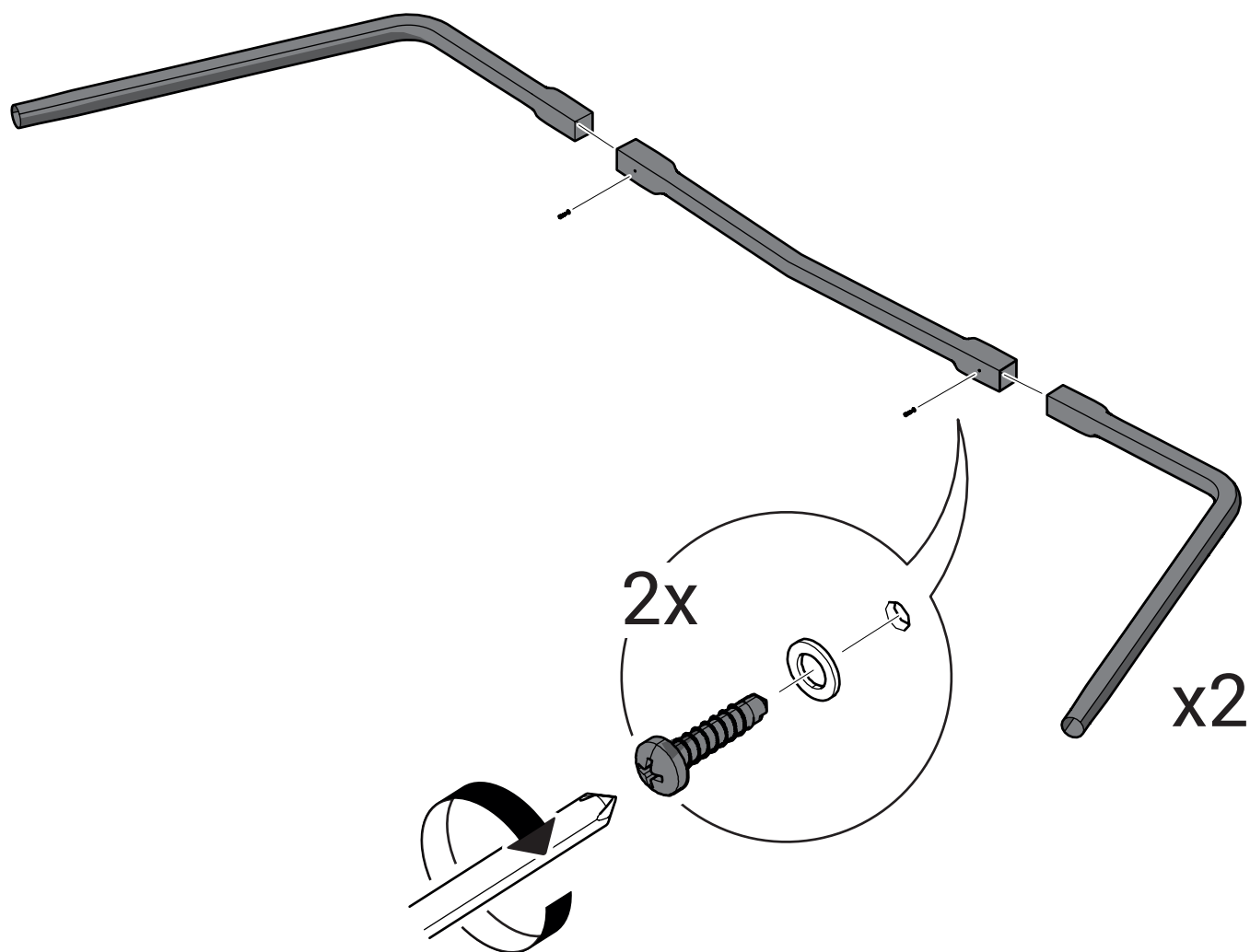

2

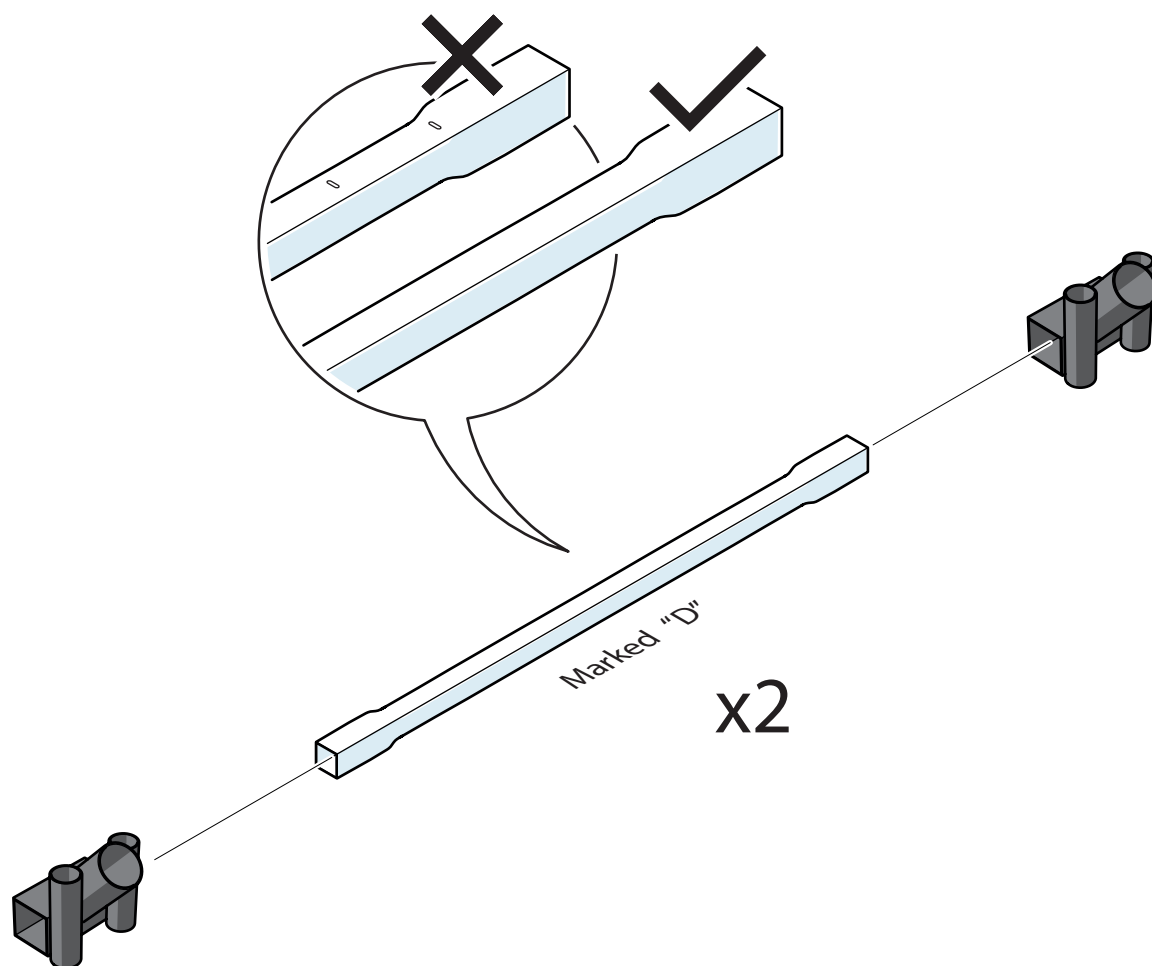

3

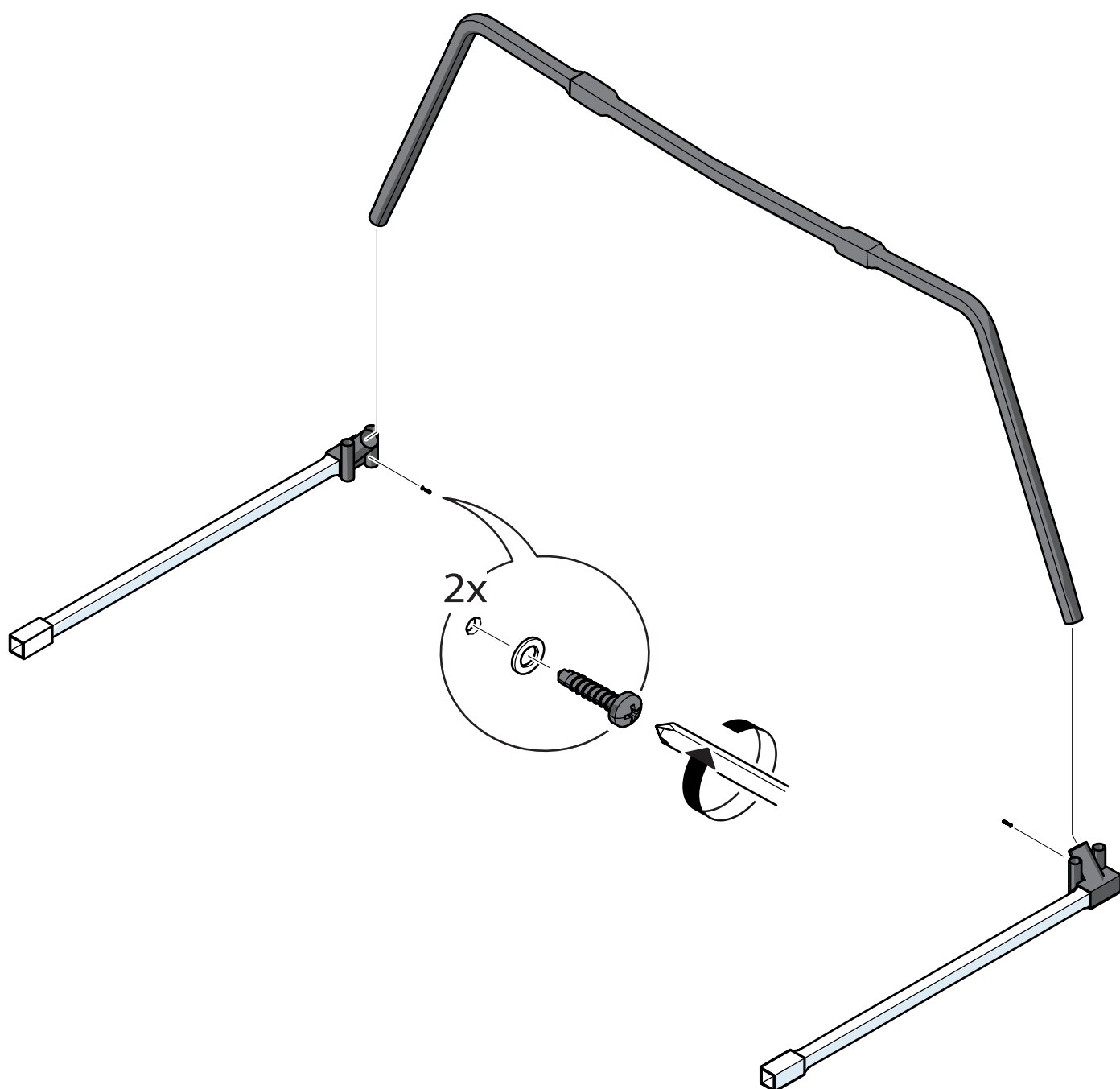

ASSEMBLE THE FRAME

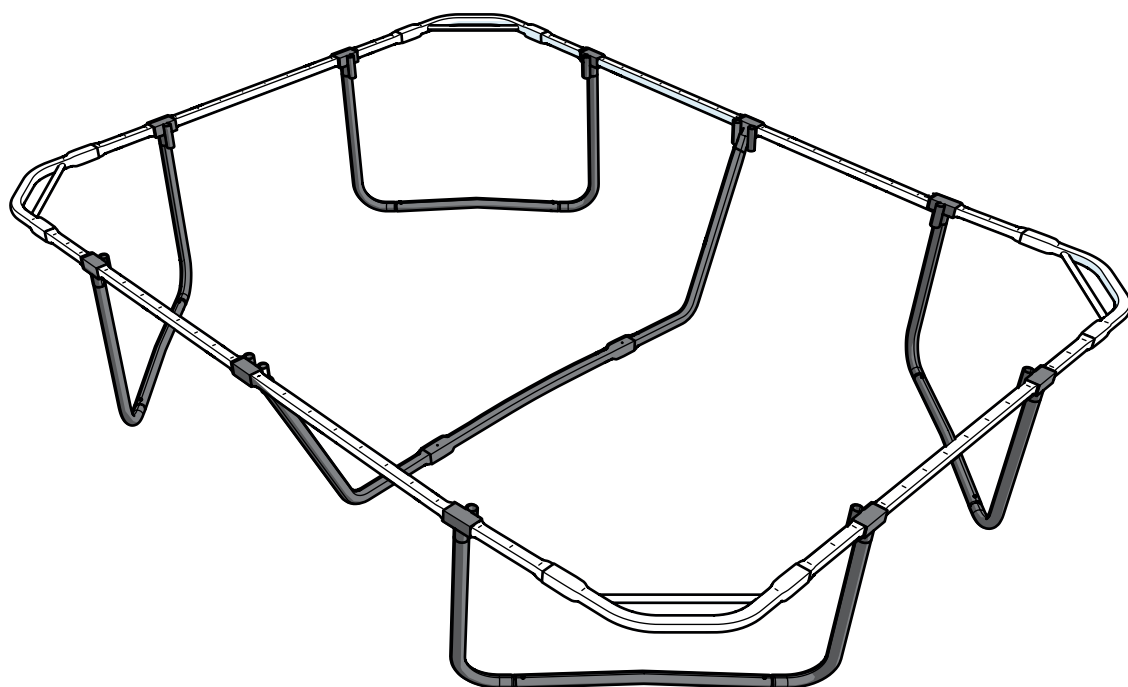

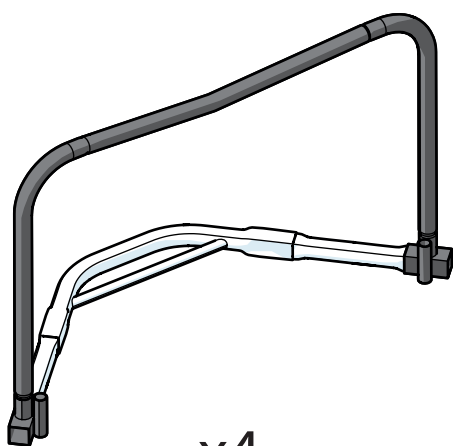
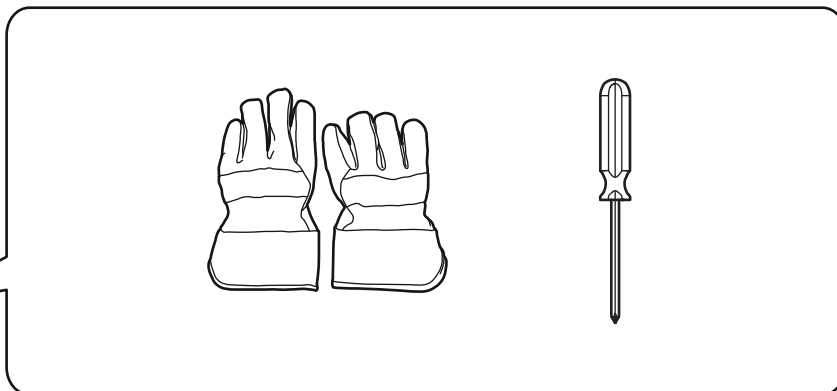
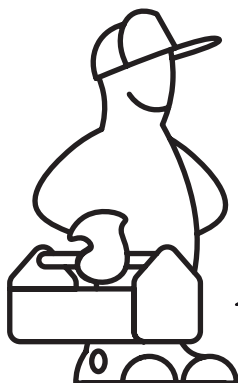

x4



x1

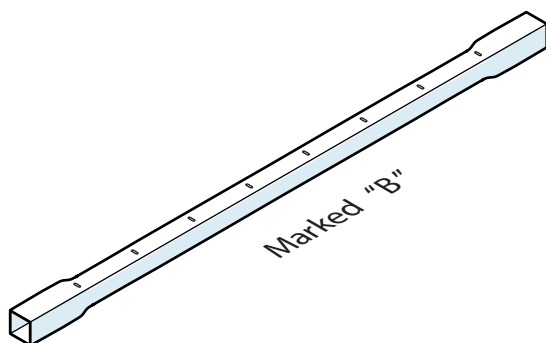

x4
(box 3)

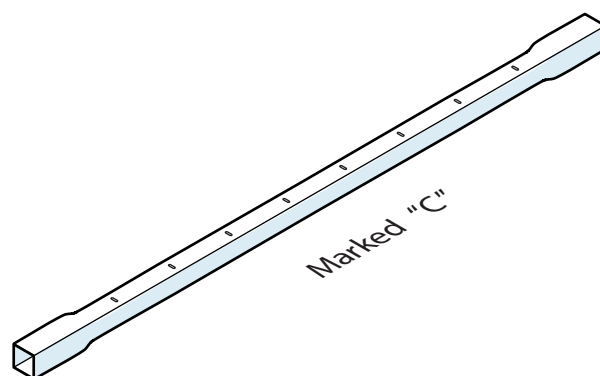

x2
(box 2)

1

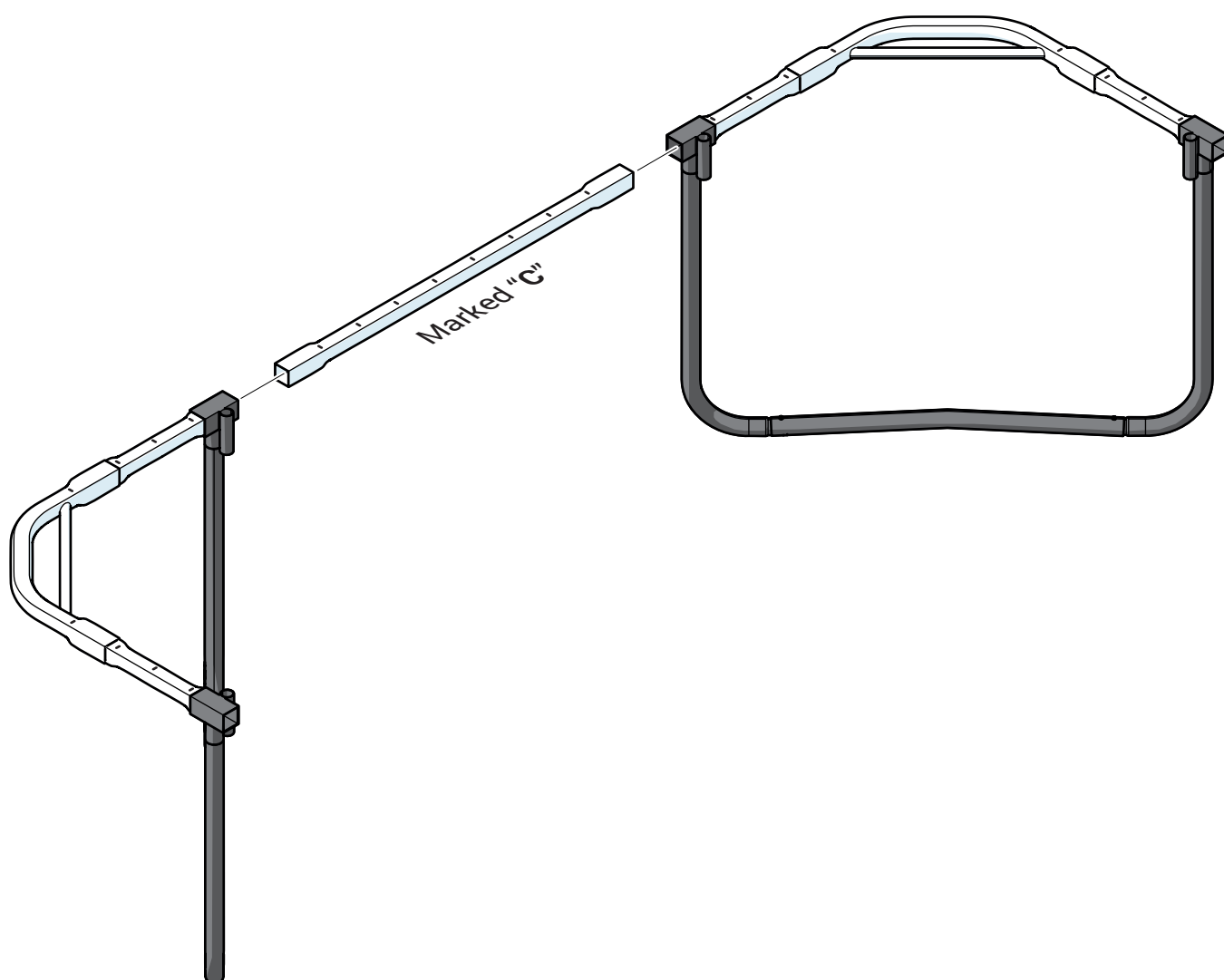

2

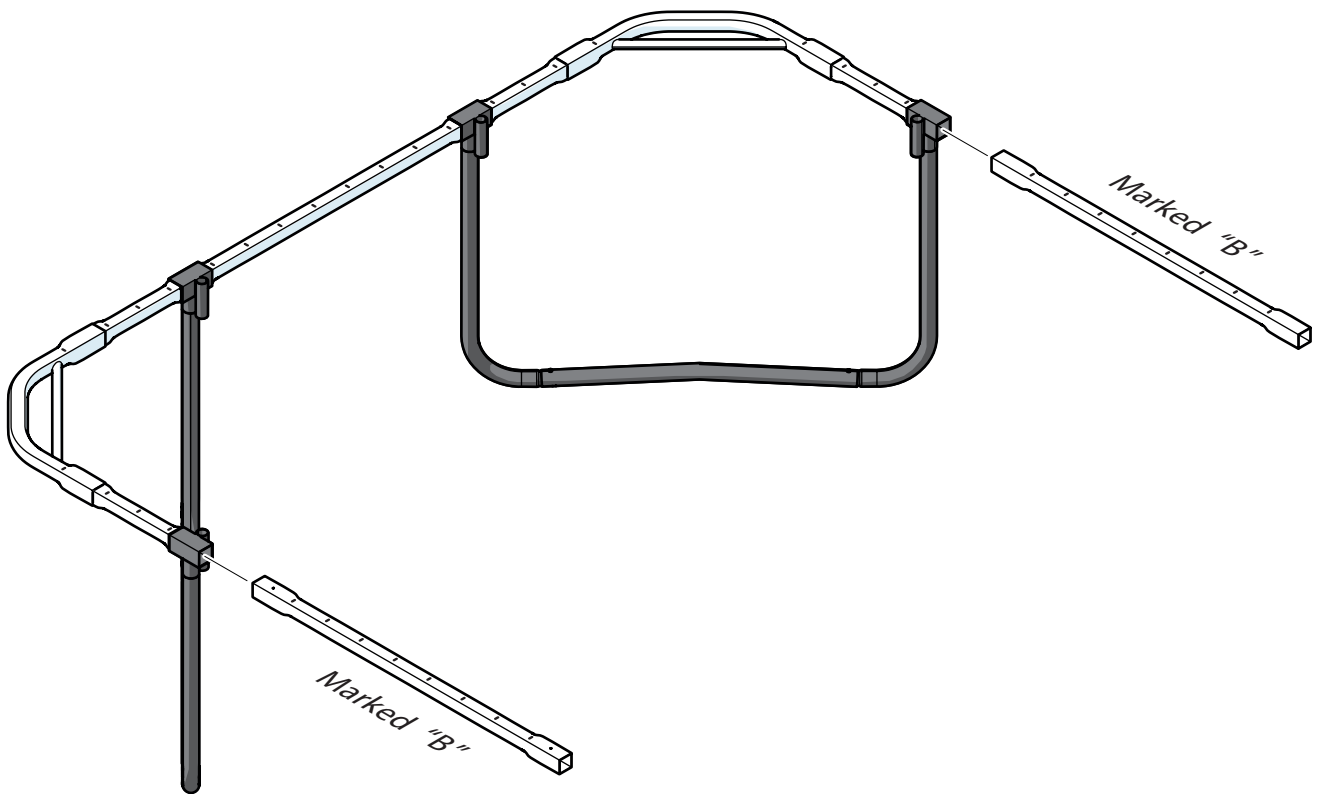

3

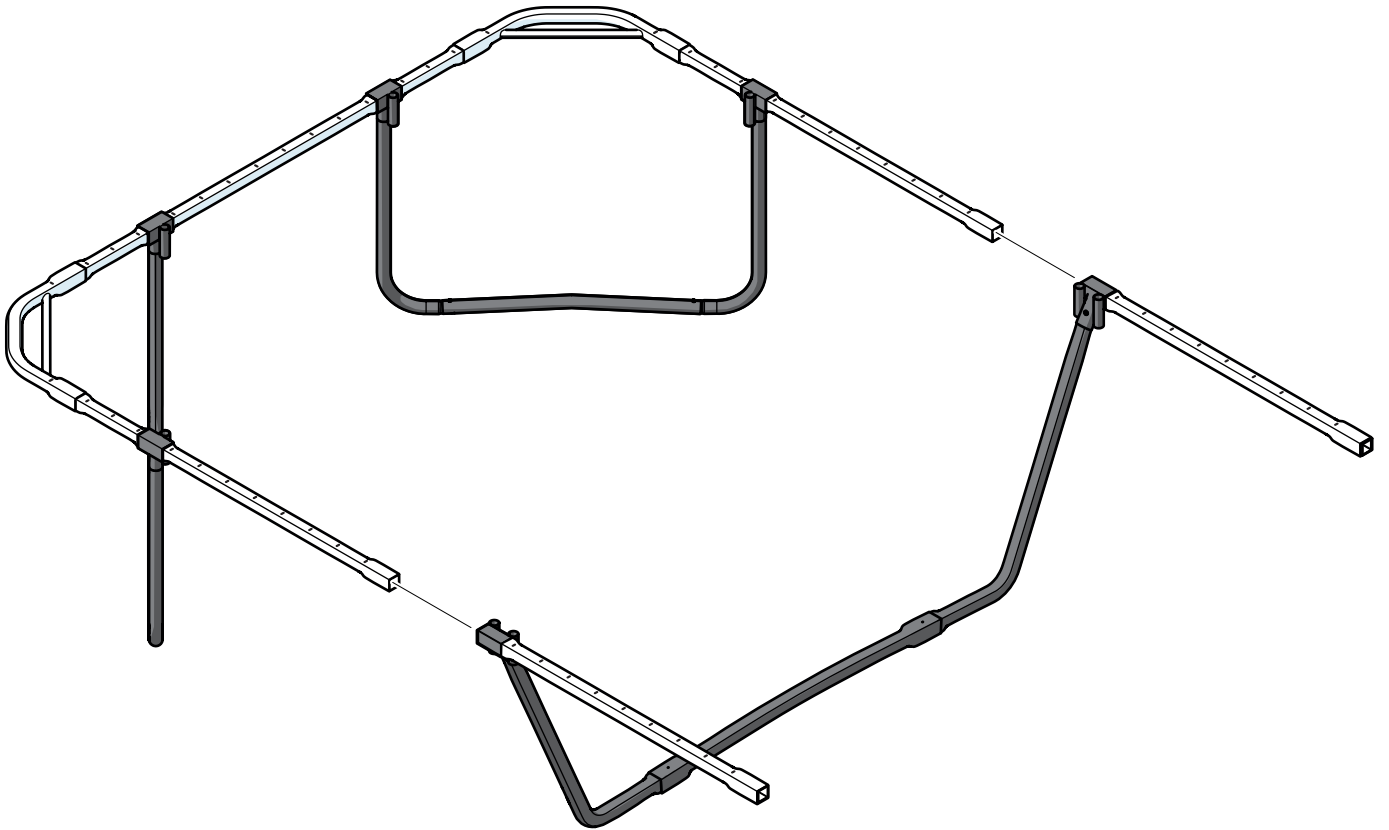

4

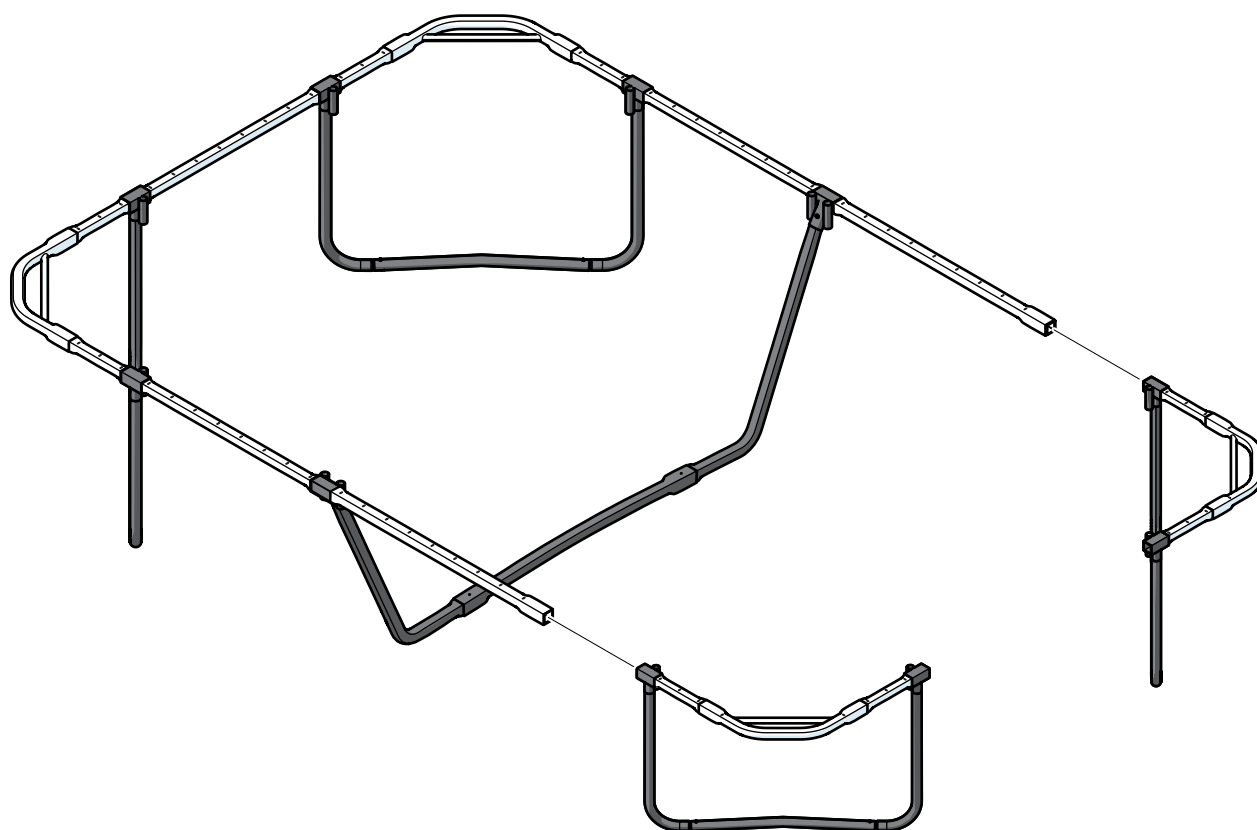

6

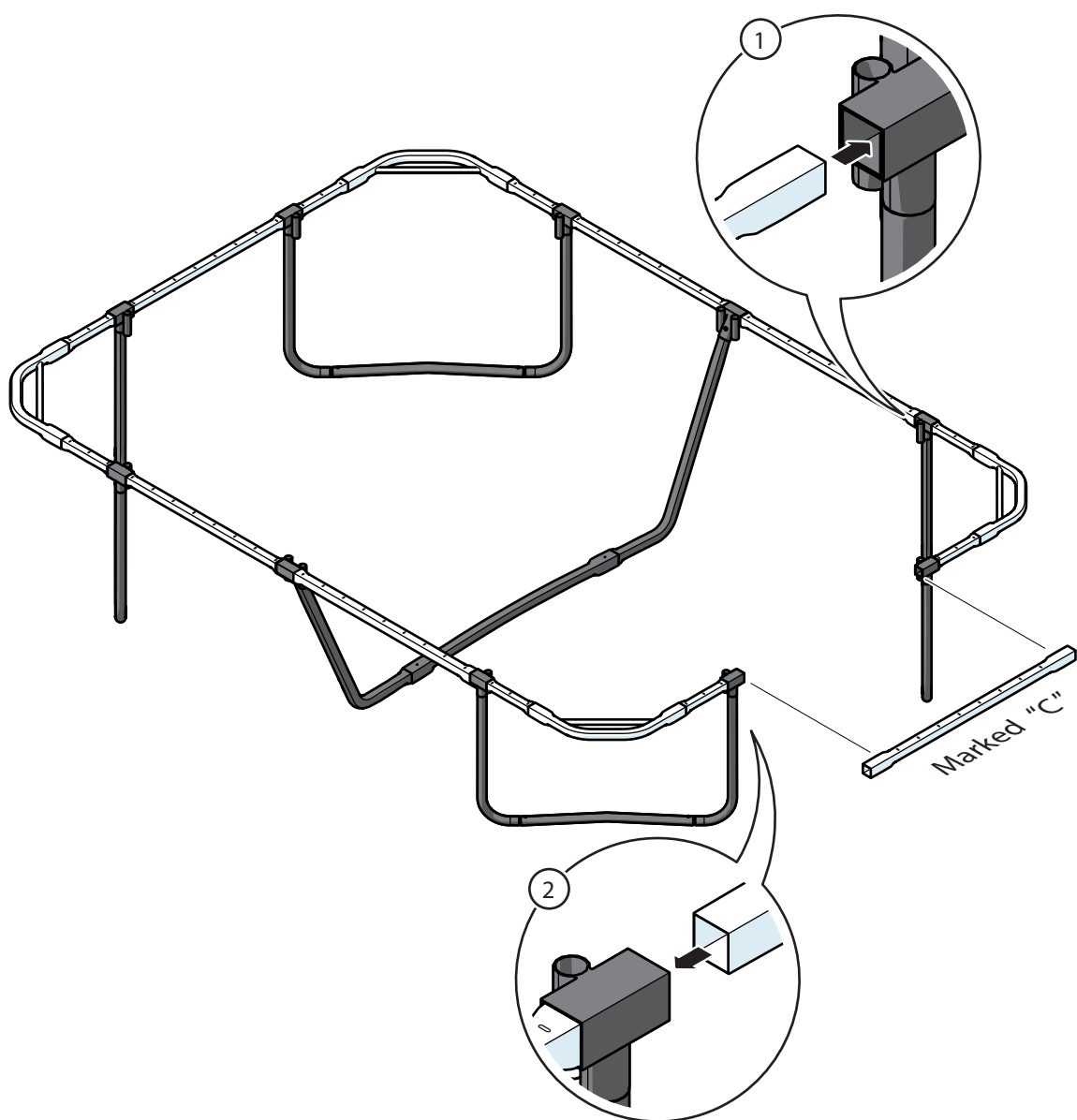

ATTACH THE STITCHED BED

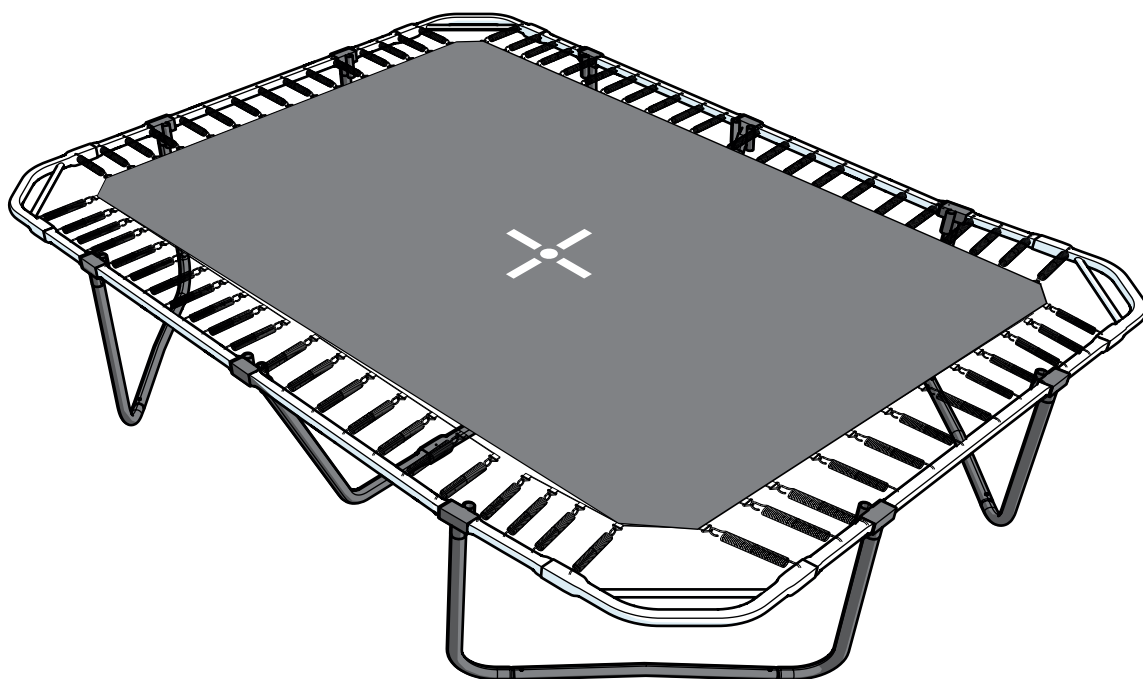

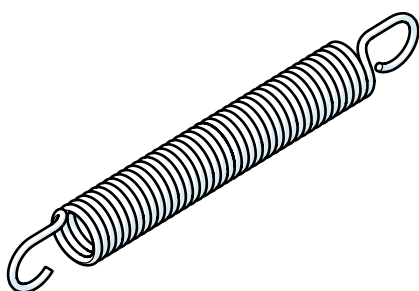
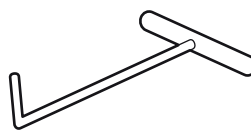
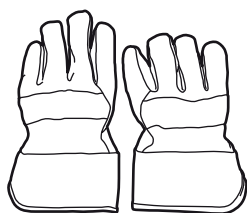
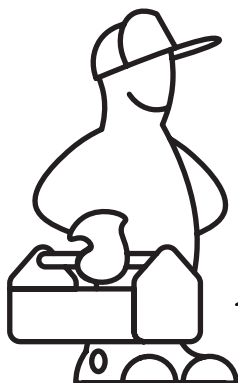

x80
(box 3)

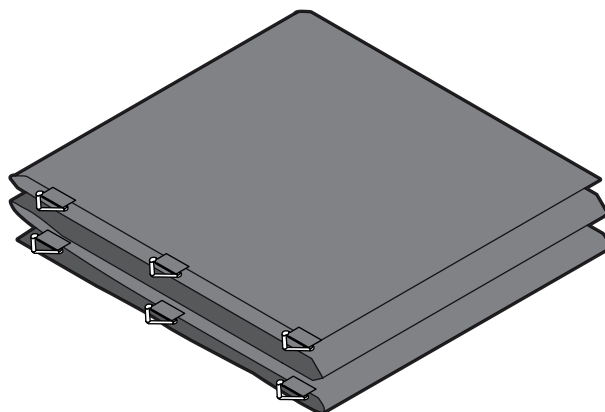

x1
(box 3)

1

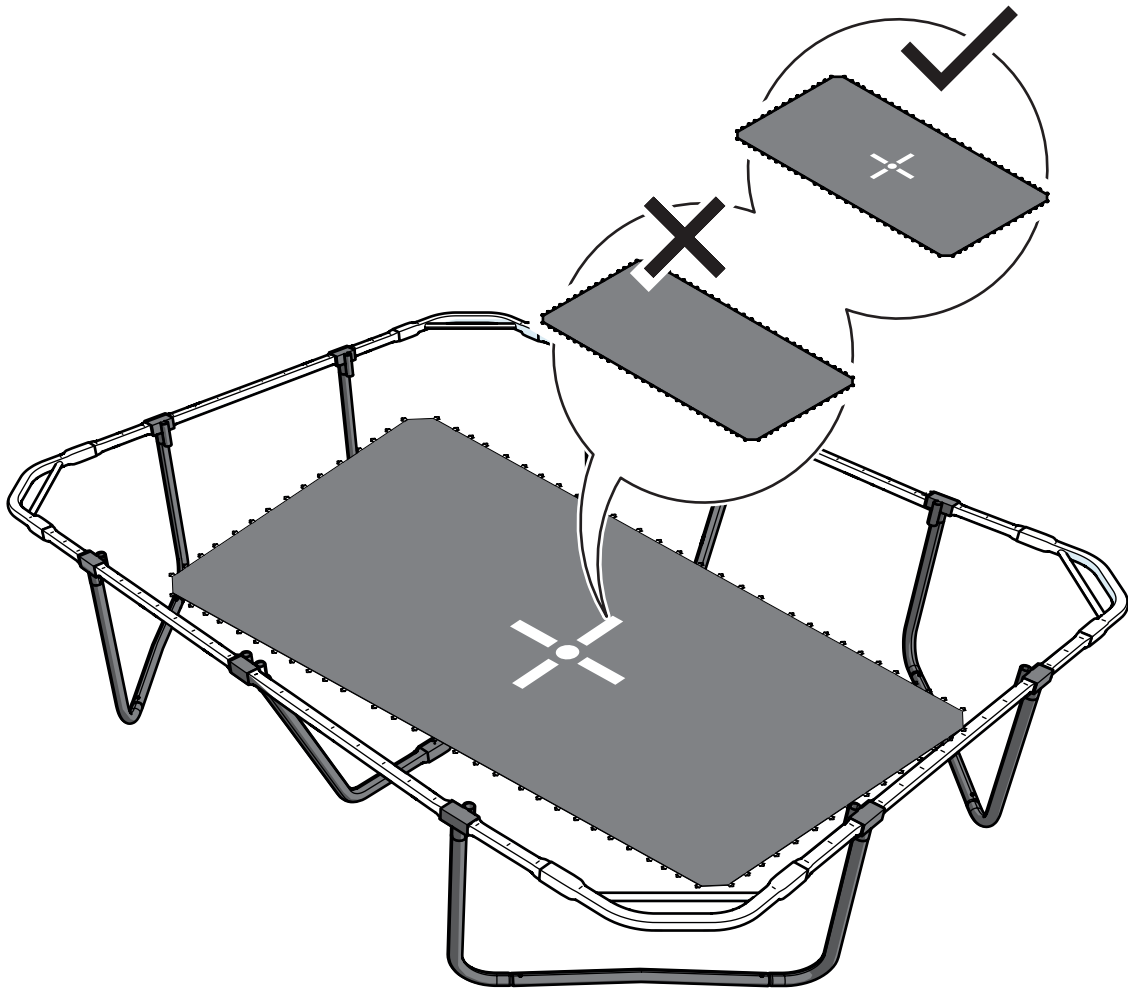

2

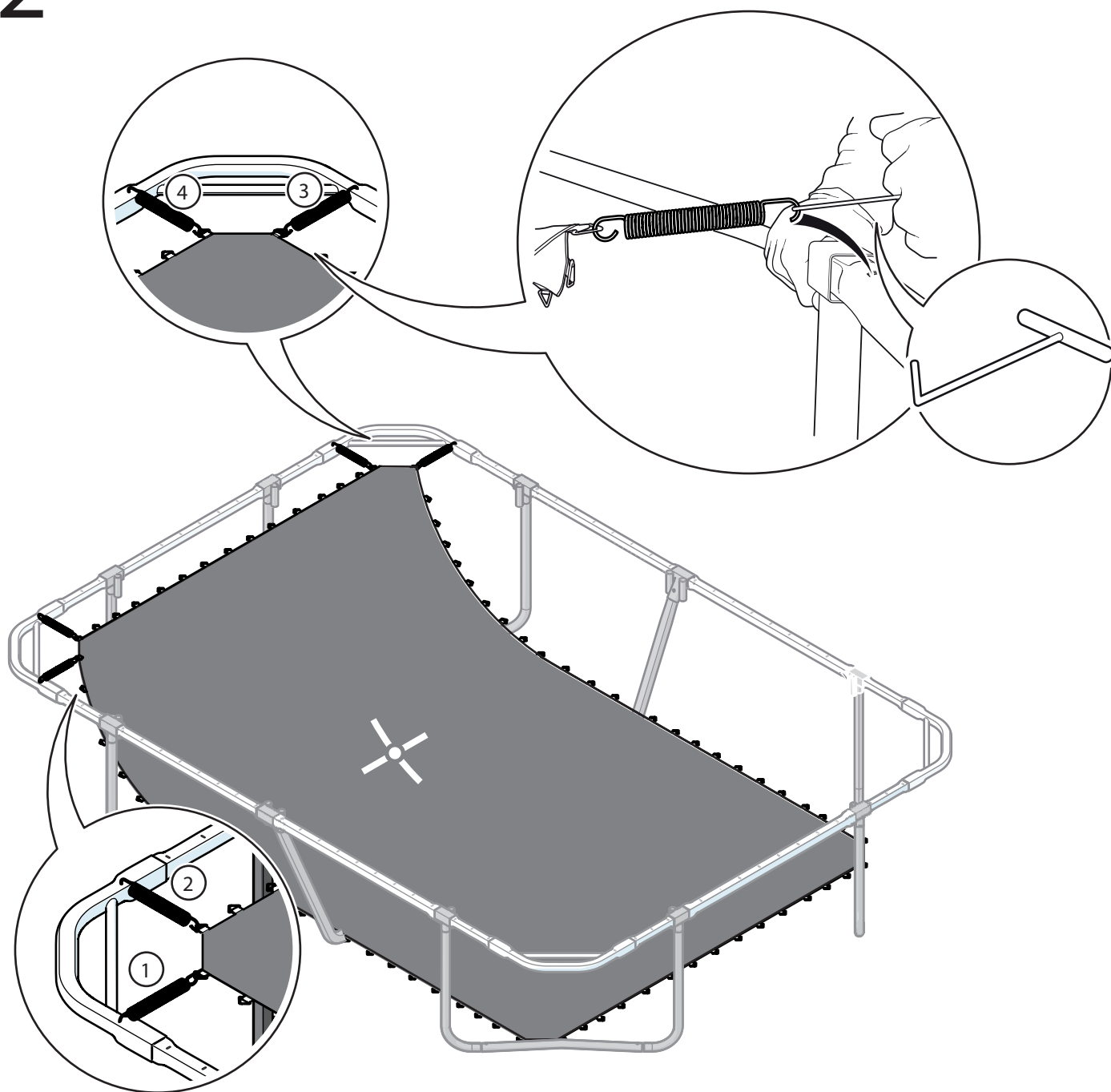

3

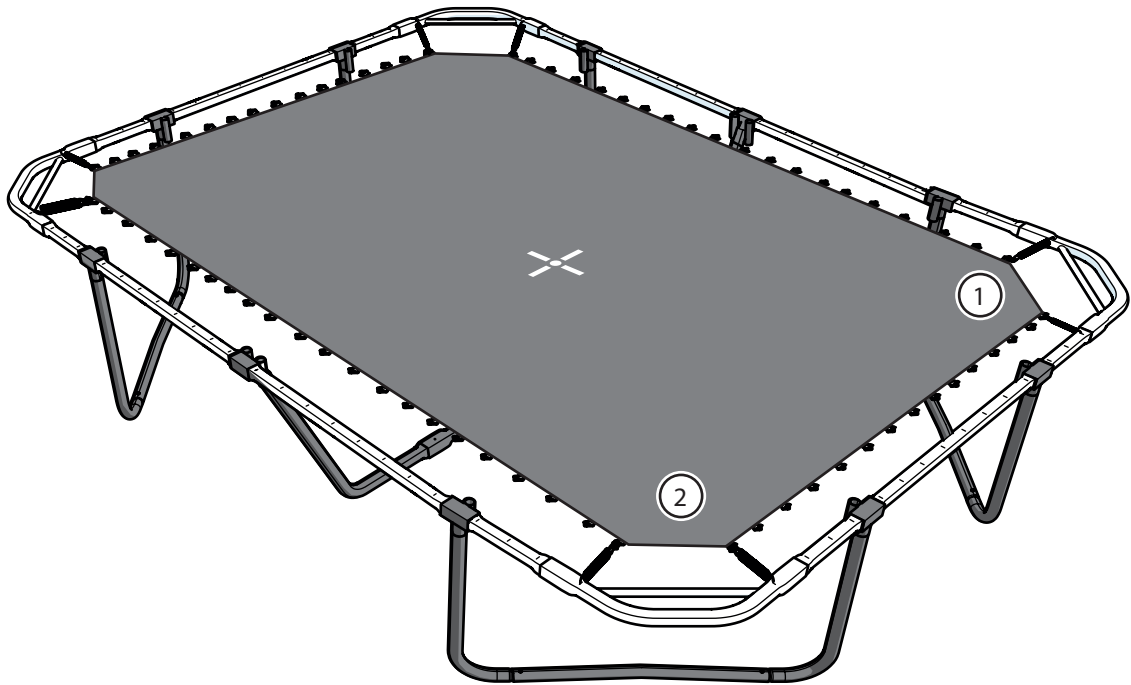

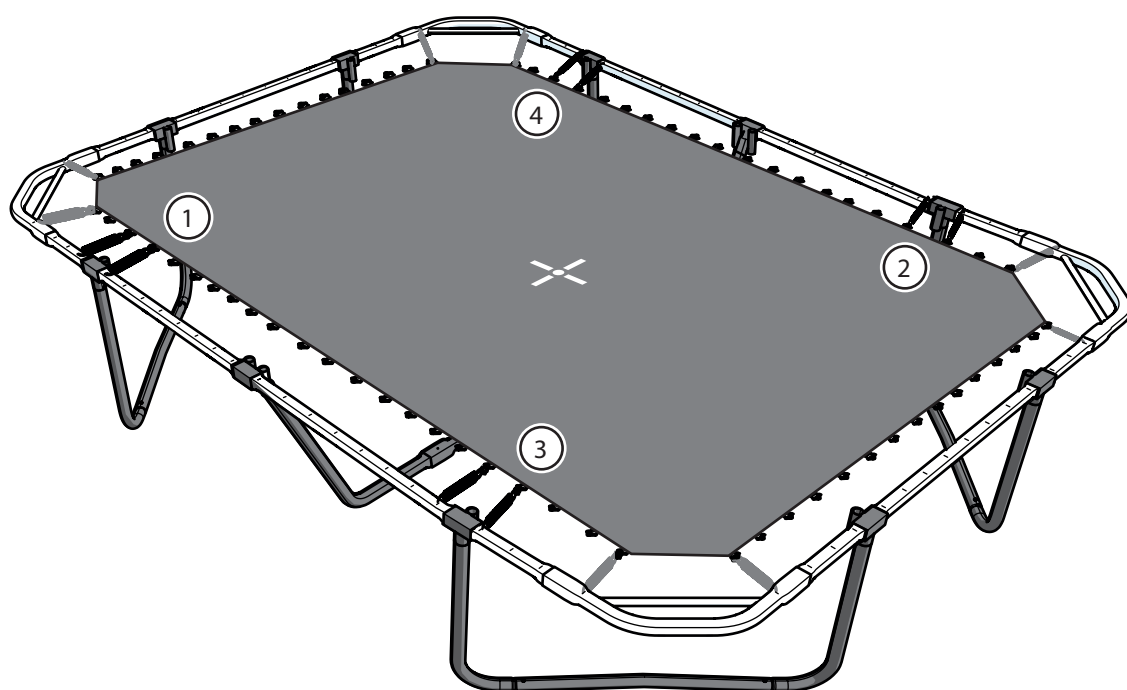

5

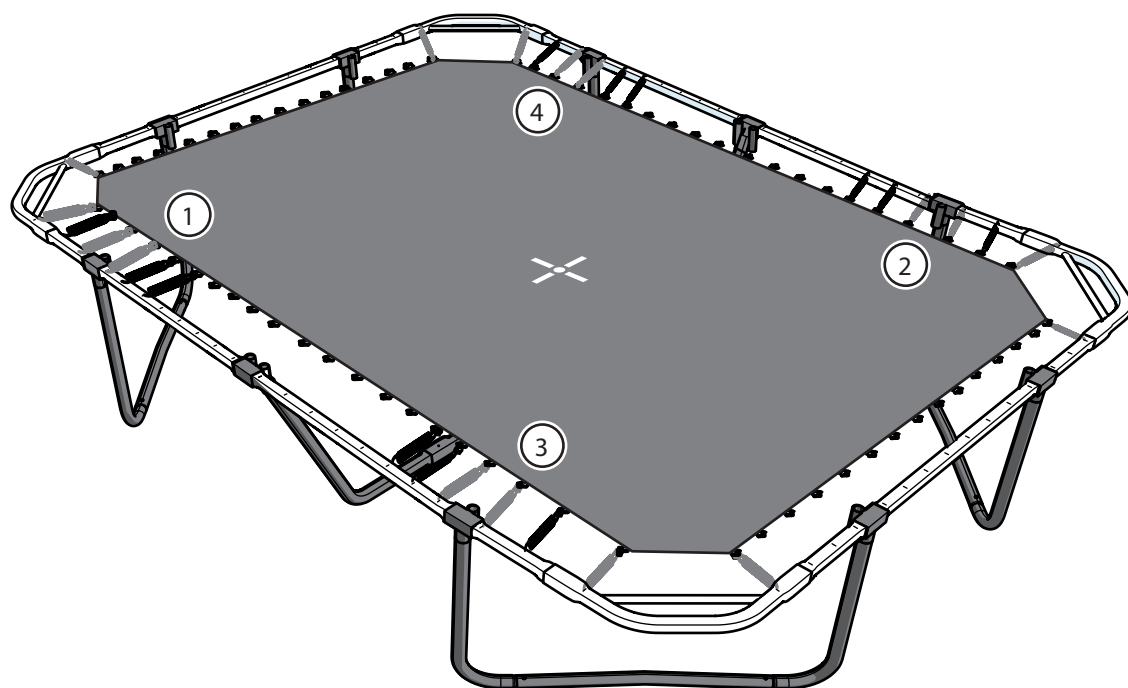

6

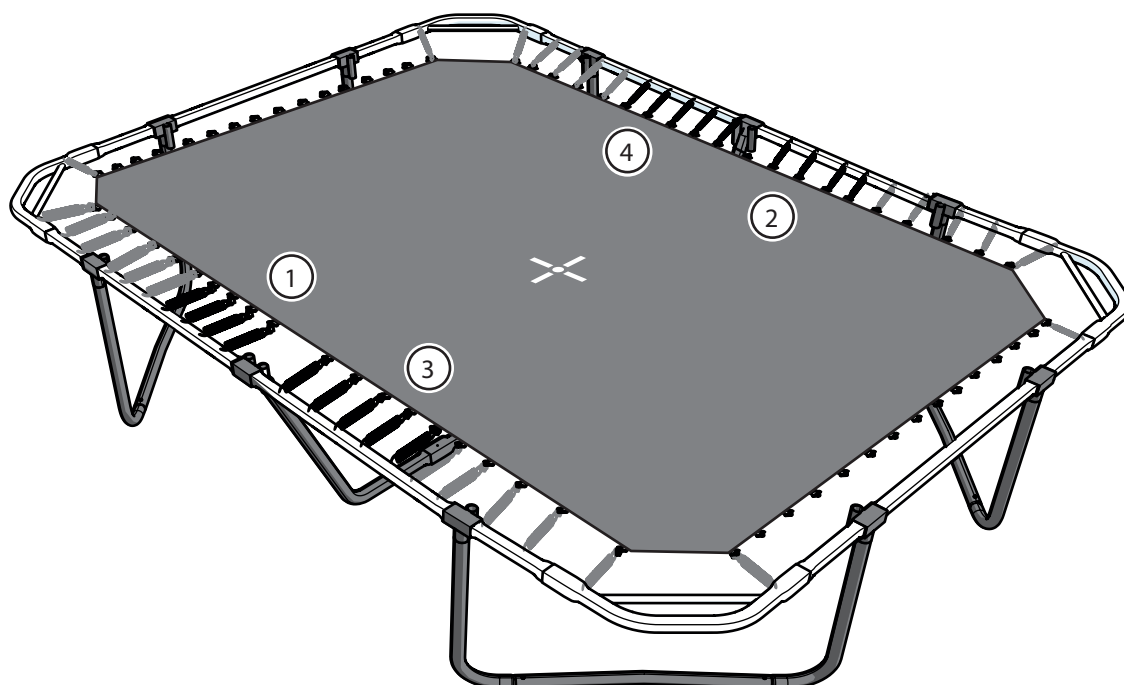

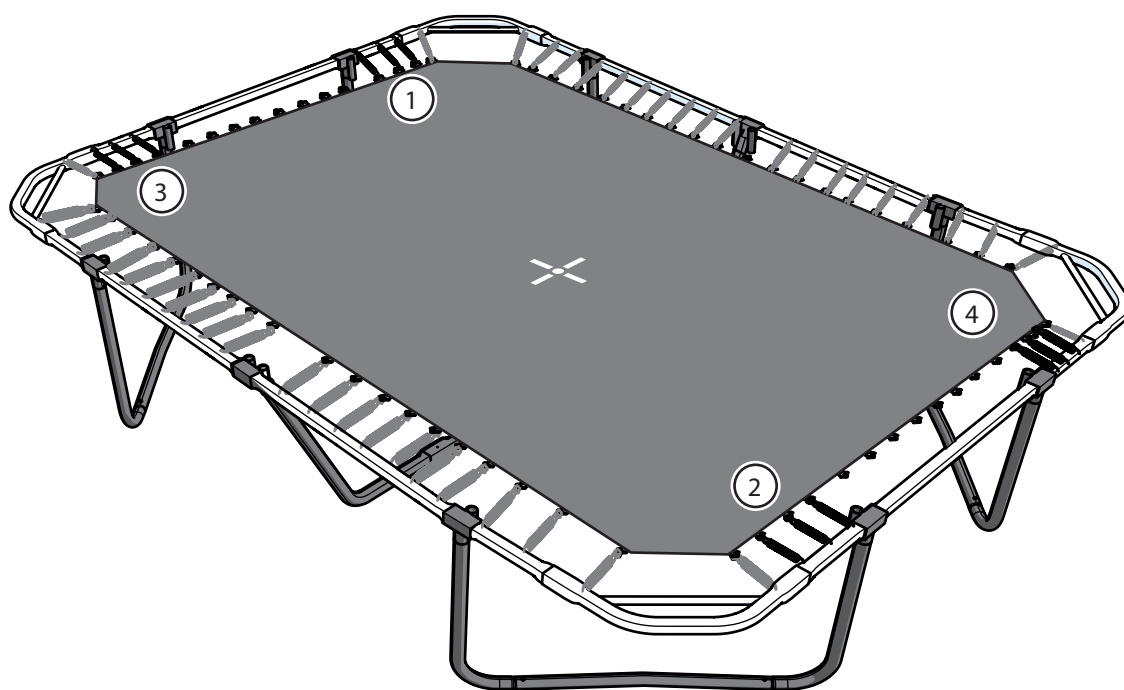

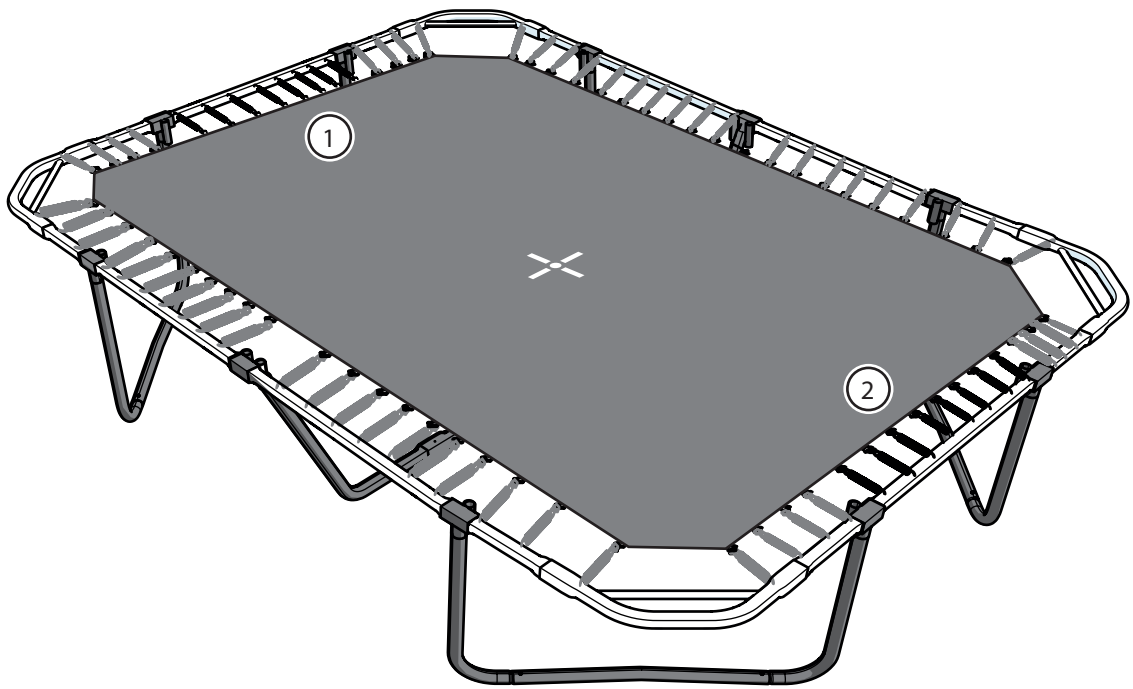

ATTACH THE FRAME PAD

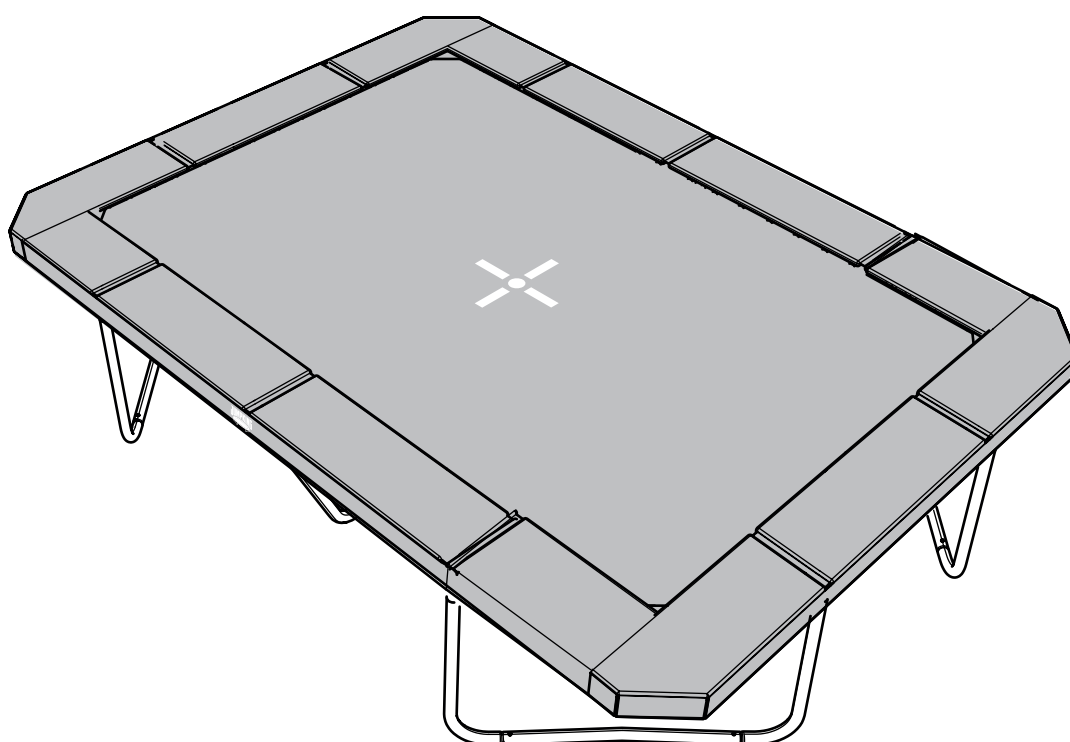

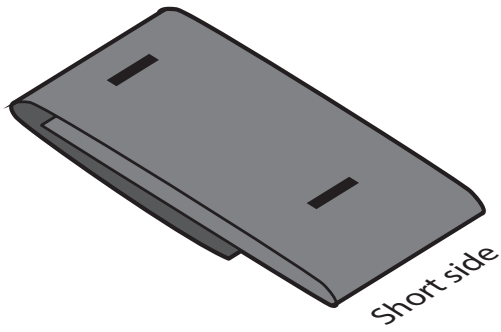
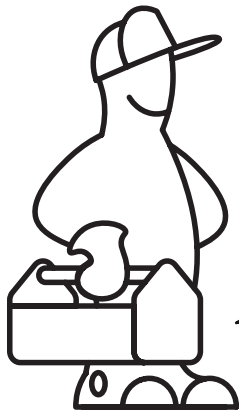

x2
(box 1)

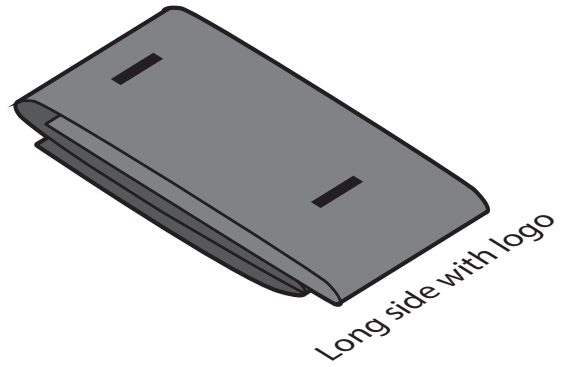

x2
(box 3)

1

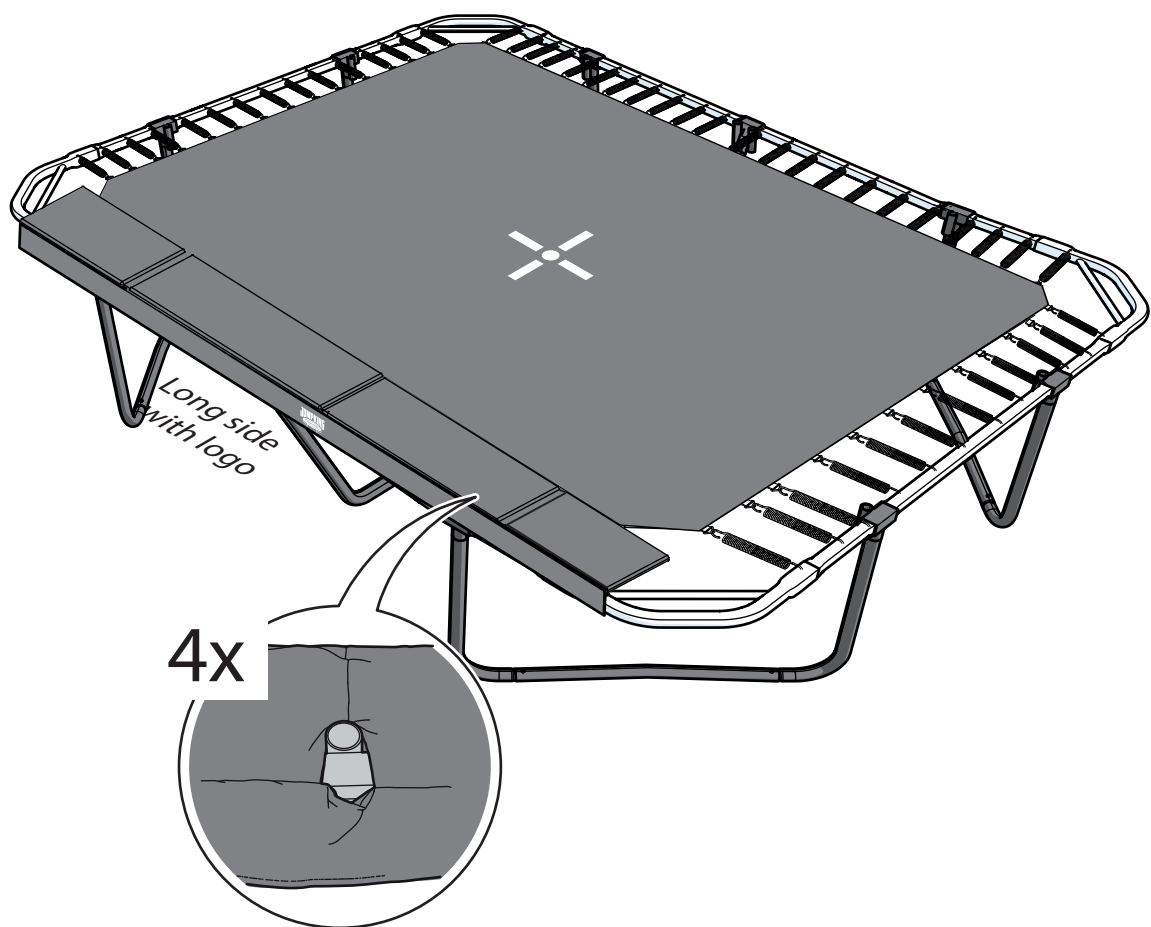

2

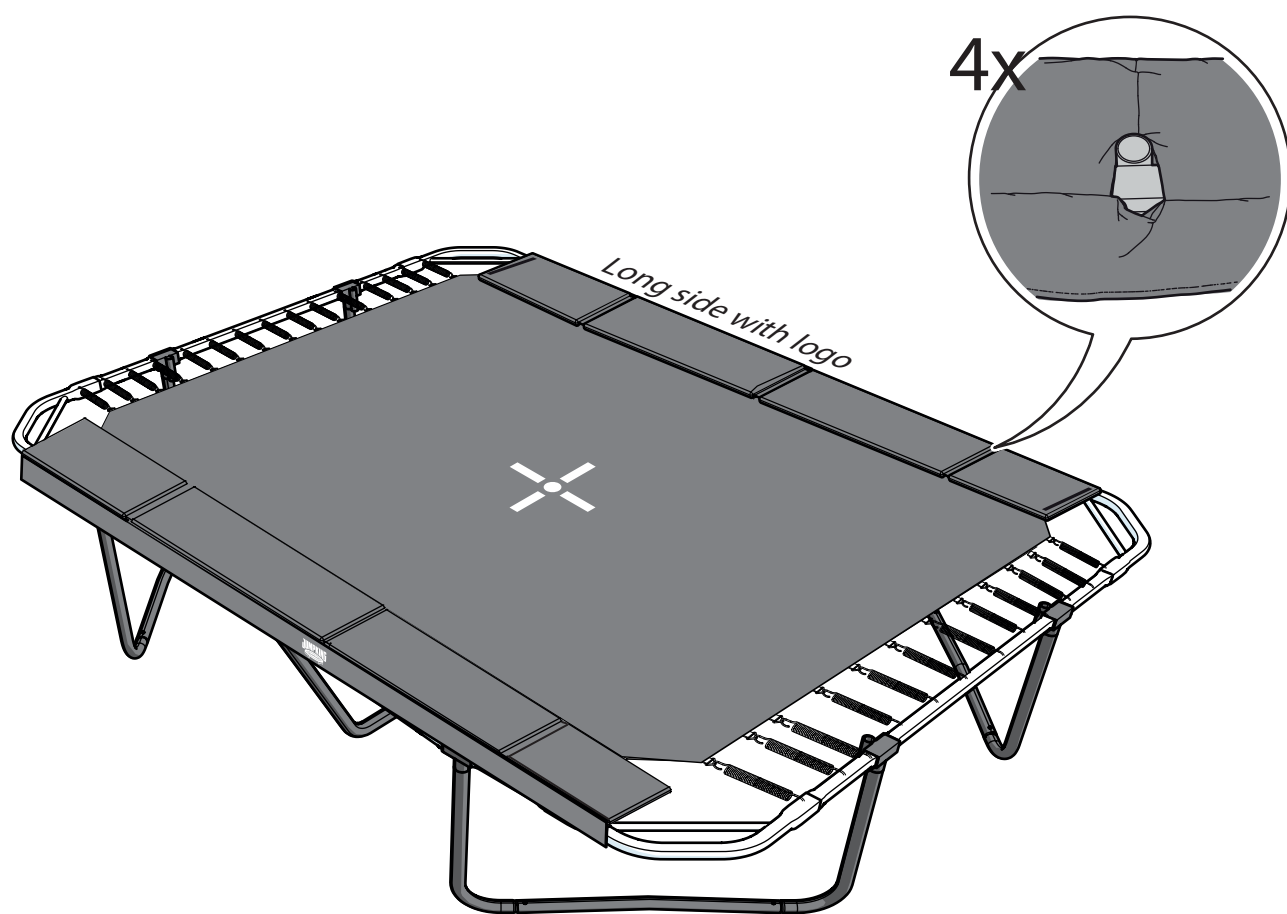

3

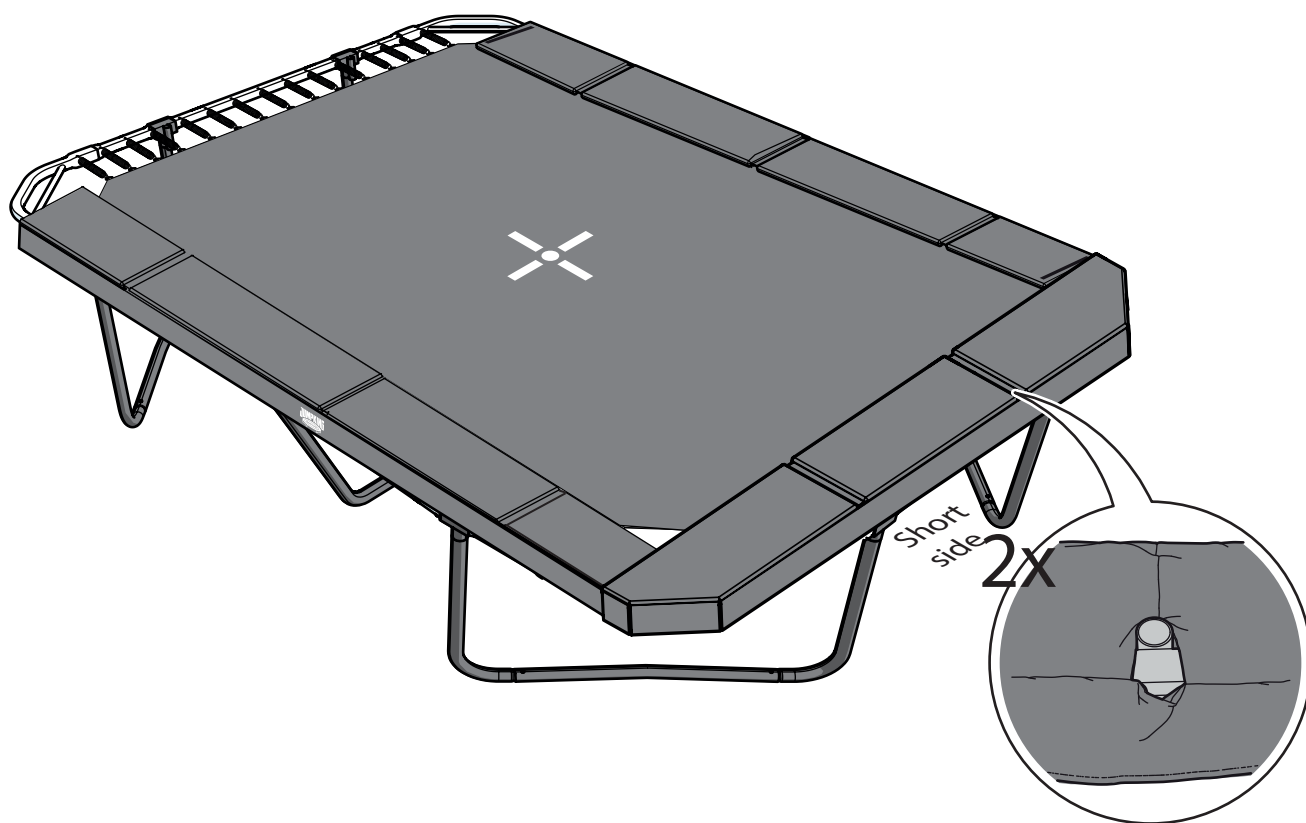

4

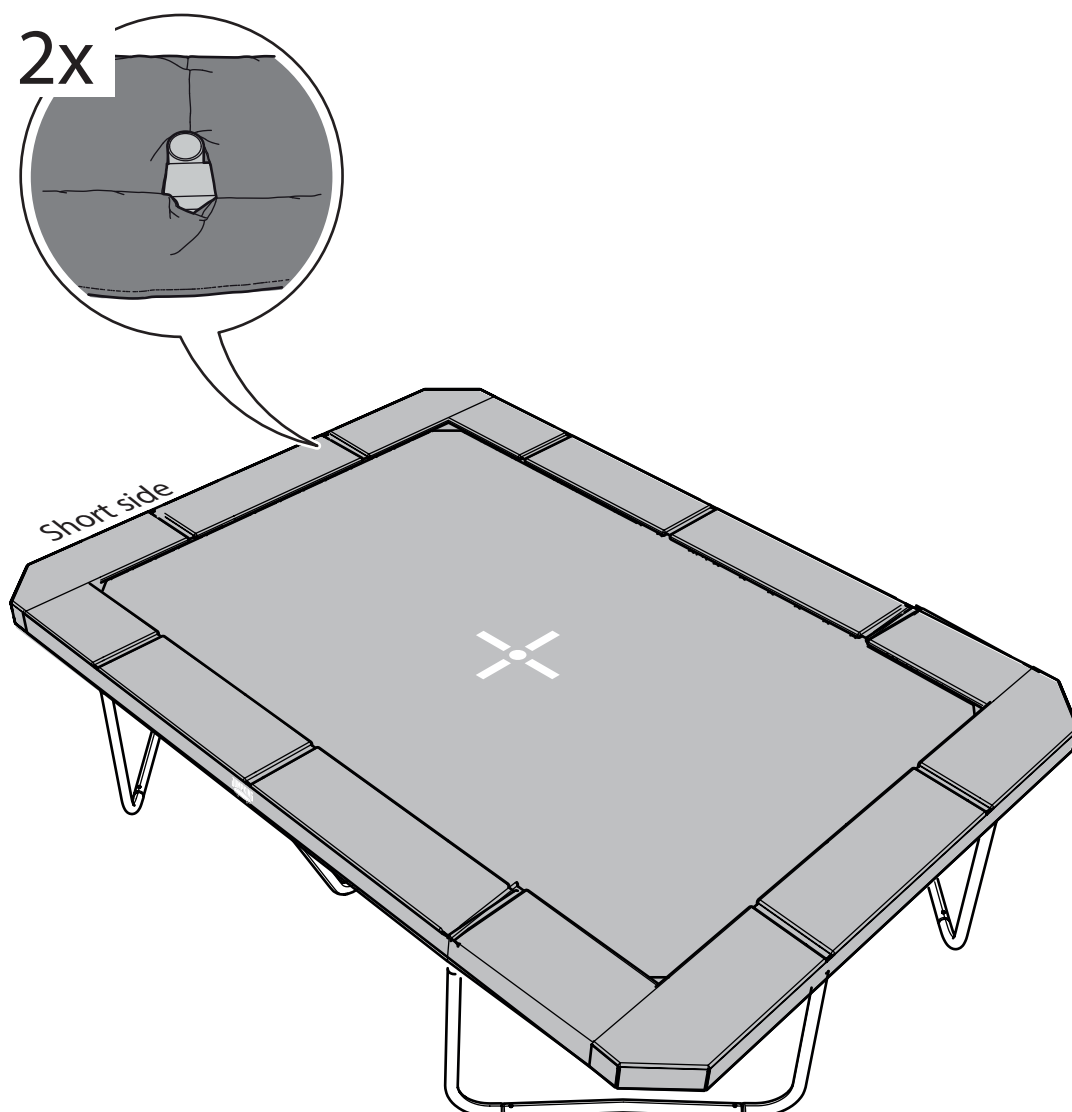

5

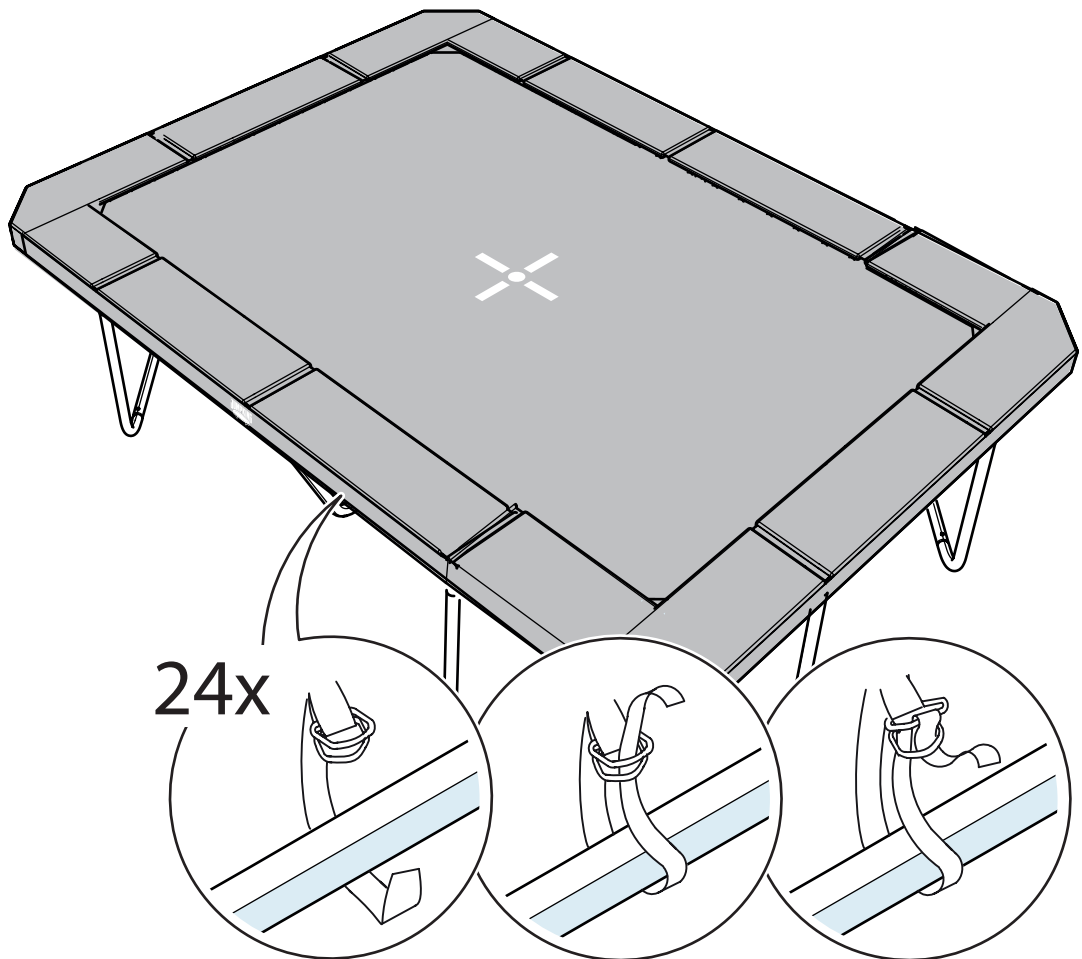

INSTALL THE ENCLOSURE NET POLES

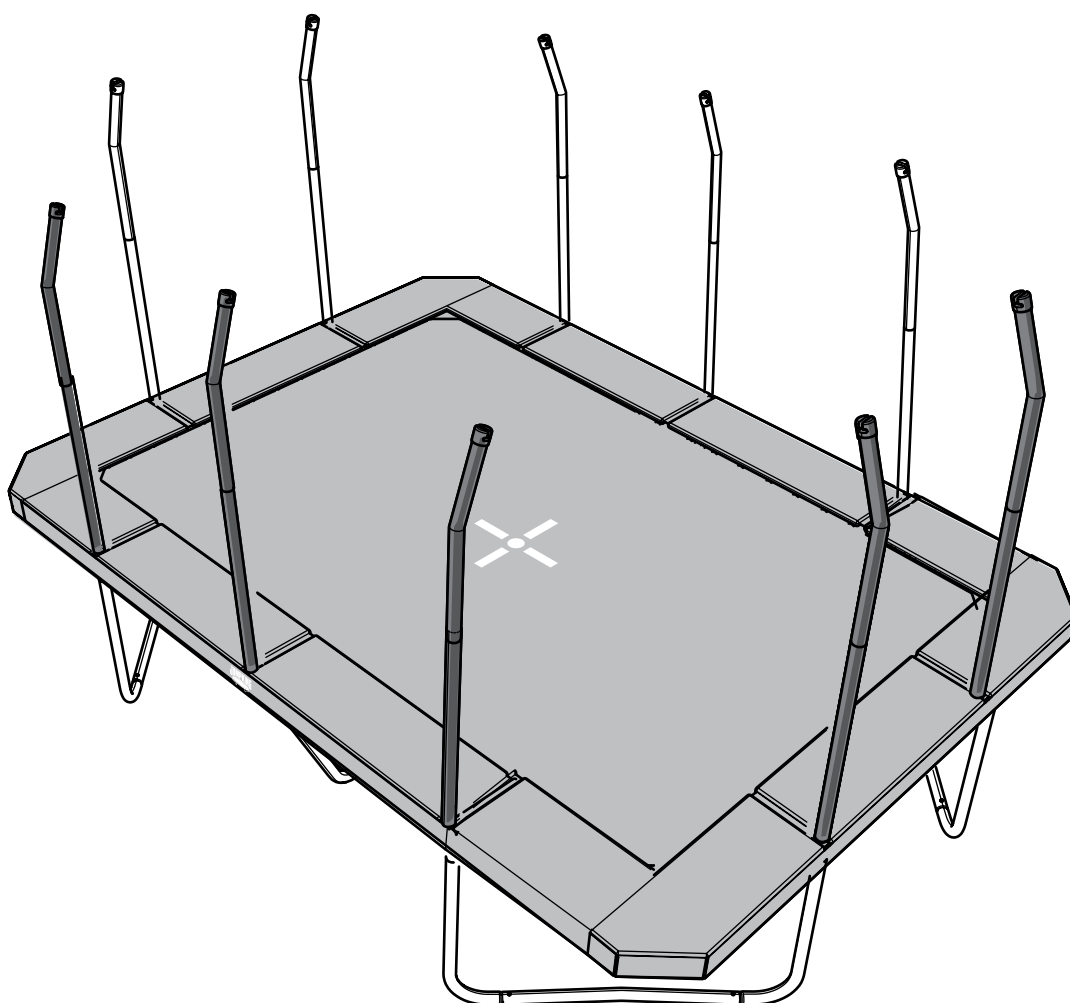

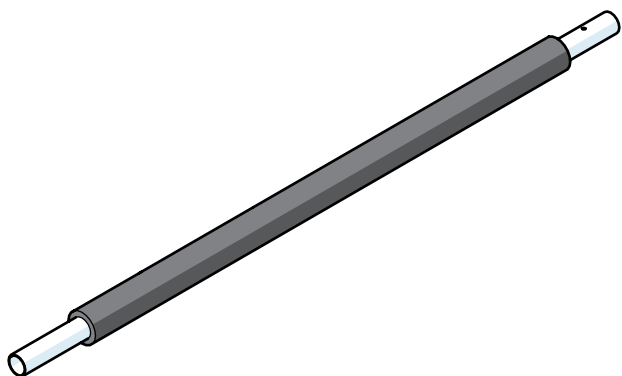
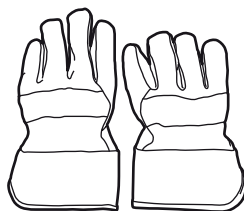
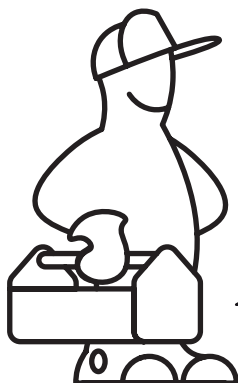

x10
(box 2 and 3)

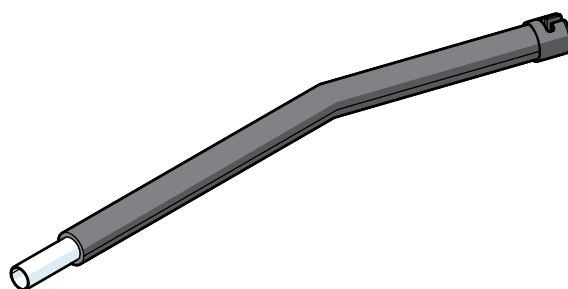

x10
(box 2 and 3)



x10
(box 1)

1

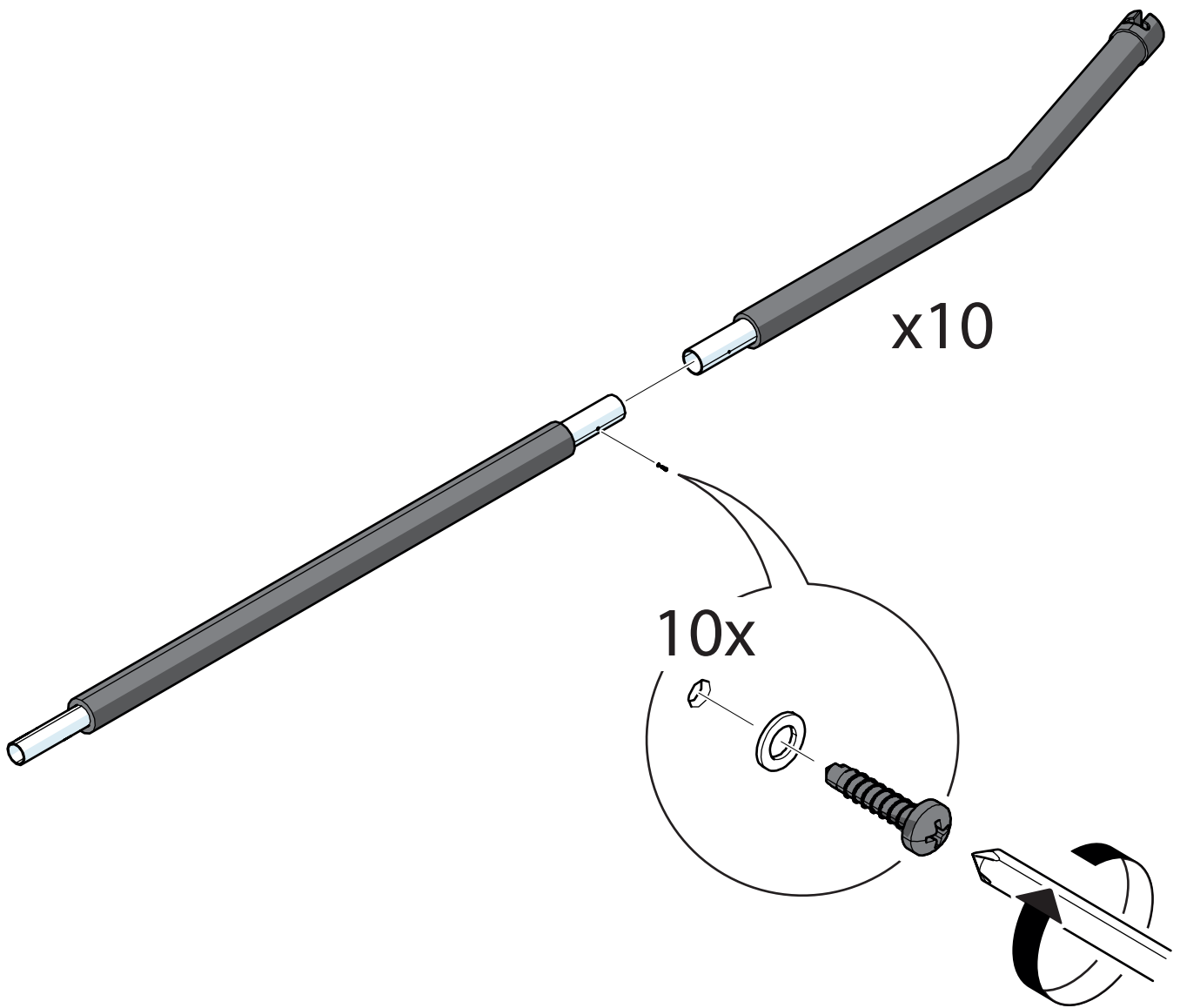

2

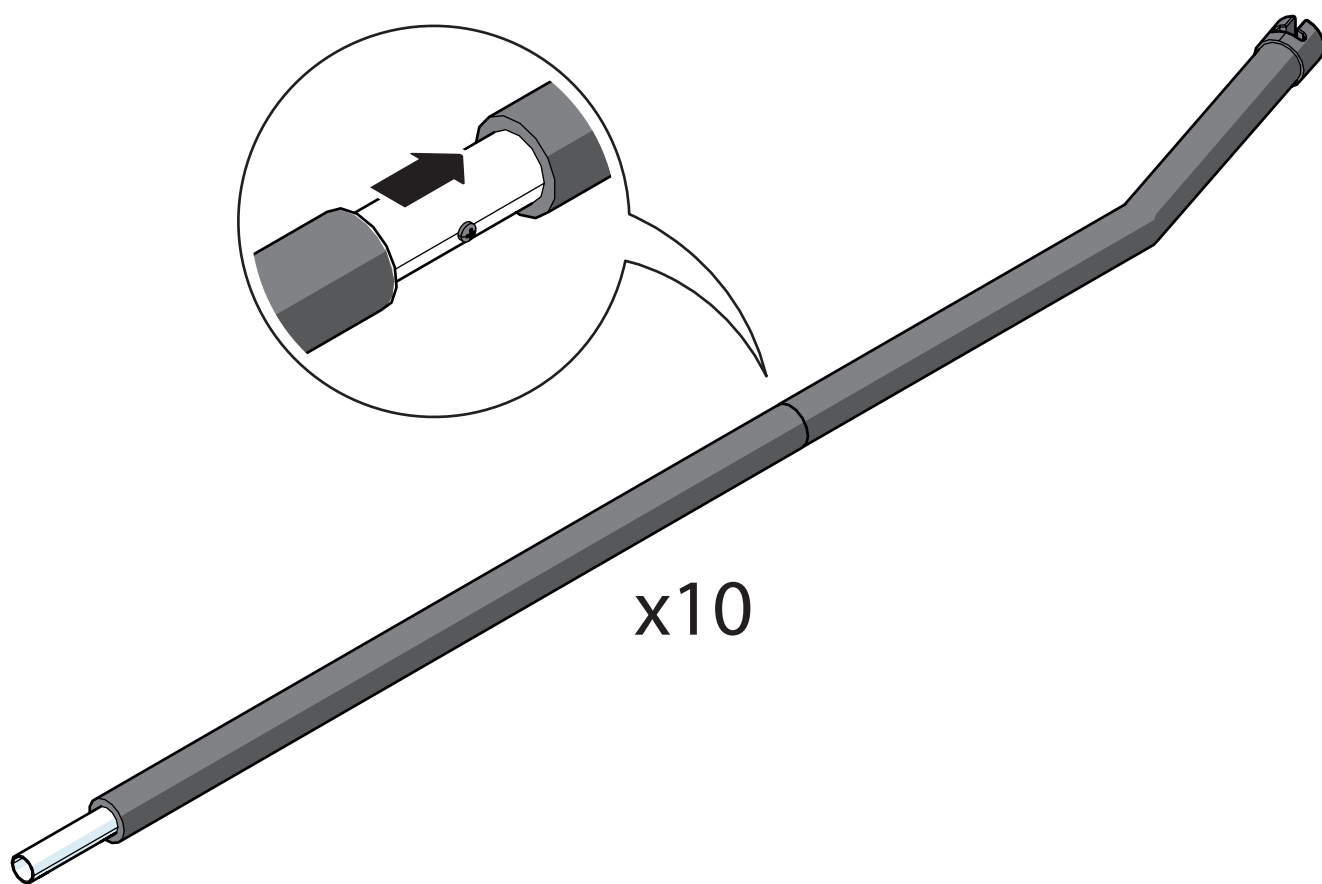

3

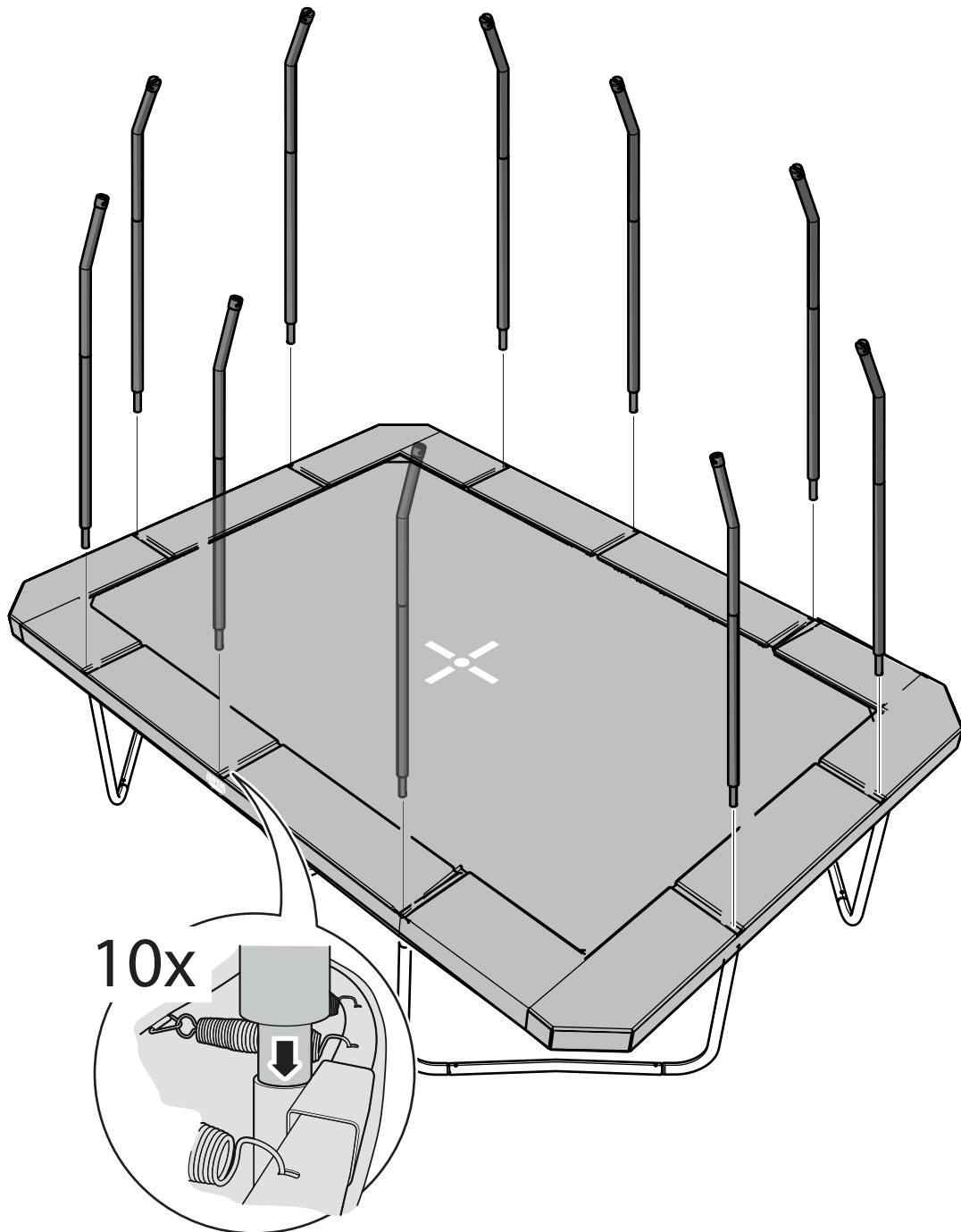

ATTACH THE TOP OF THE ENCLOSURE NET

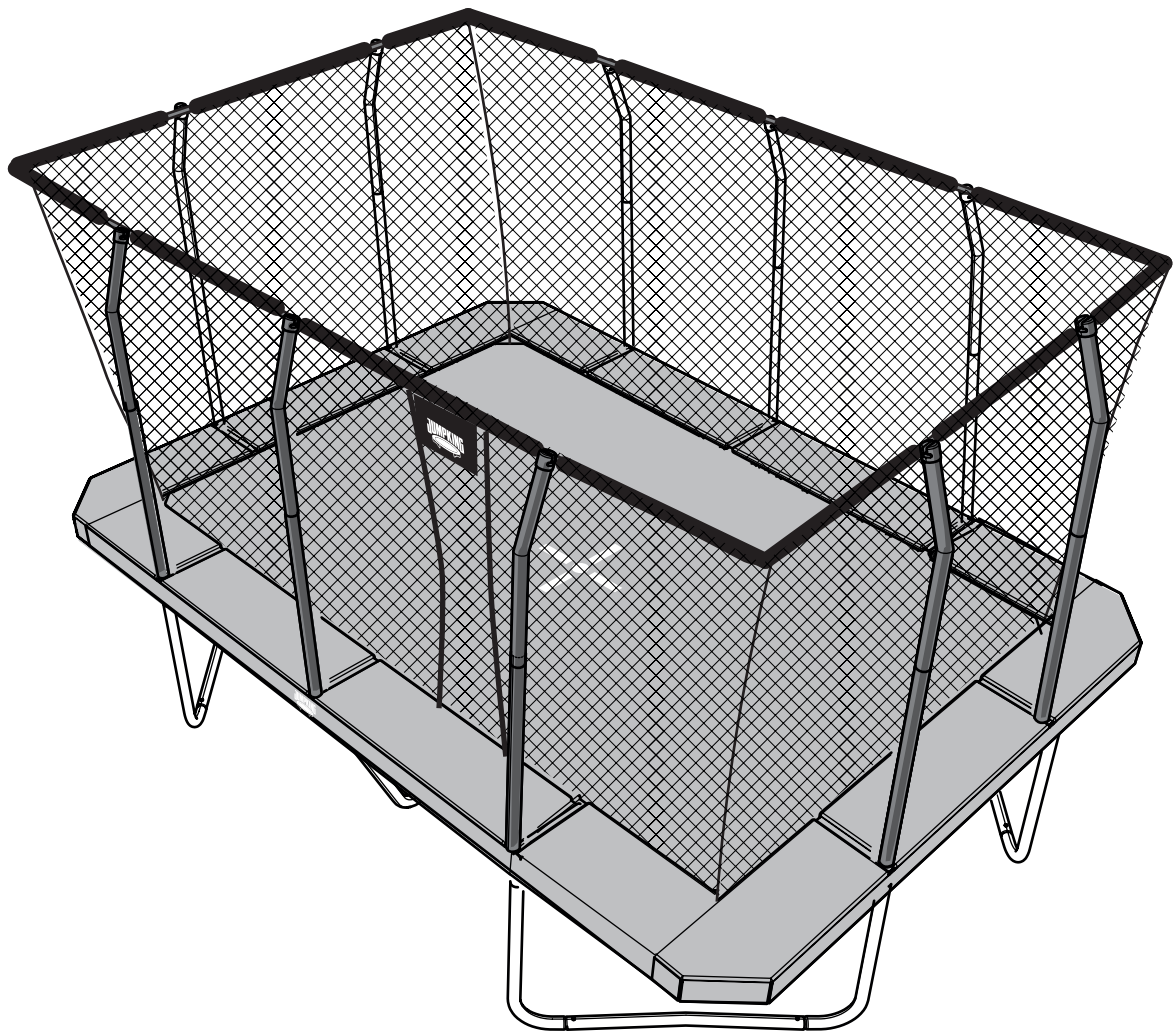

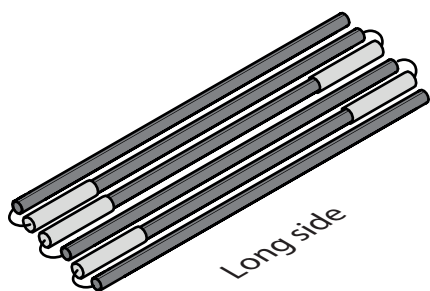
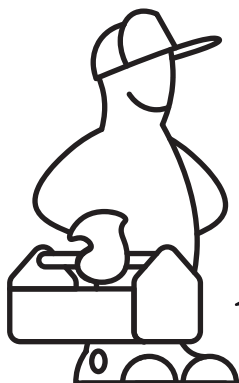

x2
(box 3)

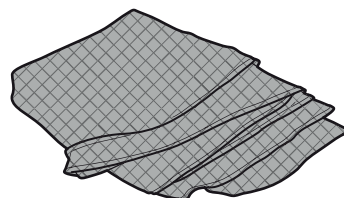

x1
(box 3)

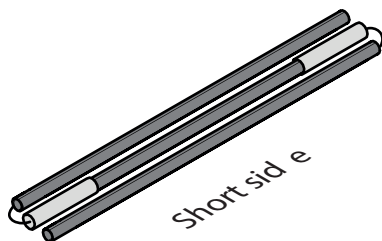

x2
(box 3)



x4
(box 3)

1

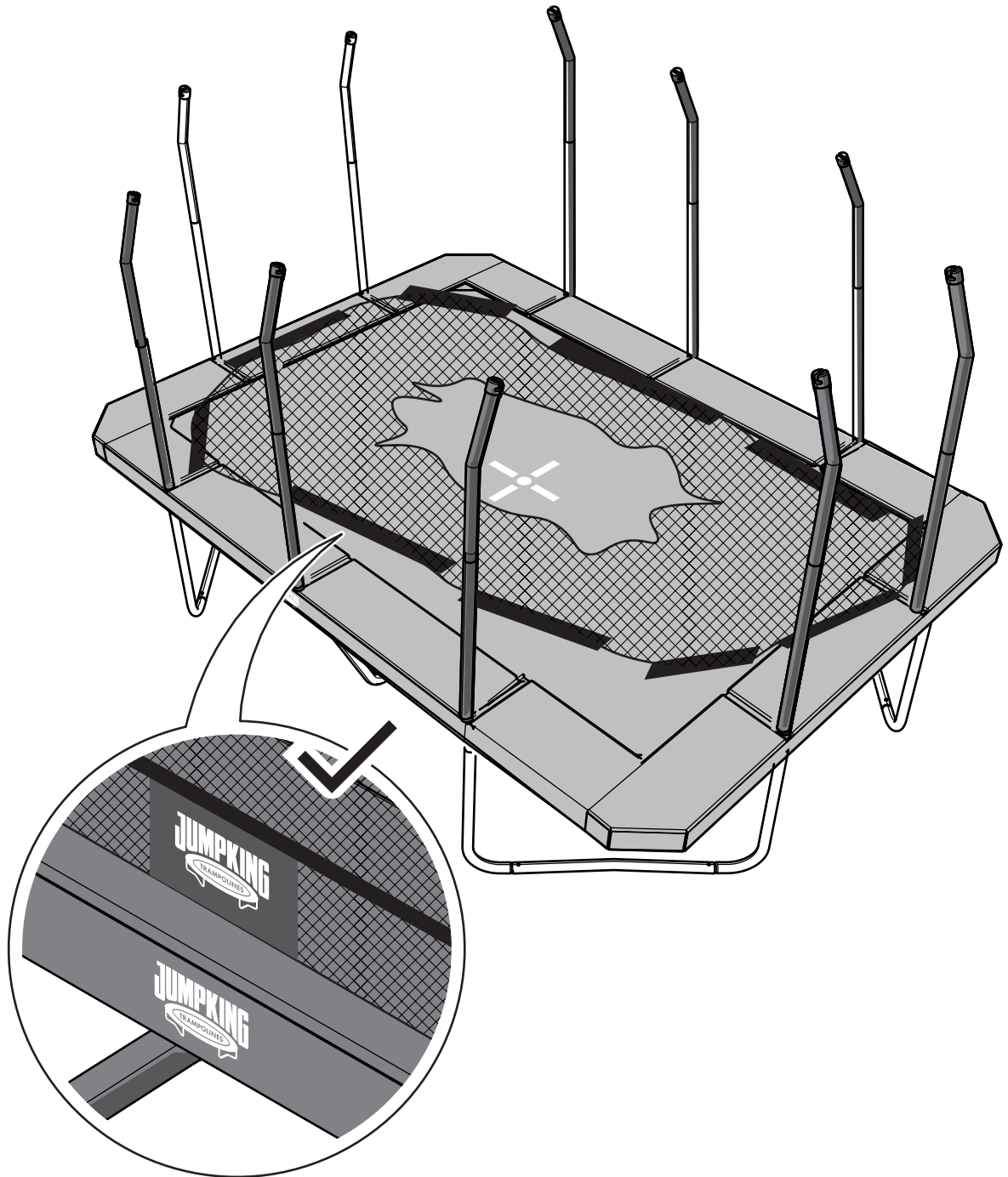

2

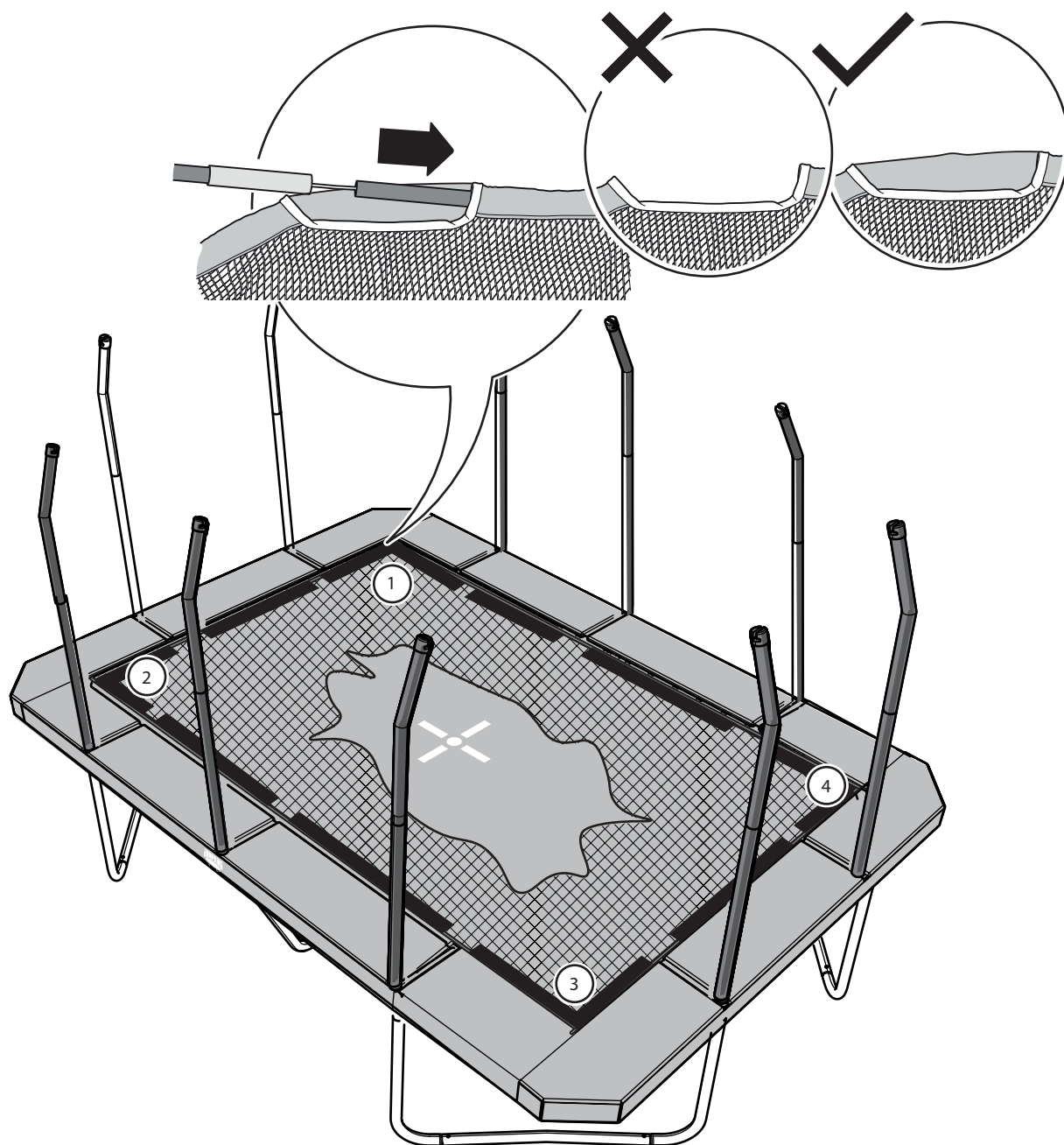

3

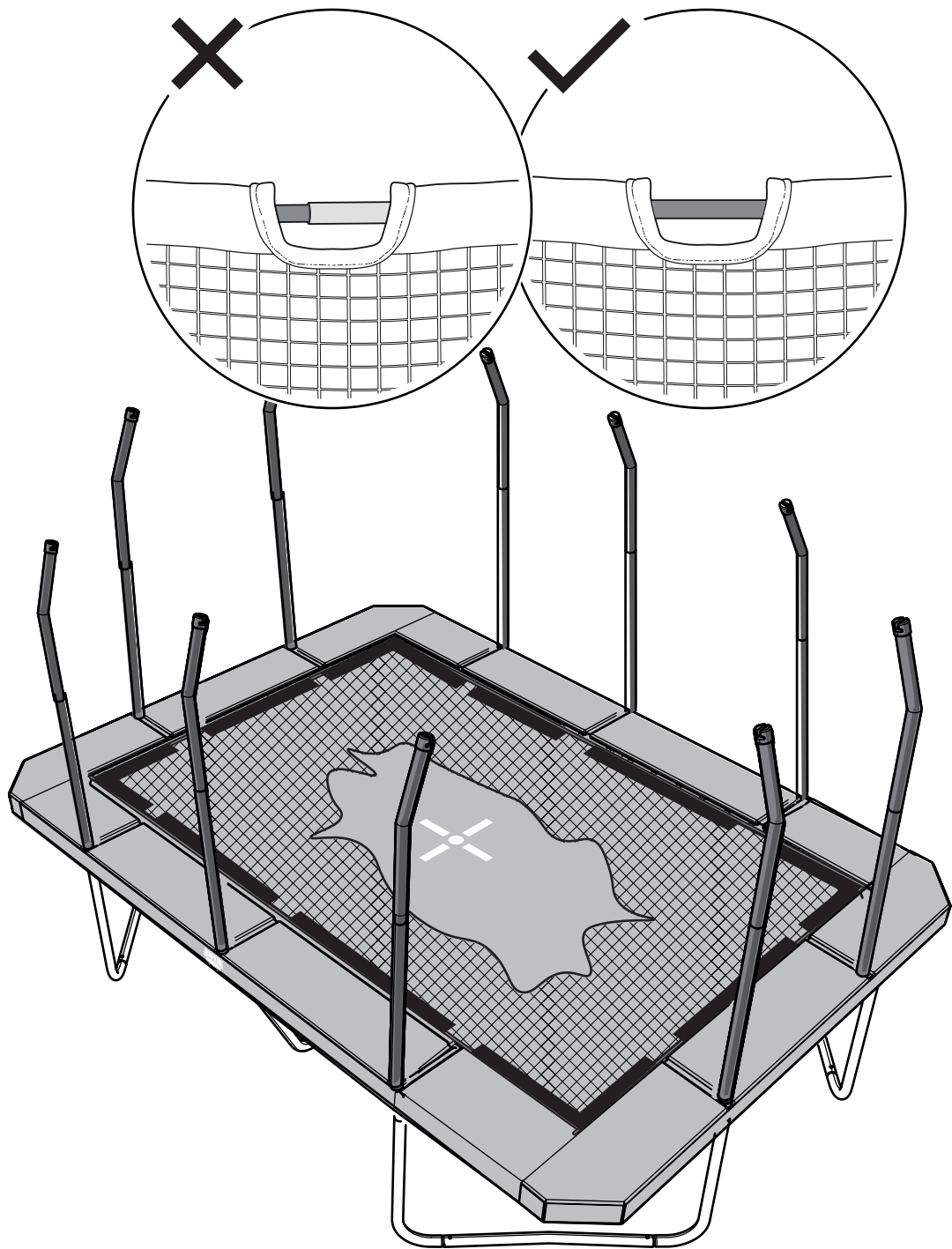

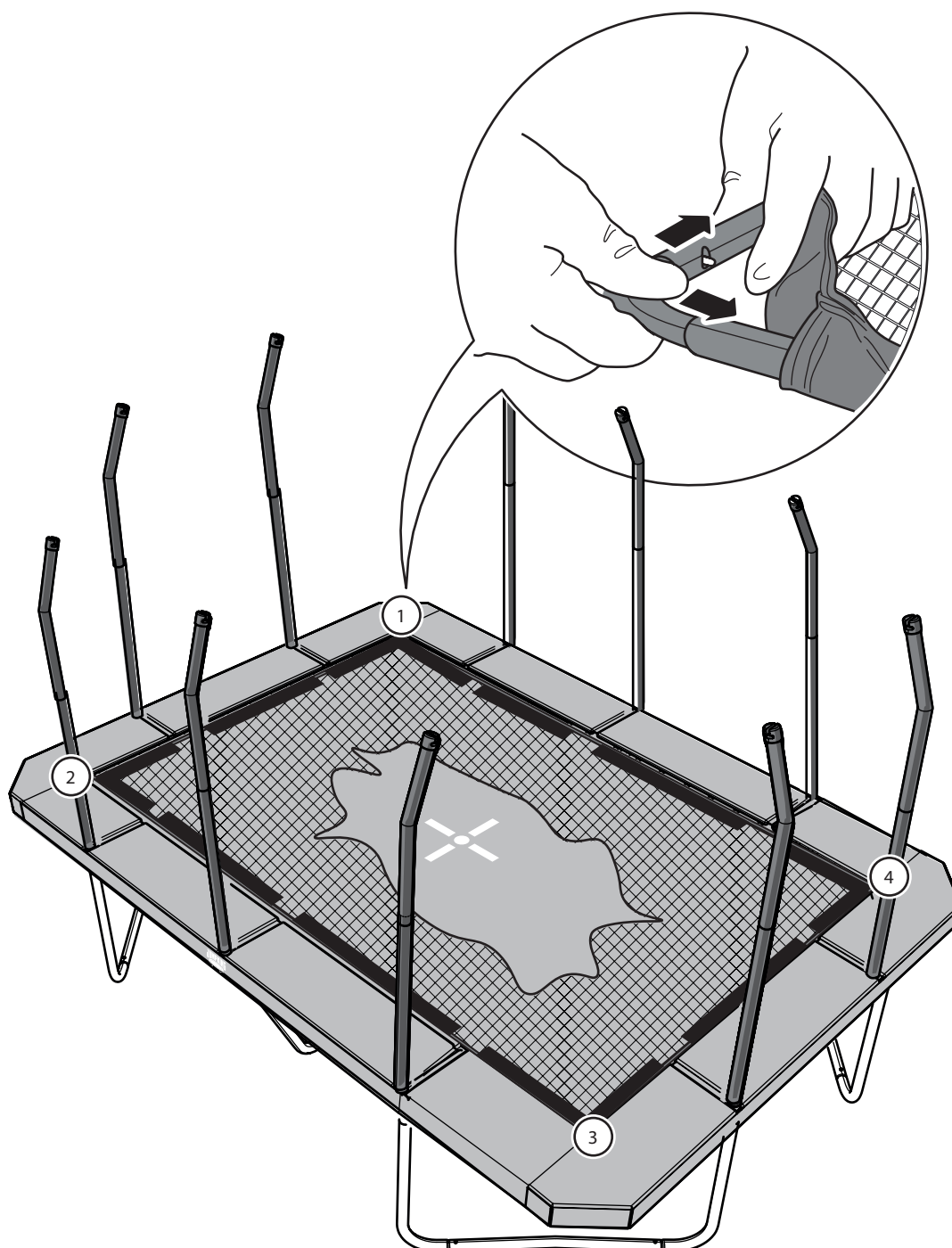

5

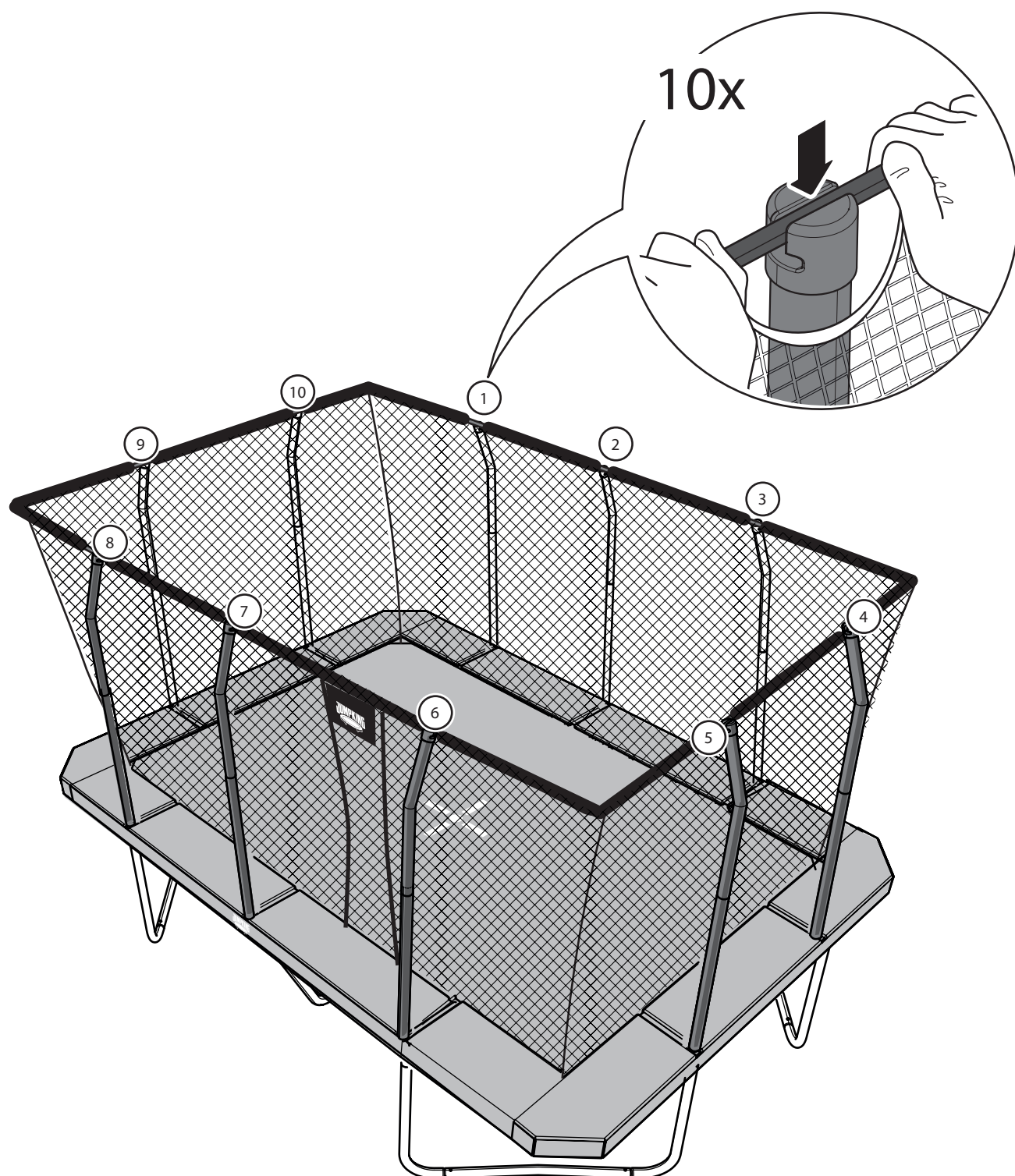

ATTACH THE BOTTOM OF THE ENCLOSURE NET

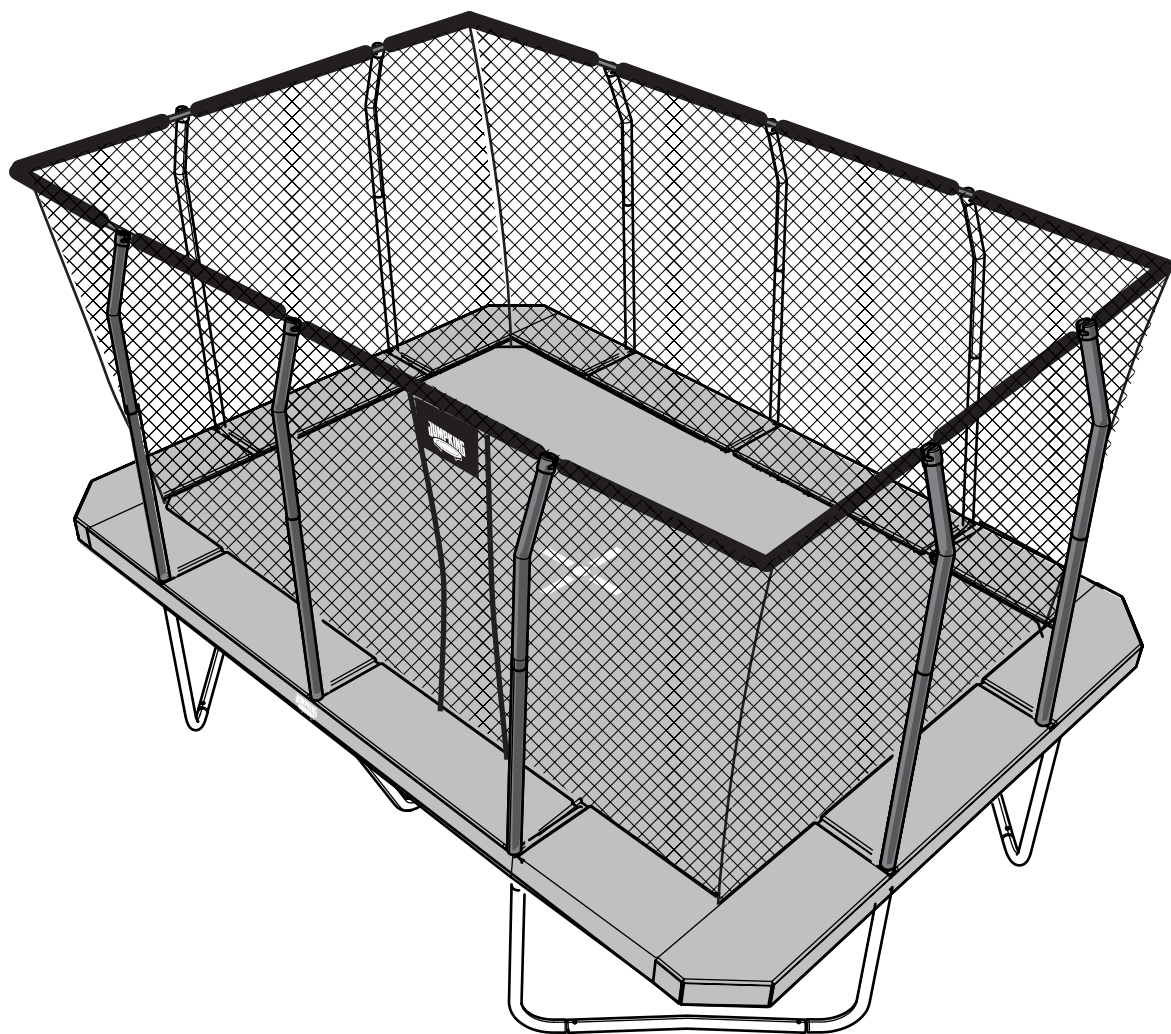

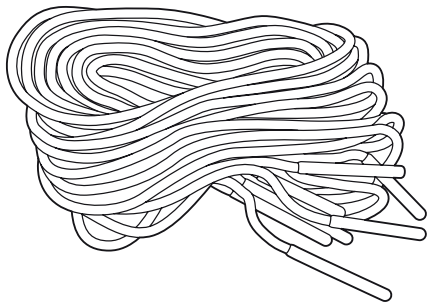

x8
(box 1)

1

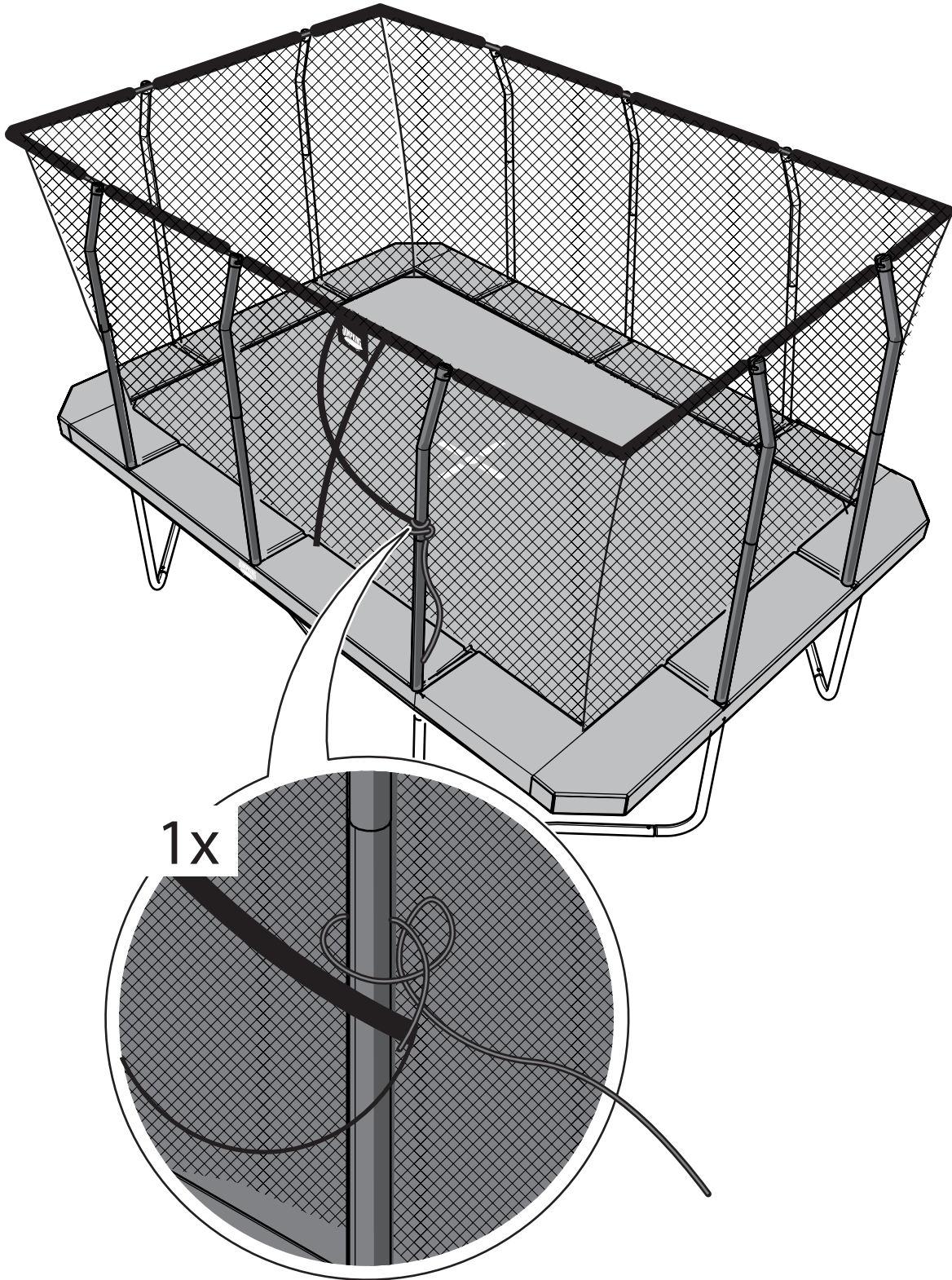

2

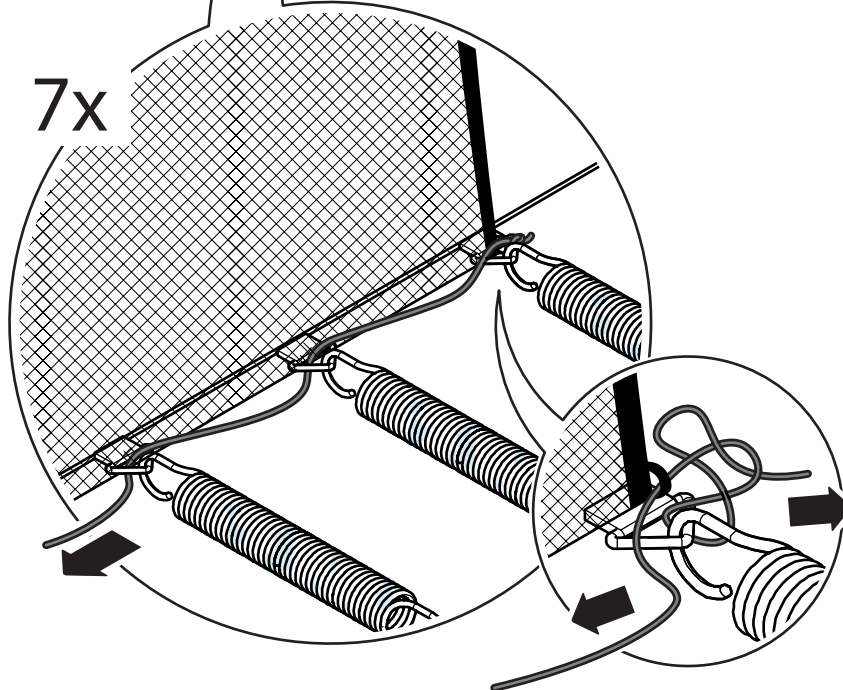
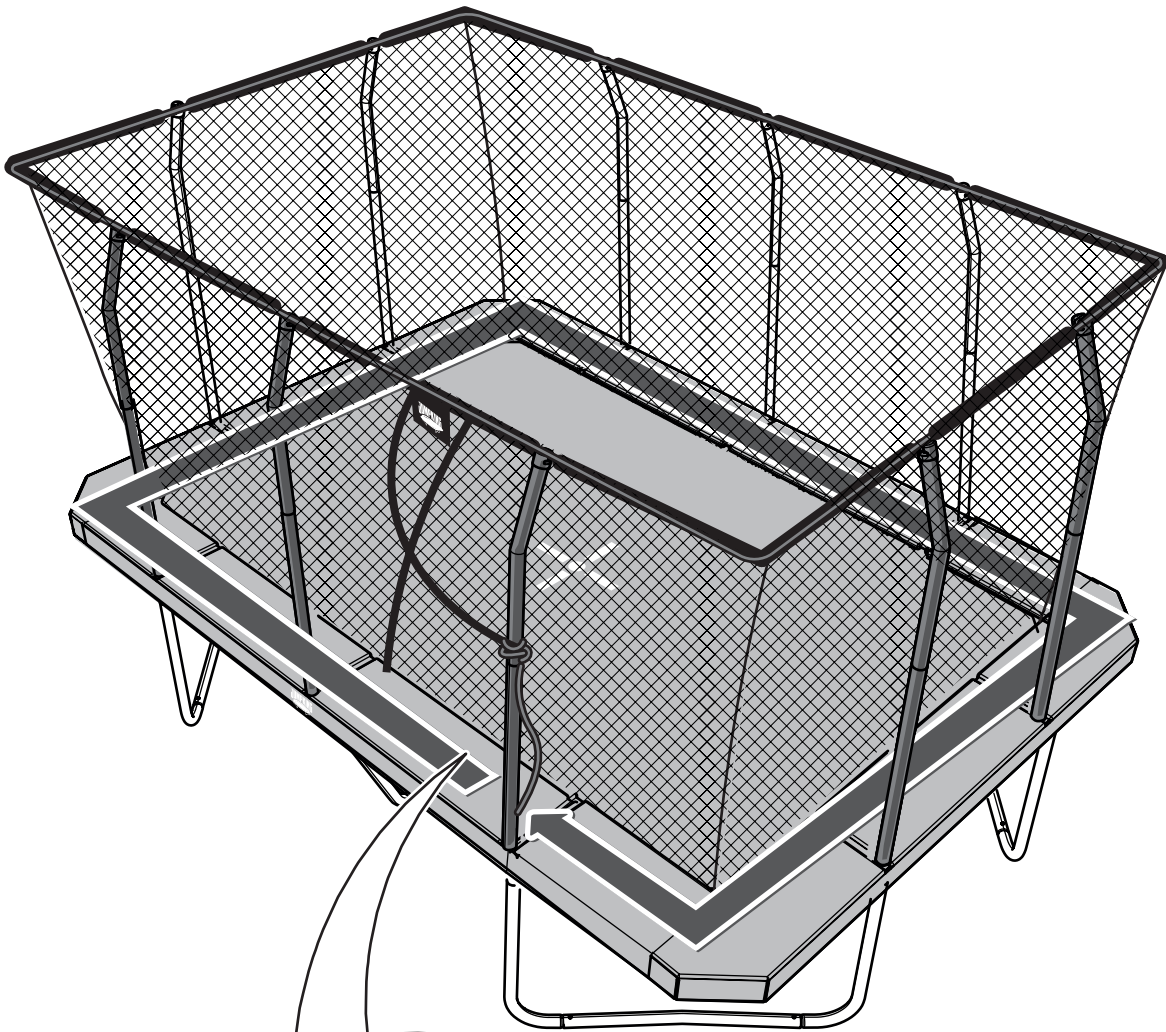

3

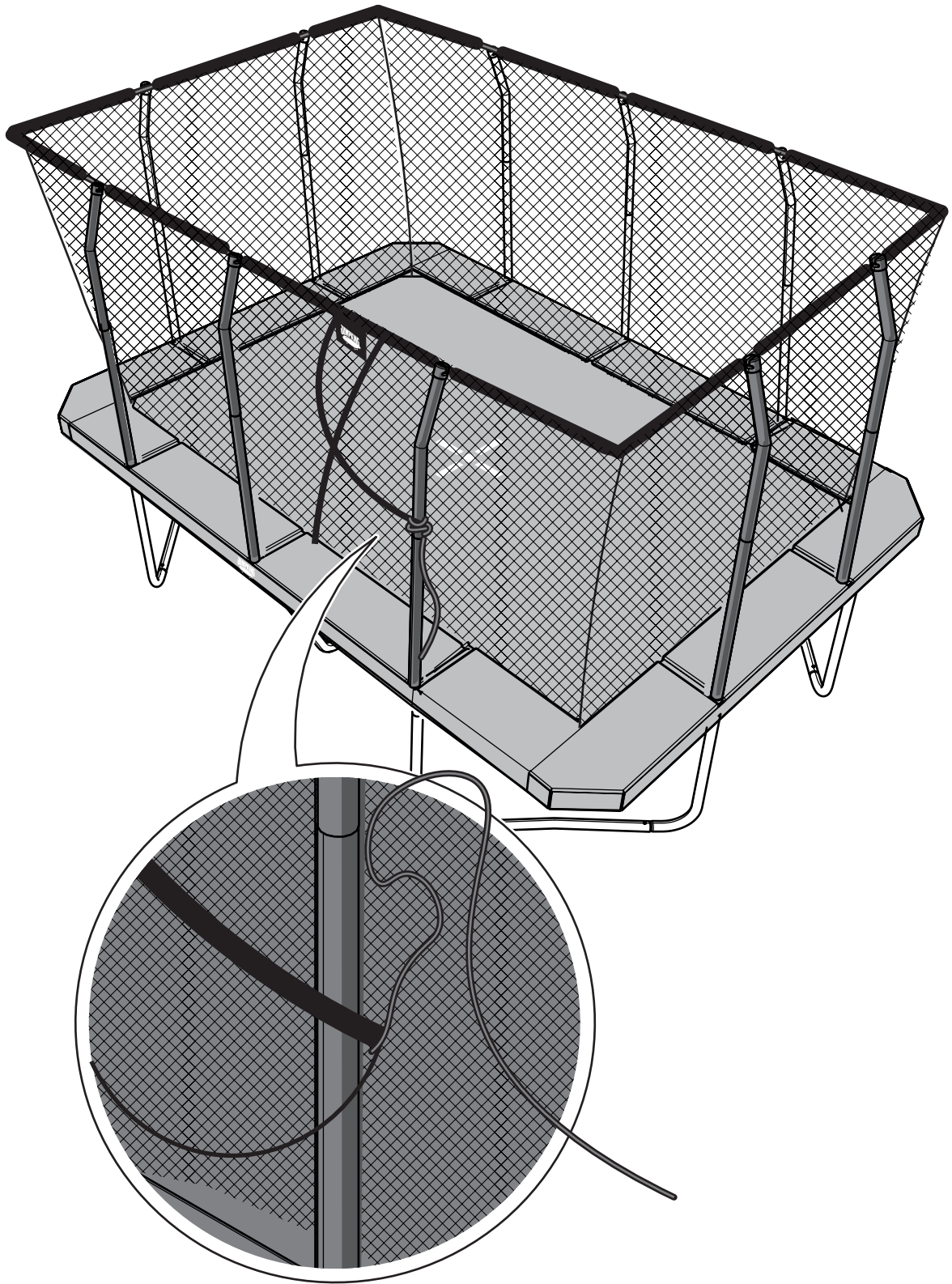

4

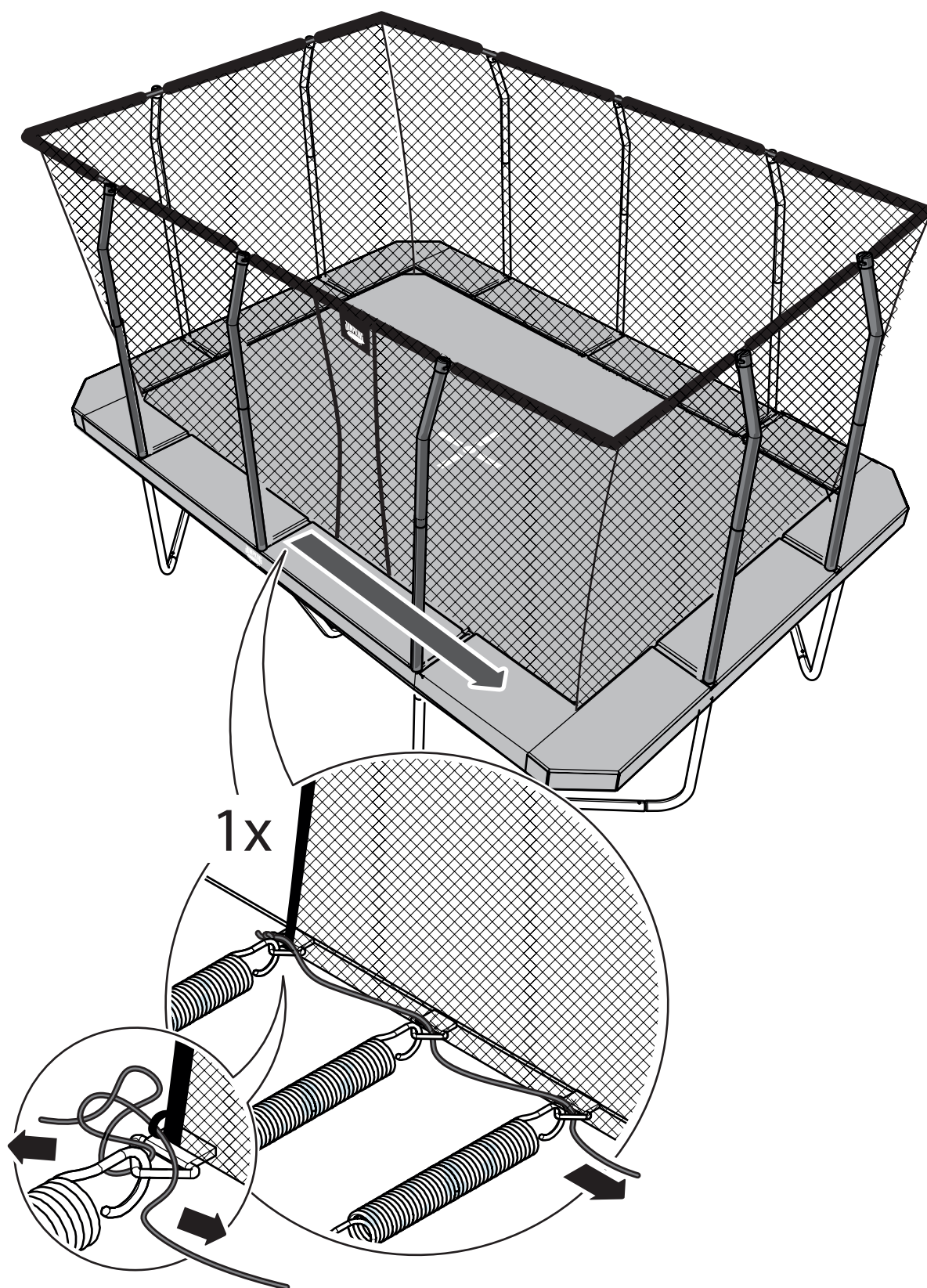

5

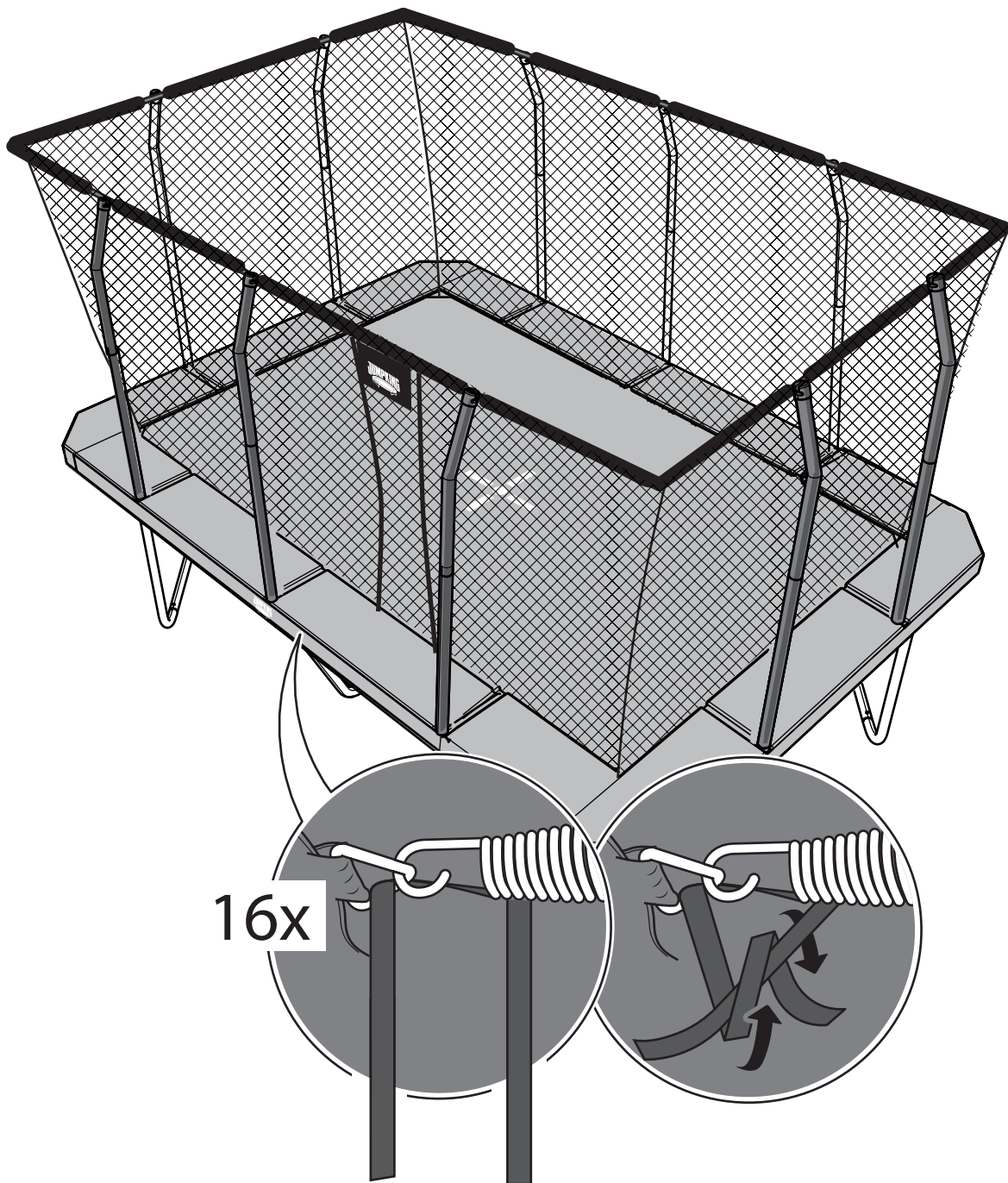

FRAME PART LIST

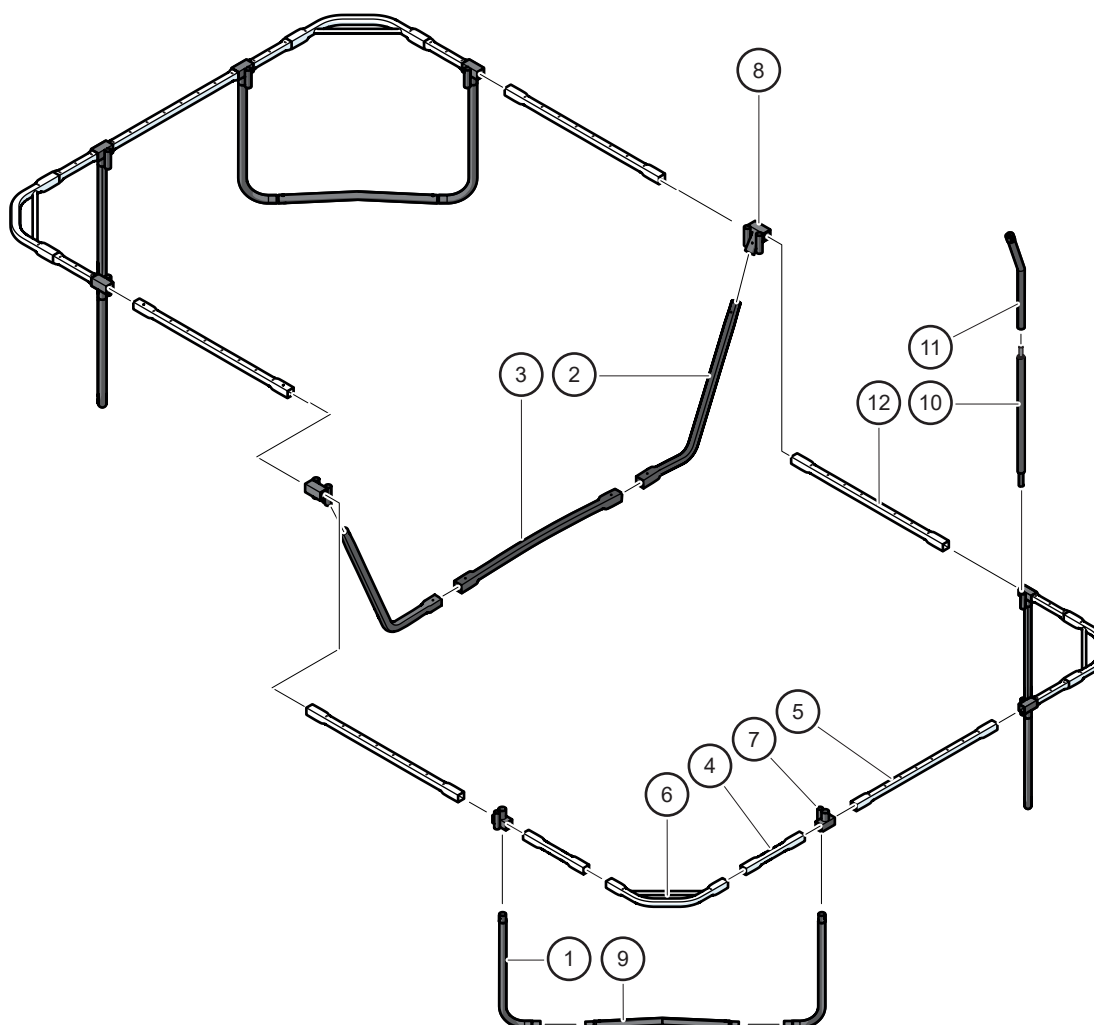

Pos	Description	Quantity	Part Number
1	L-leg	8	RRSPSLL
2	Centre support leg	2	RRSPSCLS
3	Centre support V-leg	1	RRSPSCLSV
4	Top tube "A"	8	RRSPSTT-A
5	Top tube "C"	2	RRSPSTT-C
6	L-top tube (corner)	4	RRSPSLTT
7	T-connector with 1 welded tube	8	RRSPSTCW1
8	T-connector with 2 welded tube	4	RRSPSTCW2

Pos	Description	Quantity	Part Number
9	Centre leg	4	RRSPSCL
10	Bottom pole rectangular 32 mm	12	90032NR
11	Top pole rectangular 32 mm	12	90032ÖR
12	Top tube "B"	4	RR1810V1TT-B

SPARE PART LIST

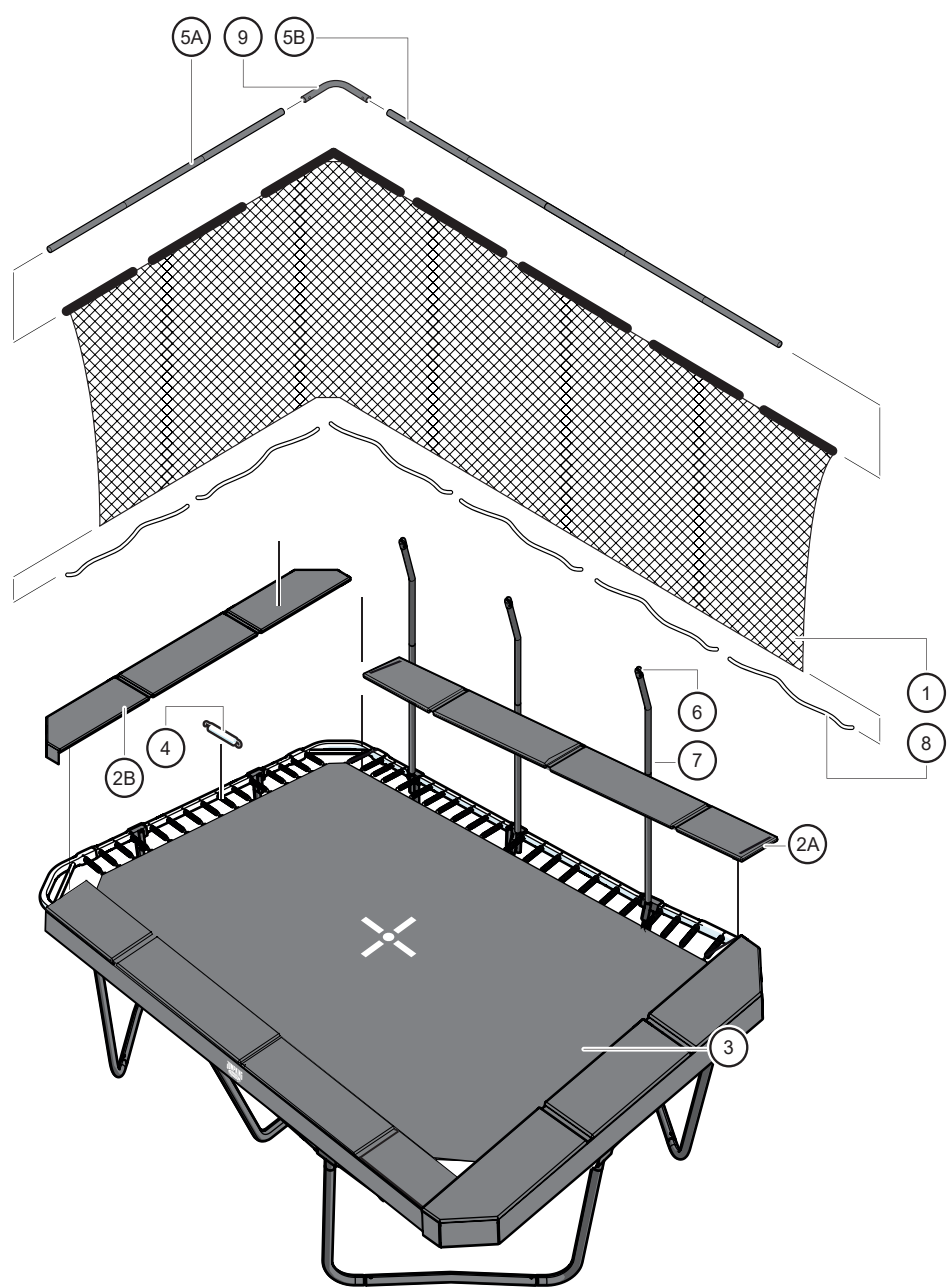

Pos	Description	Quantity	Part Number
1	Enclosure net	1	1014N
2A	Frame pad (long)	2	1014K1
2B	Frame pad (short)	2	10SPSK1
3	Bed	1	1014H
4	Spring	80	70025
5A	G3 set (short)	2	1014G1
5B	G3 set (long)	2	10SPSG1
6	G3 cap	12	127-32
7	Foam sleeve	24	71032XPE8P

Pos	Description	Quantity	Part Number
8	Enclosure net cord	8	70025
9	G3 connector	4	MG3REC
-	Spring tool	1	565
-	Self tapping screw	36	90041