

JUMPING RECTANGULAR 12

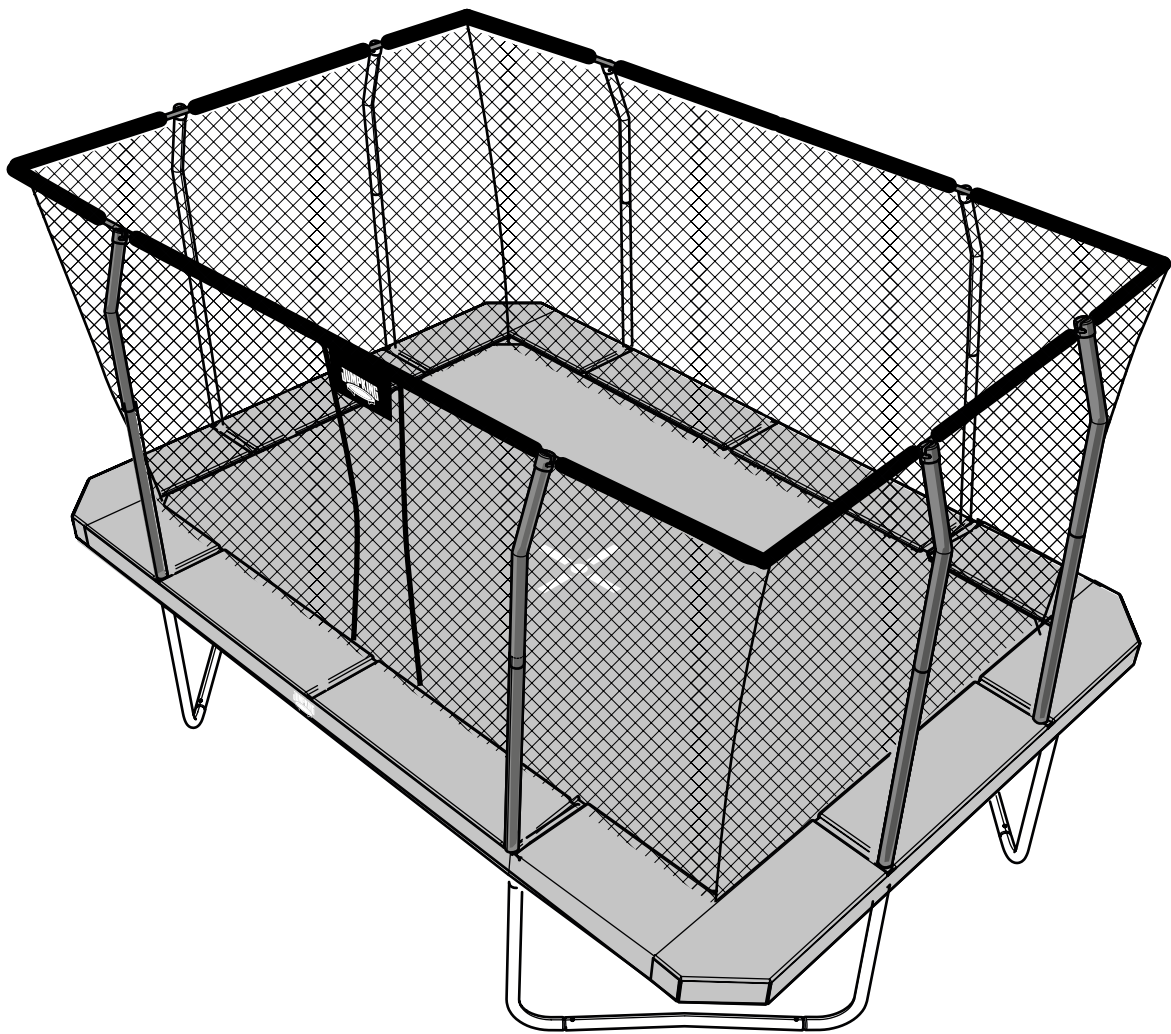

Jumpking Studsmattor Sweden AB is not liable or bound by warranty if these instructions are not adhered to during assemble, or if the equipment is modified without written consent from the manufacturer.

Copyright © 2020 Jumpking Studsmattor Sweden AB

Jumpking Studsmattor Sweden AB can accept no responsibility for possible errors in catalogues, brochures and other printed material. Jumpking Studsmattor Sweden AB reserves the right to alter its products without notice. This also applies to products already on order provided that such alterations can be made without sub sequential changes being necessary in specifications already agreed.

All rights reserved.

All other trademarks are the properties of their respective owners.

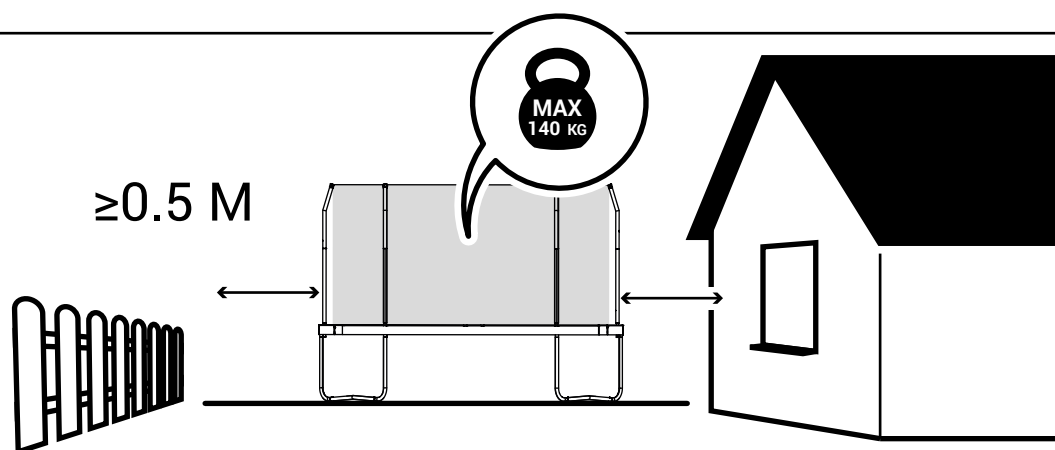
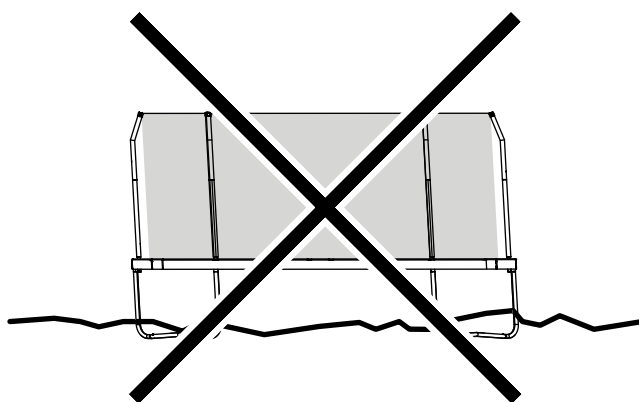
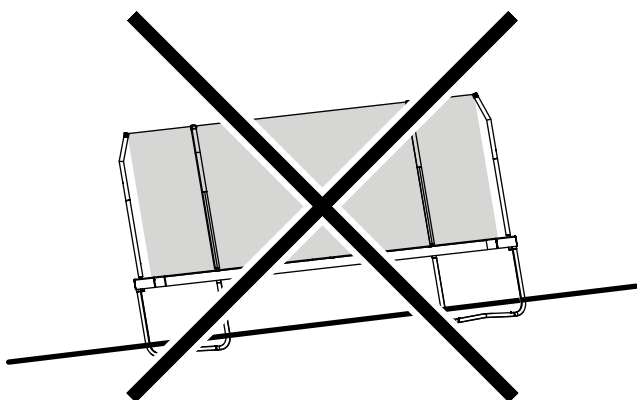
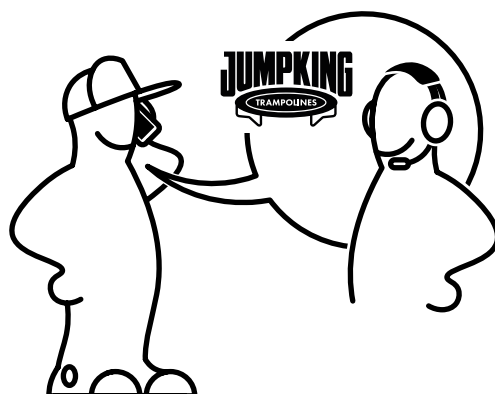
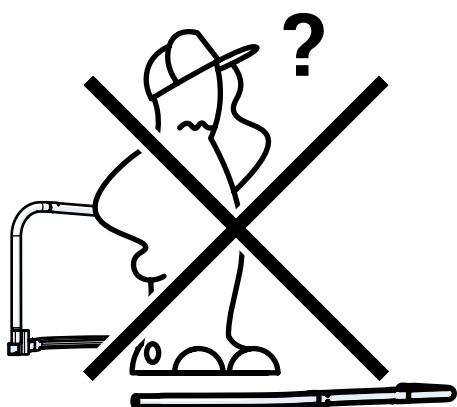
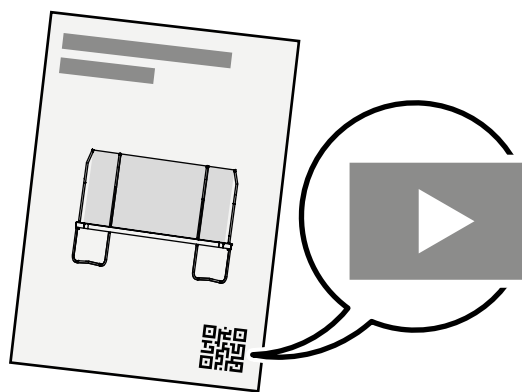
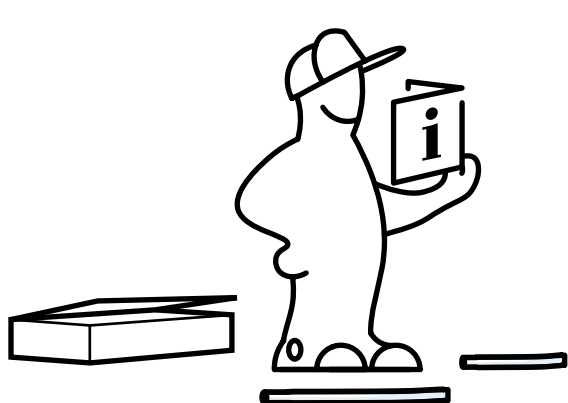

For information regarding care and maintenance, visit your local Jumping website.

ASSEMBLE THE CORNER SECTIONS

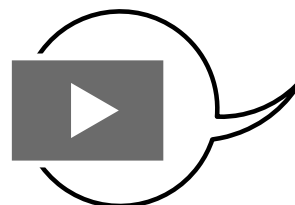
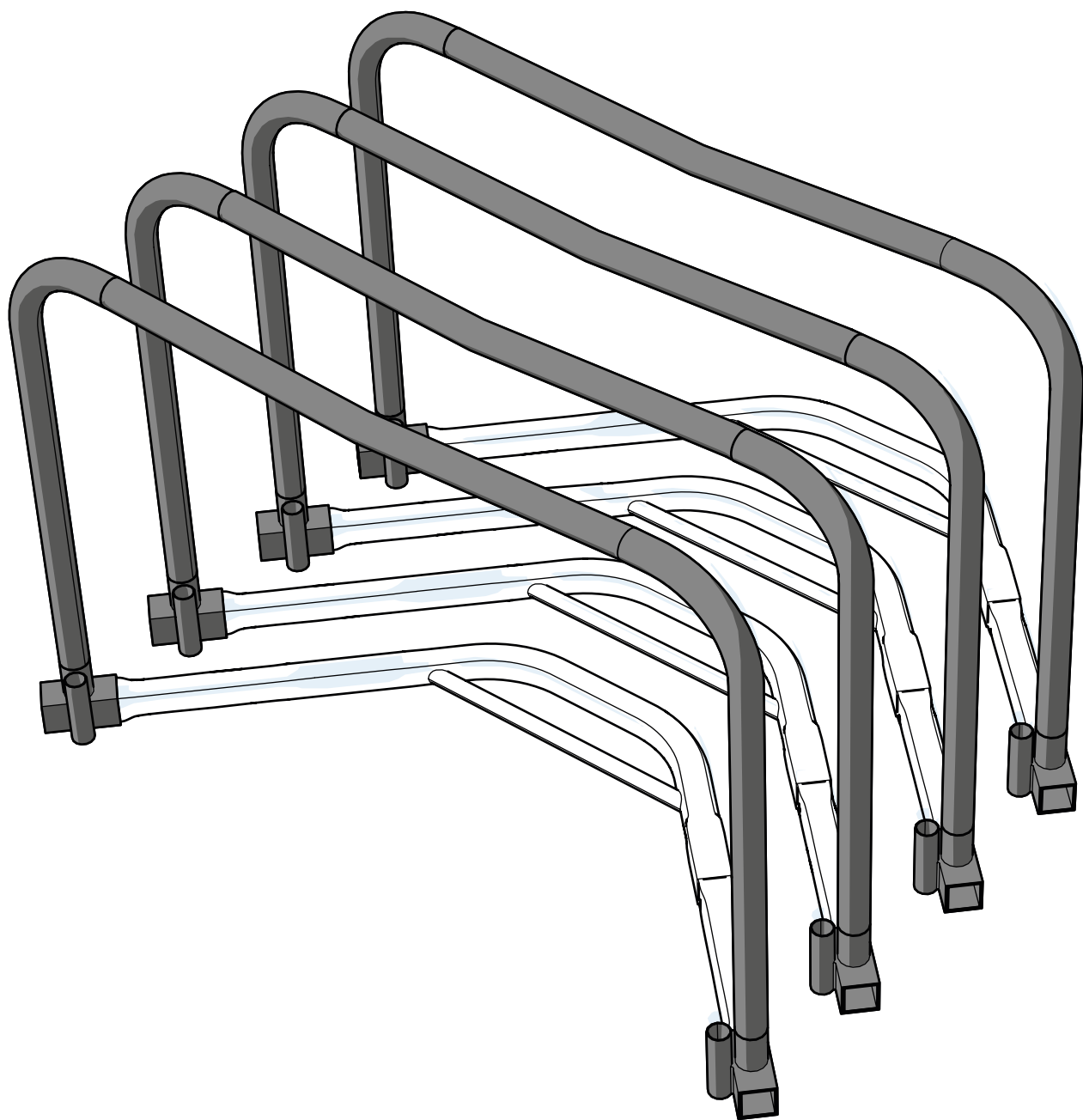

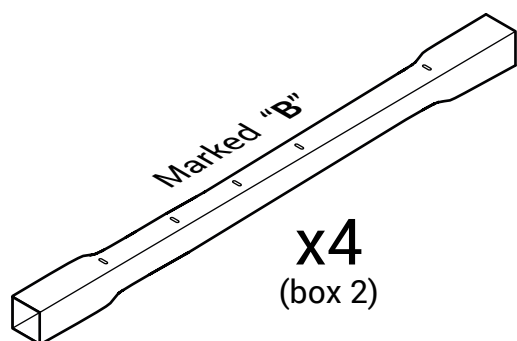
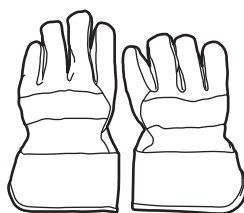
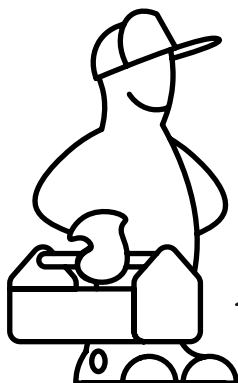

x4
(box 2)

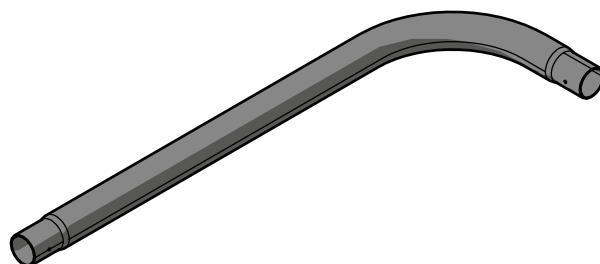

x8
(box 1)

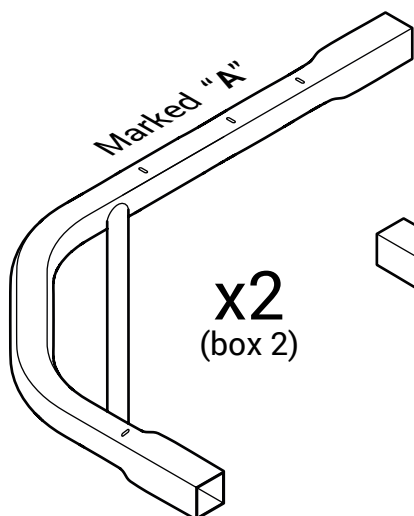

x2
(box 2)

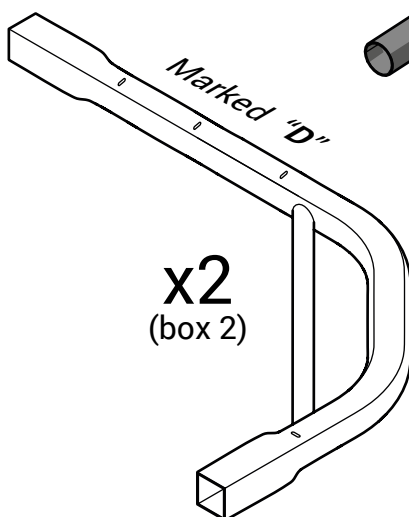

x2
(box 2)

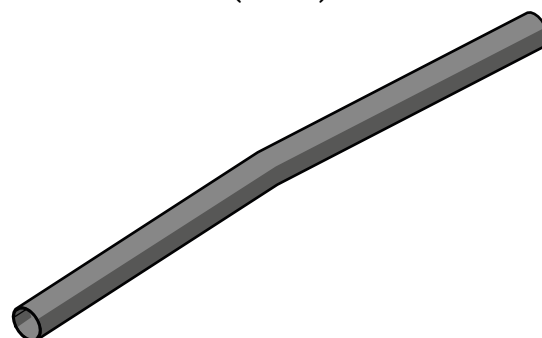

x4
(box 1)



x16
(box 1)

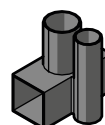

x8
(box 1)

1

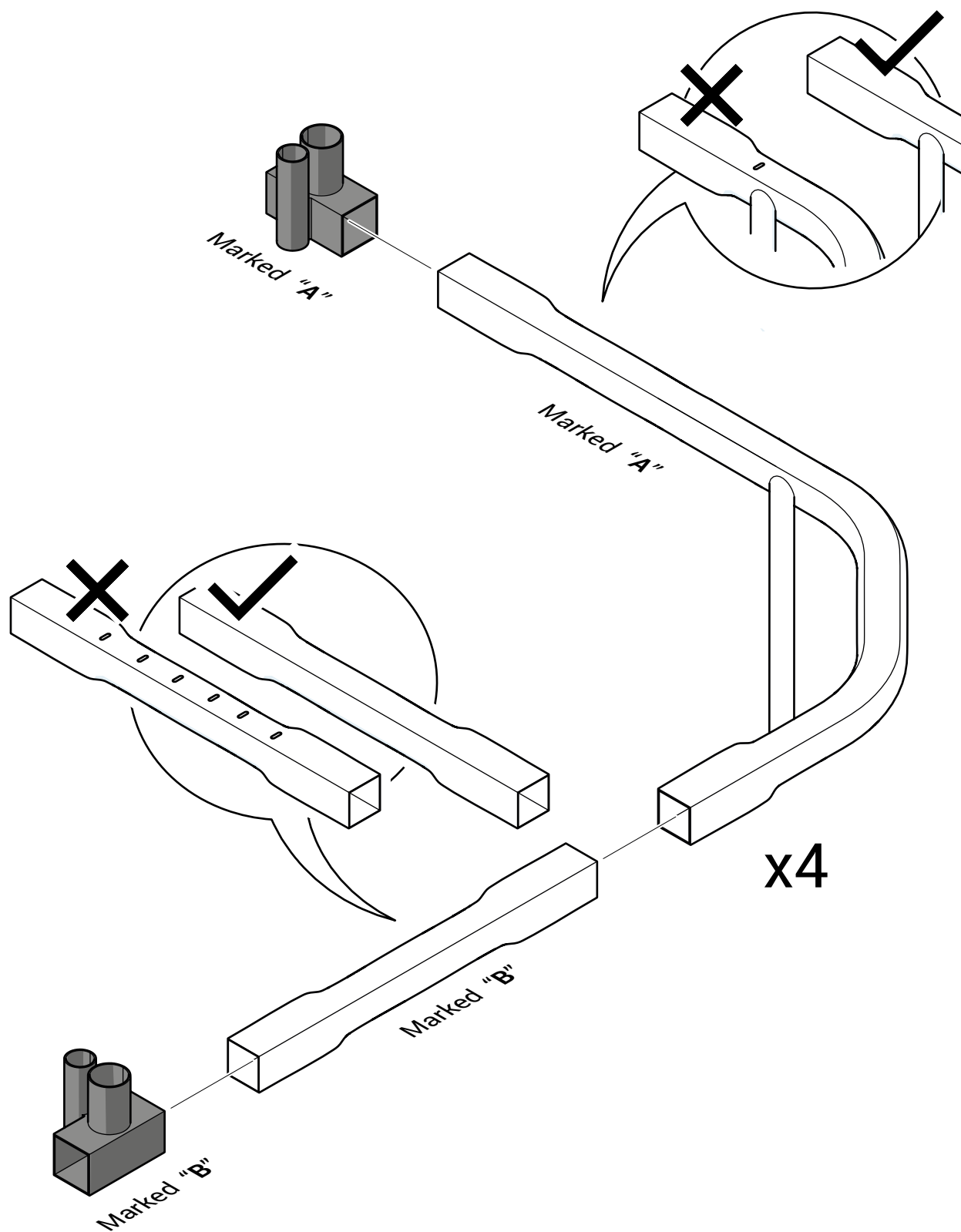

2

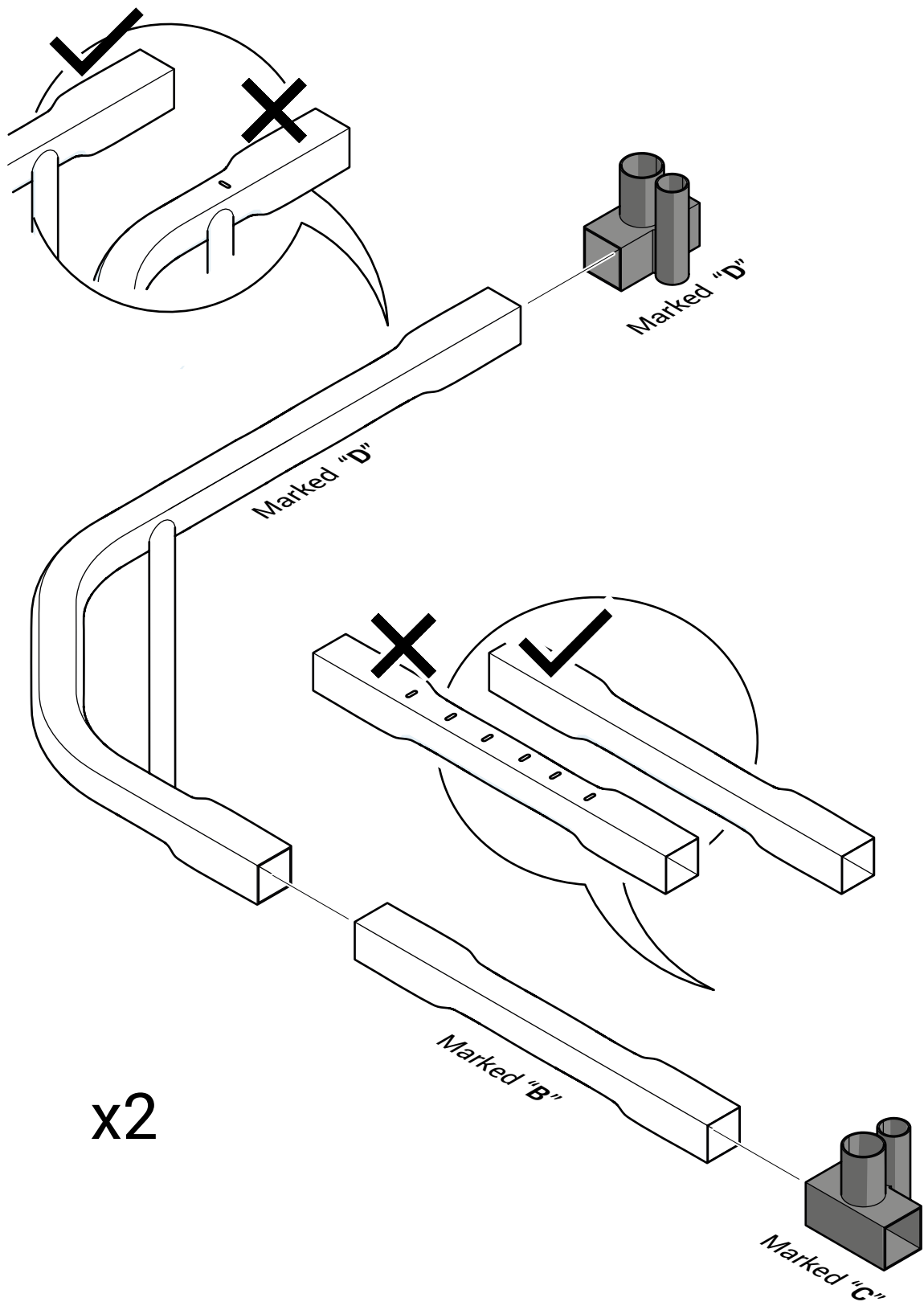

3

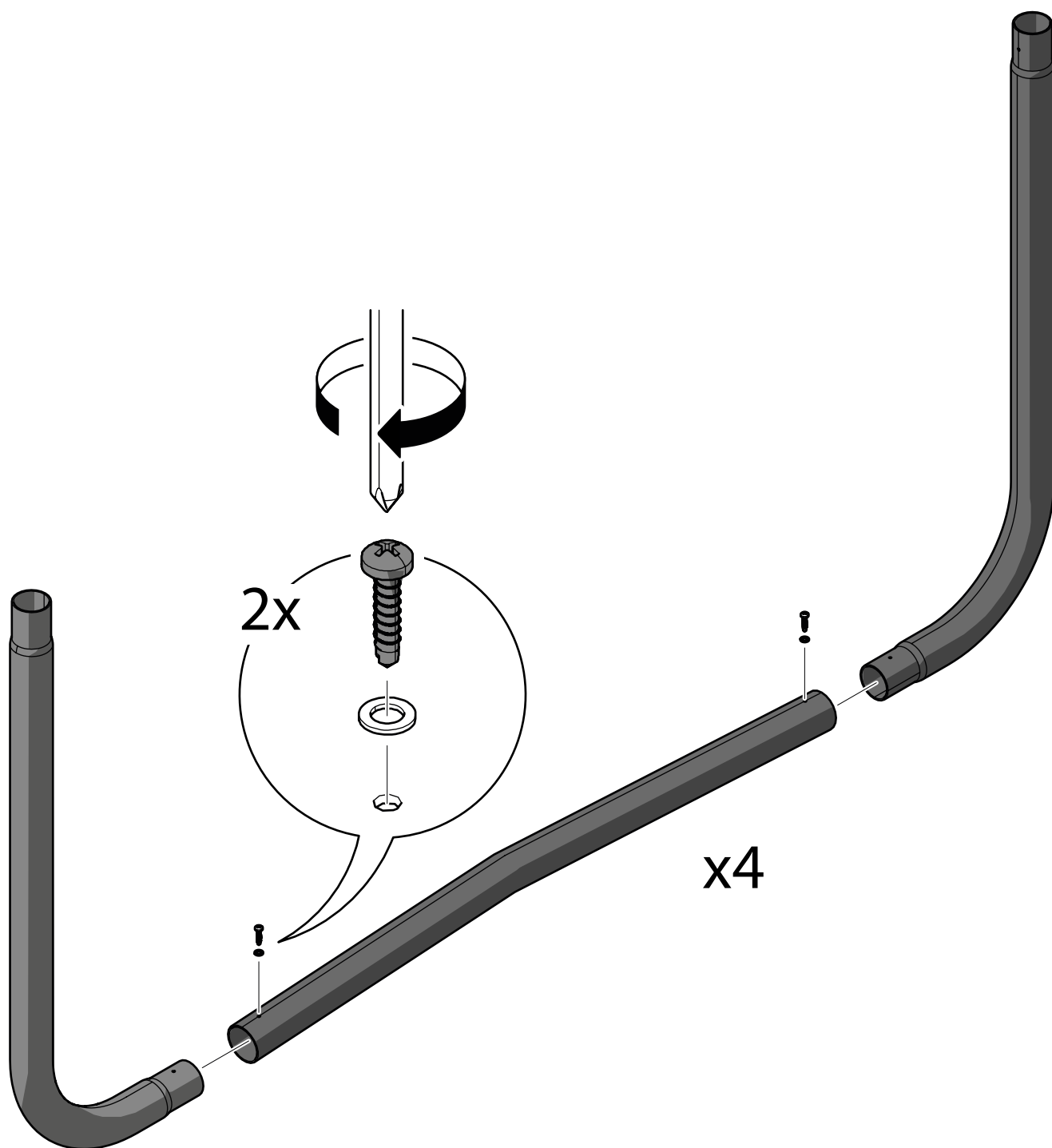

4

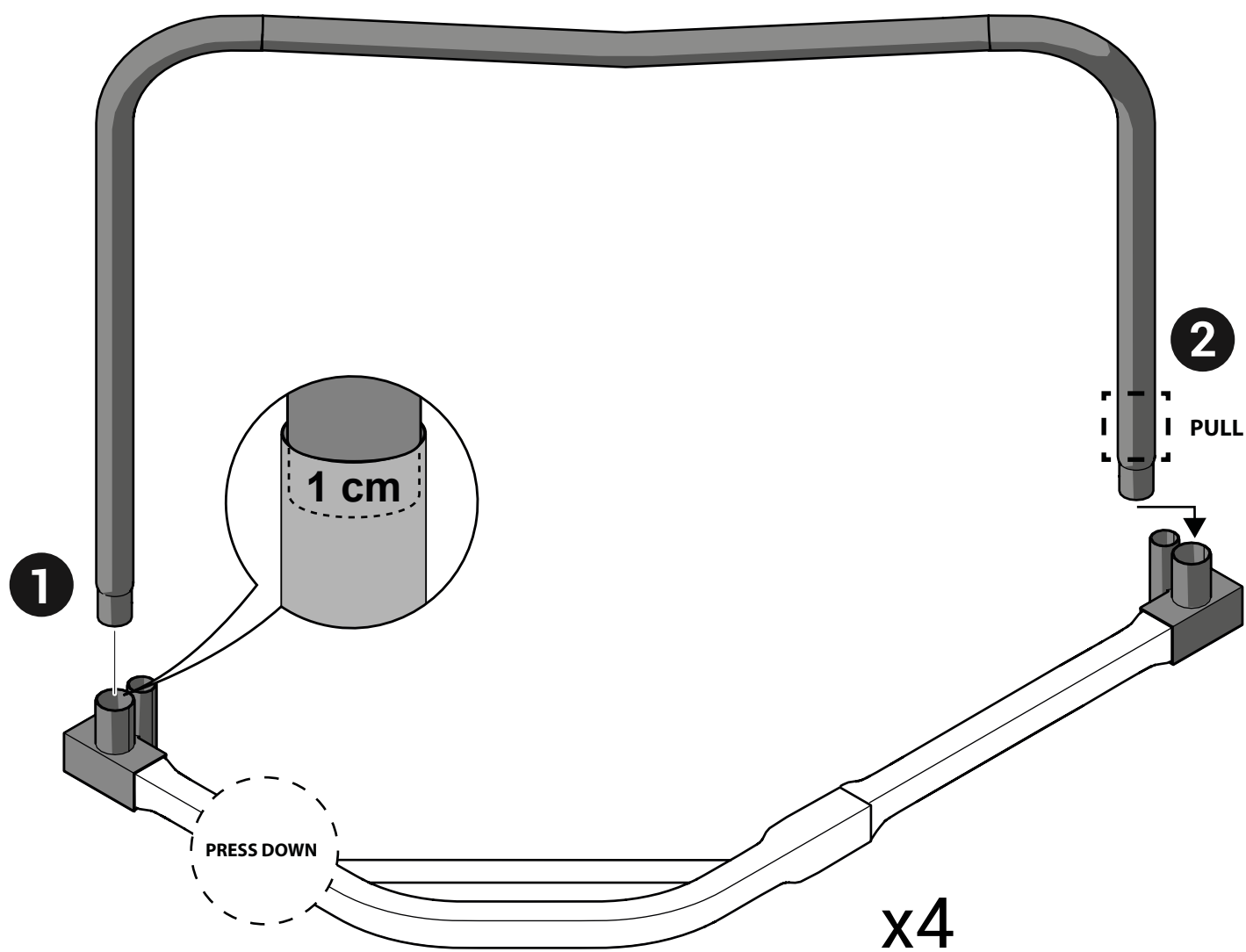

5

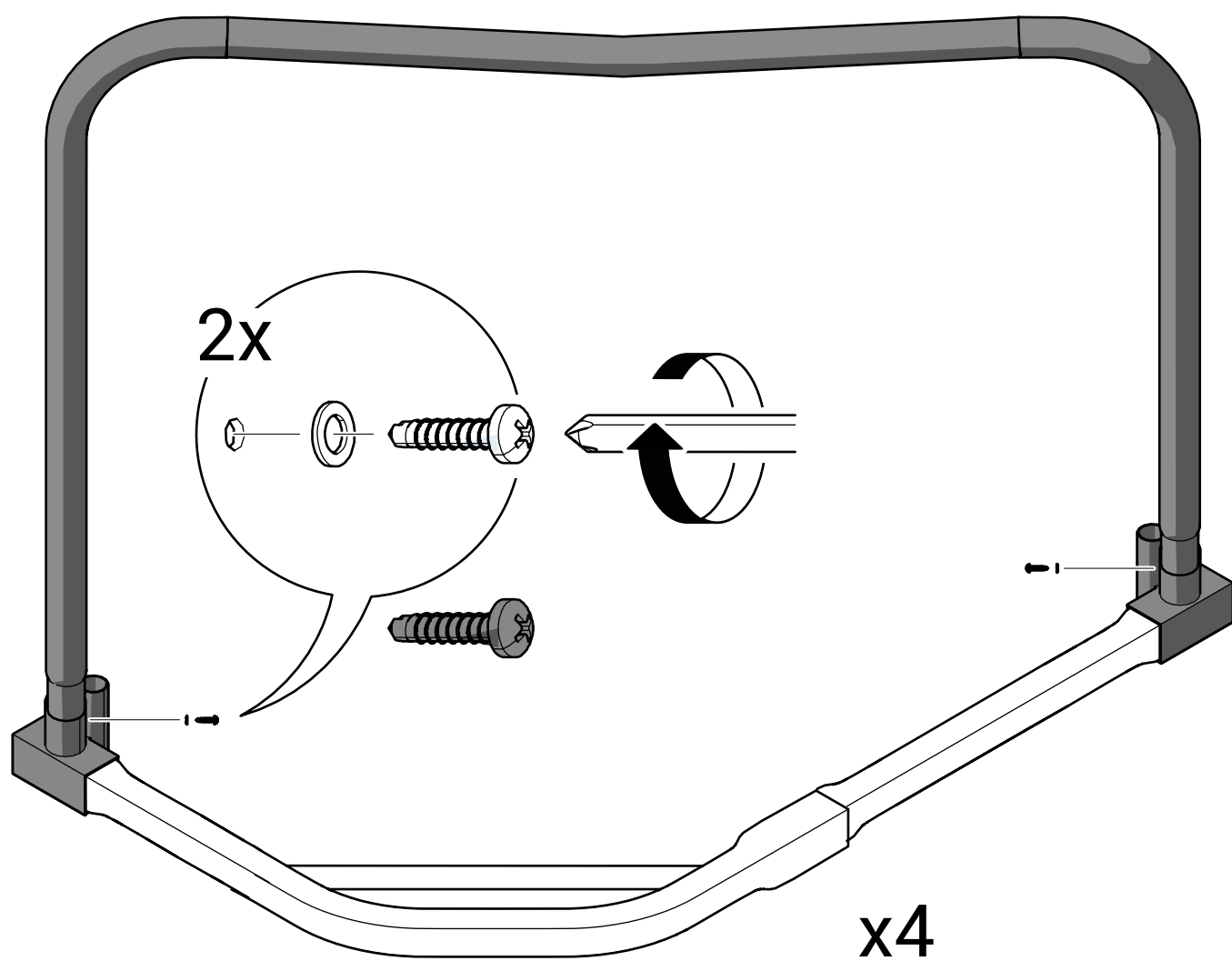

ASSEMBLE THE FRAME

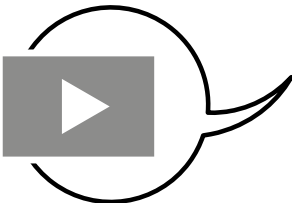
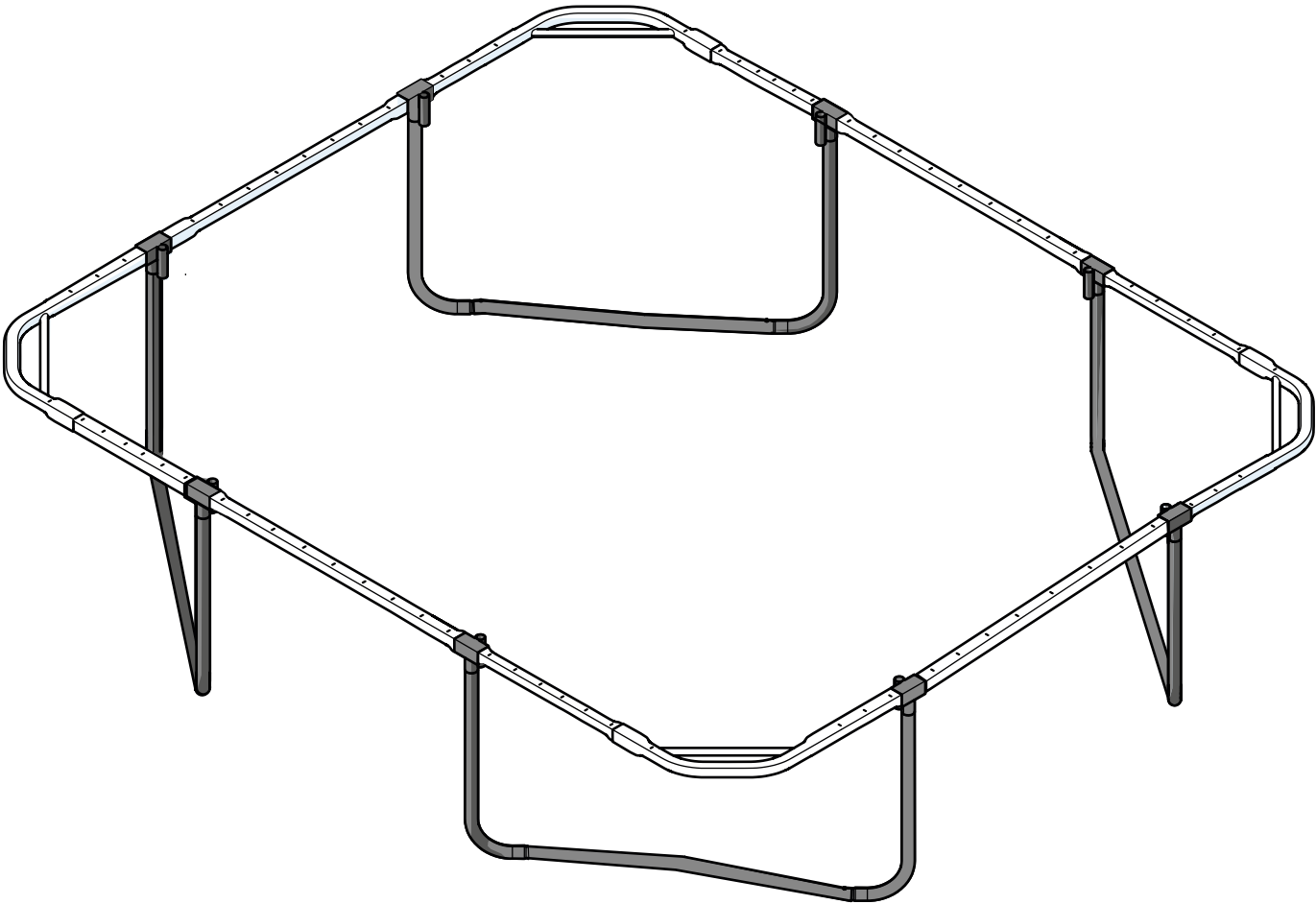

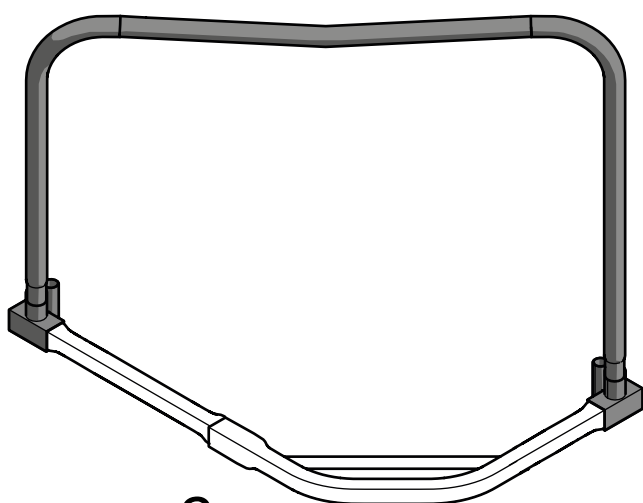
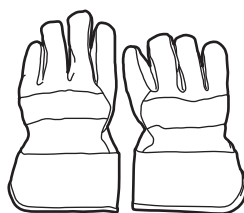
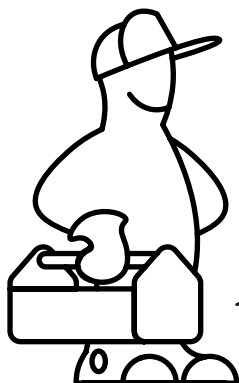

x2

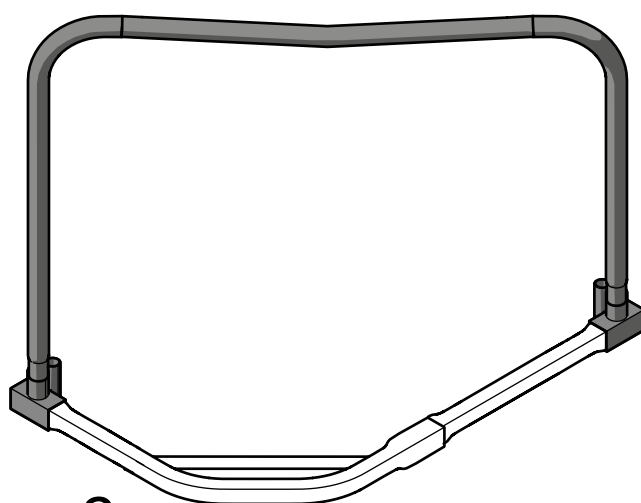

x2

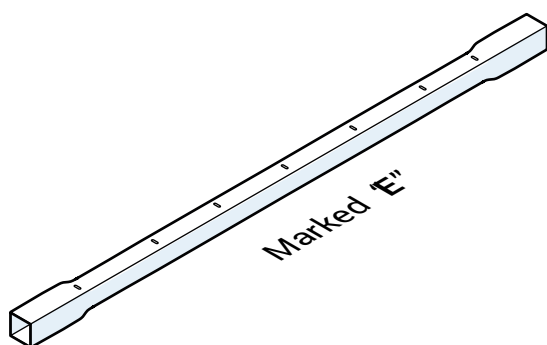

x2
(box 2)

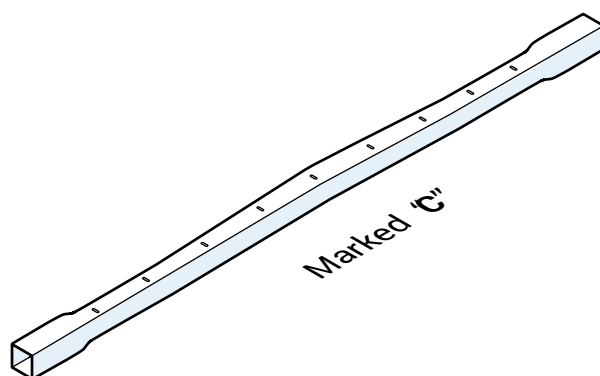

x2
(box 2)

1

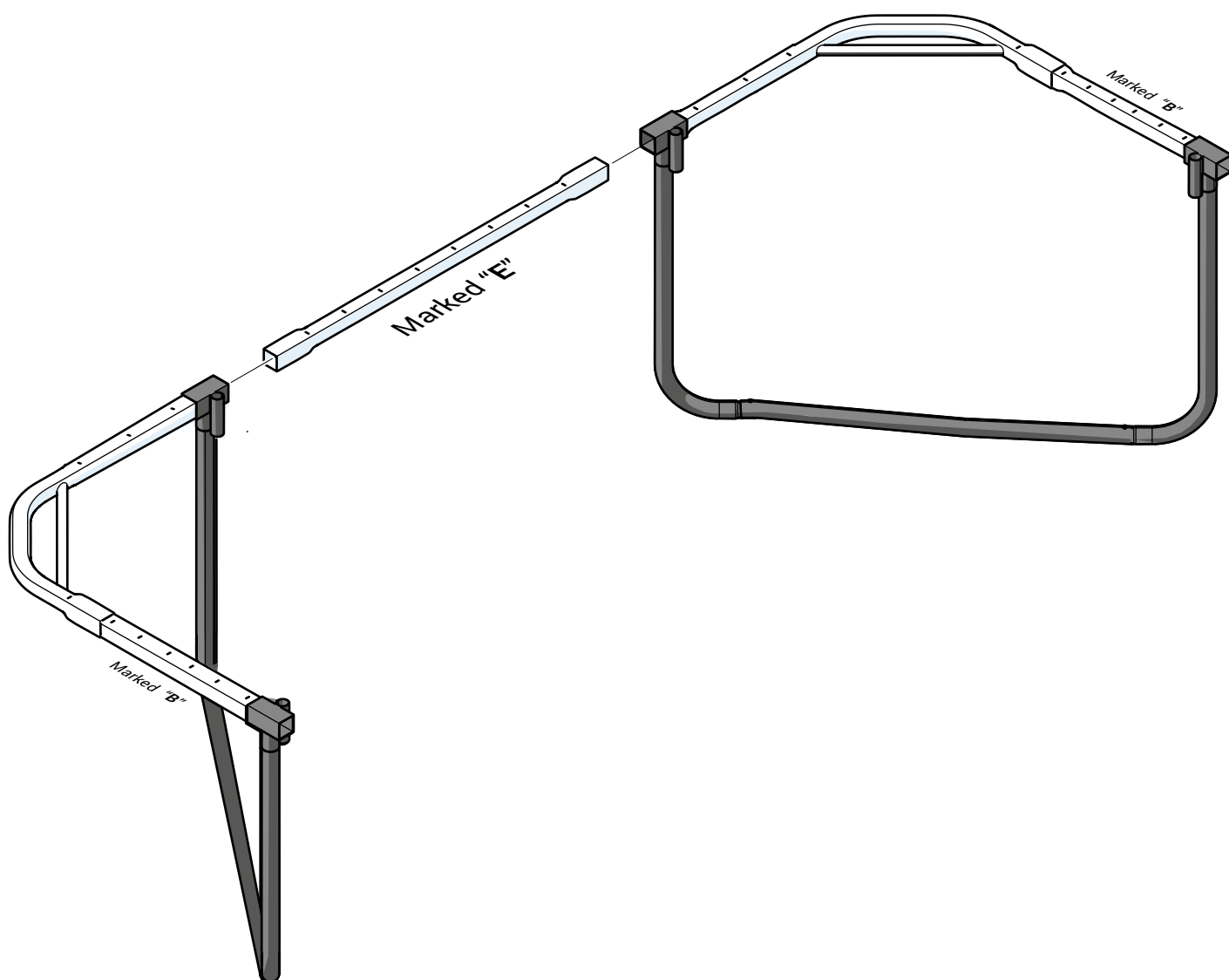

2

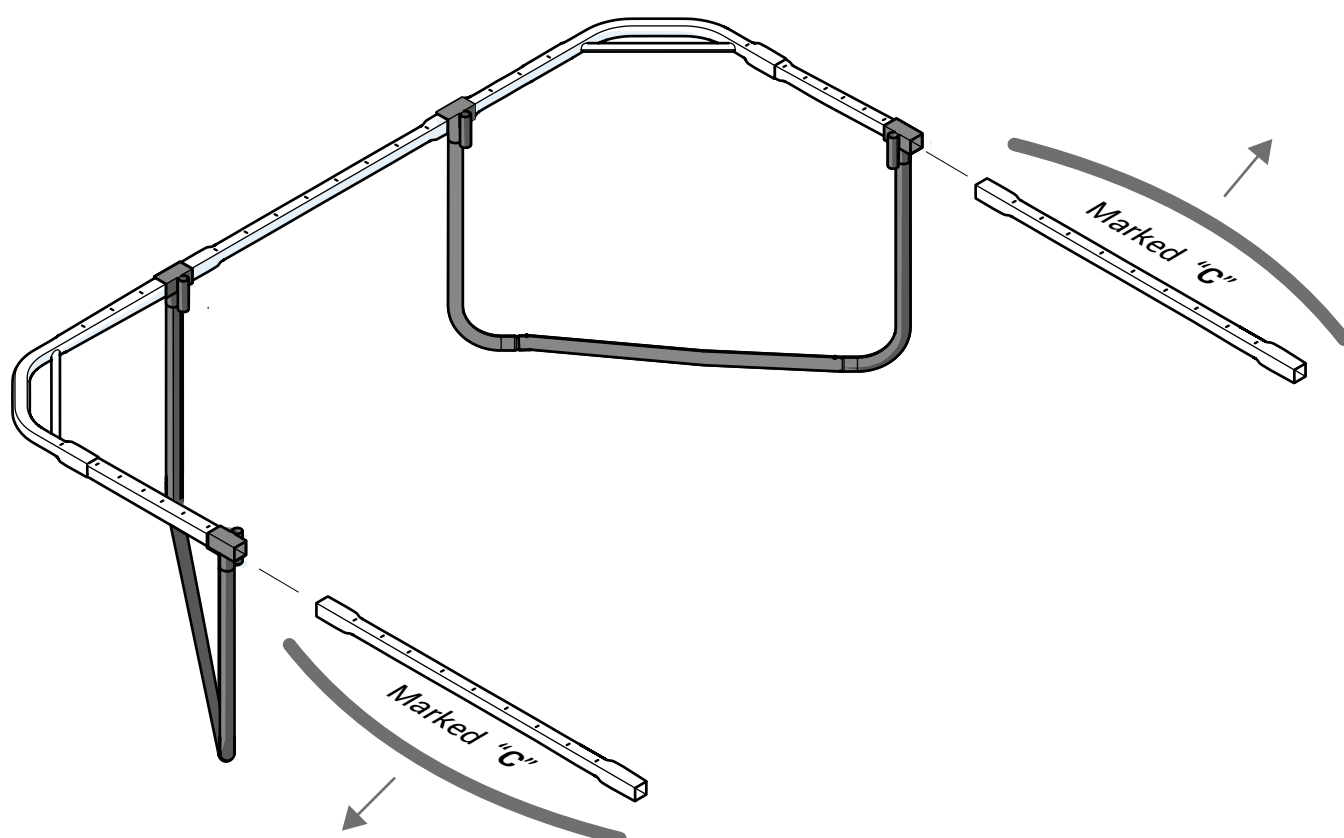

En: The slightly convex side should point outwards

Sv: Den något konvexa sidan ska peka utåt

No: Den litt konvekse siden skal peke utover

Dk: Den let konvekse side skal pege udad

Fi: Hieman kuperan puolen tulee osoittaa ulospäin

3

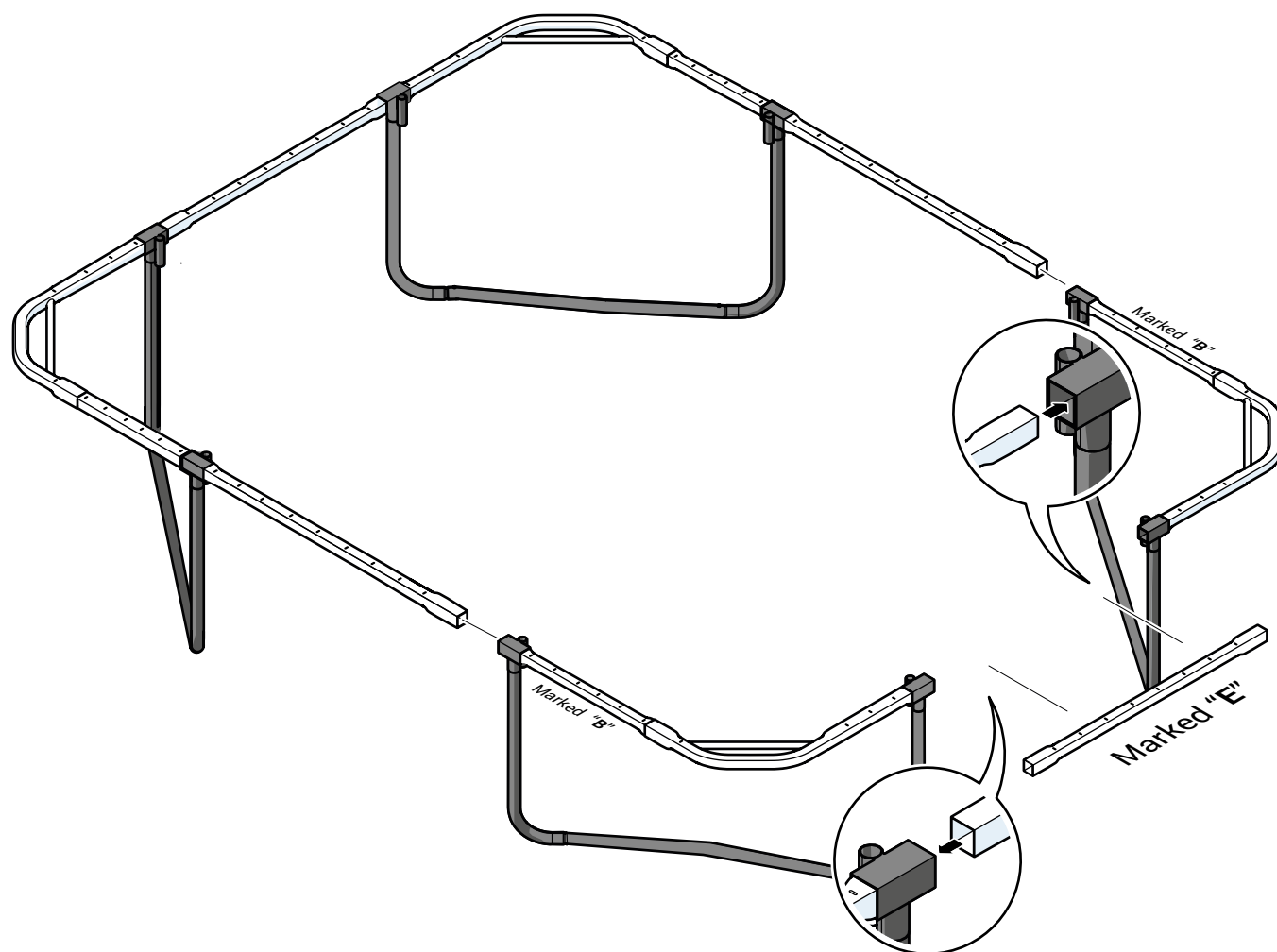

ATTACH THE STITCHED BED

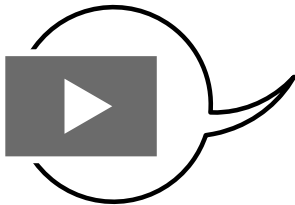
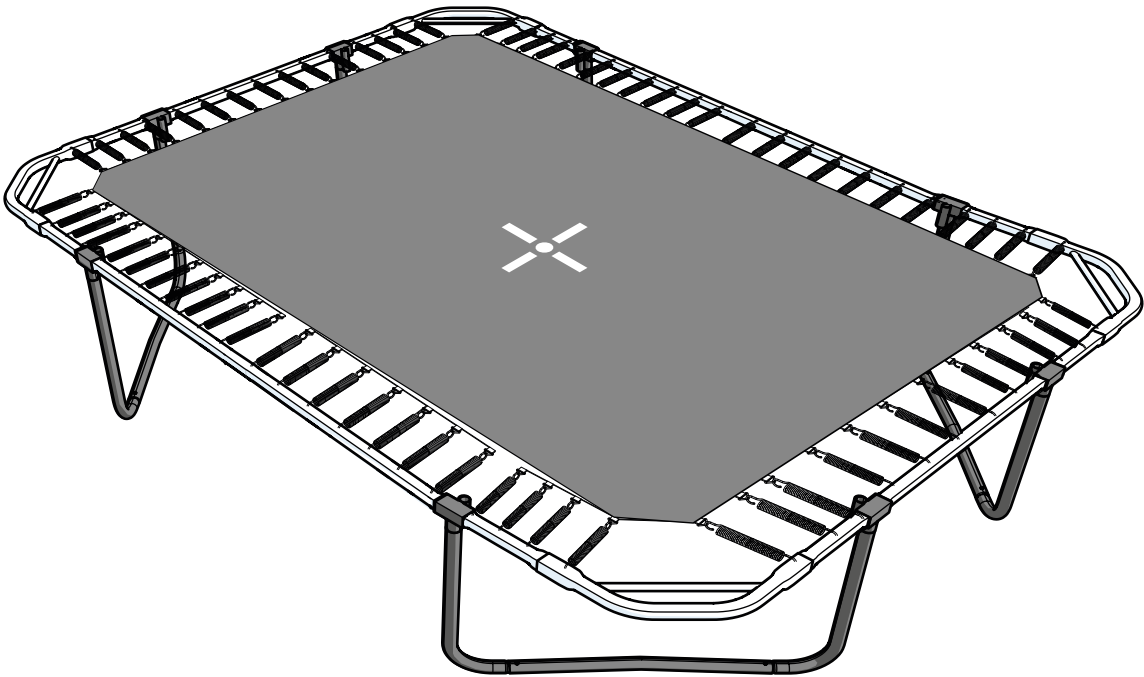

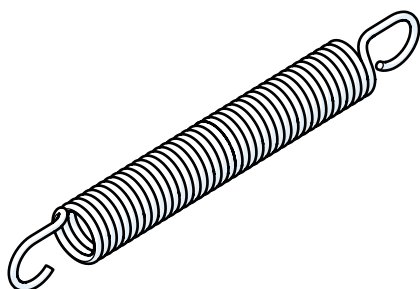
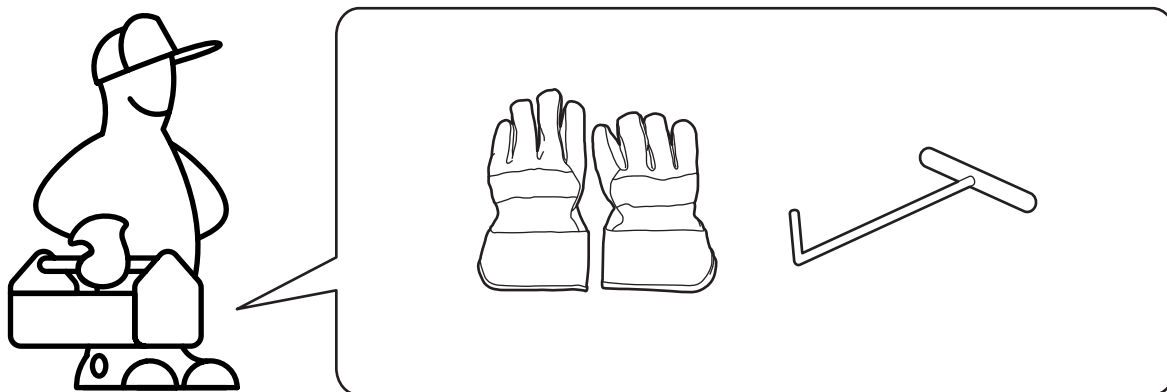

x72
(box 1)

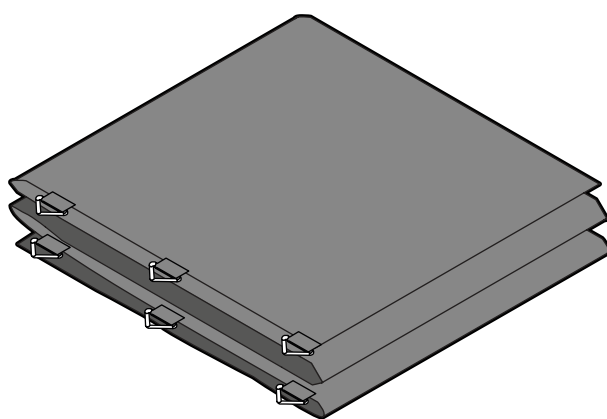

x1
(box 2)

1

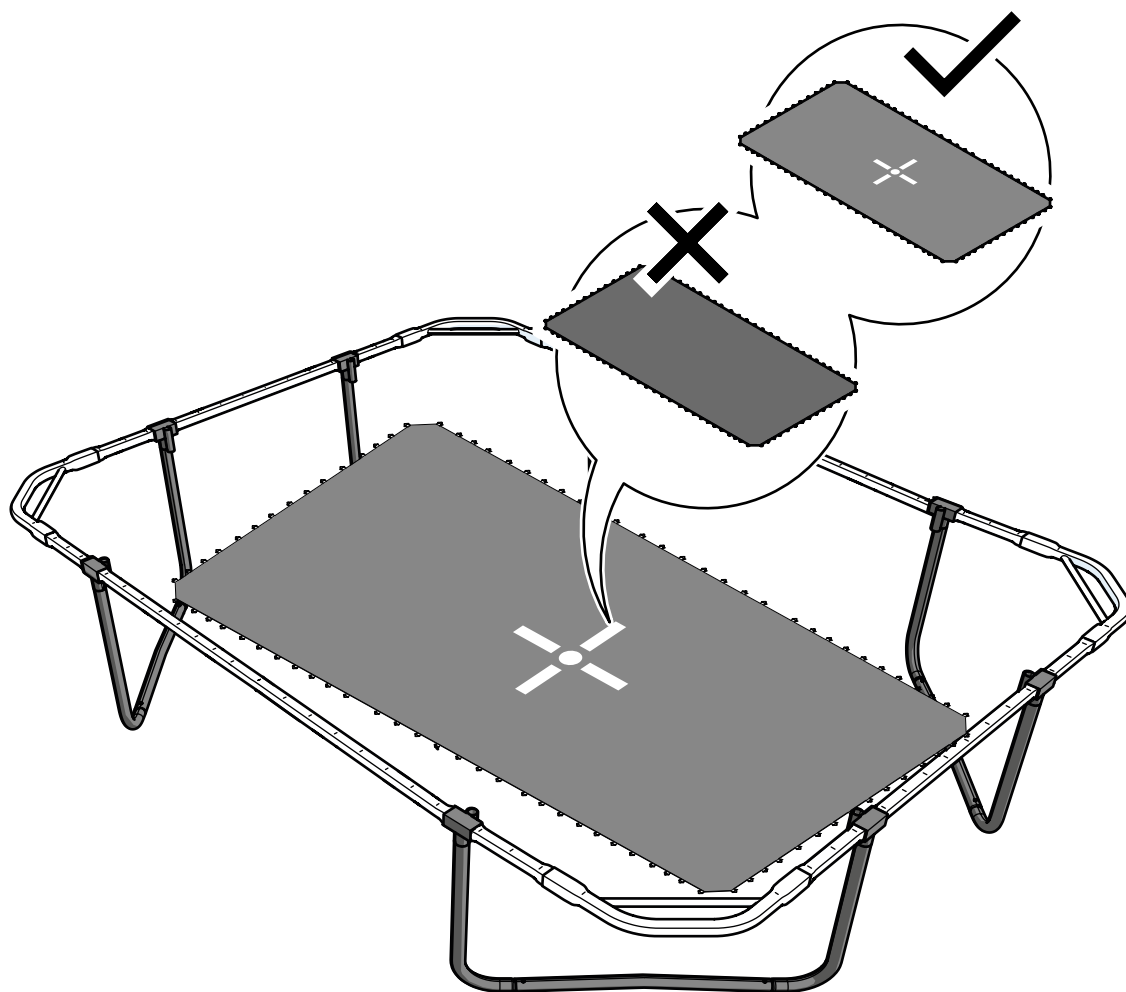

2

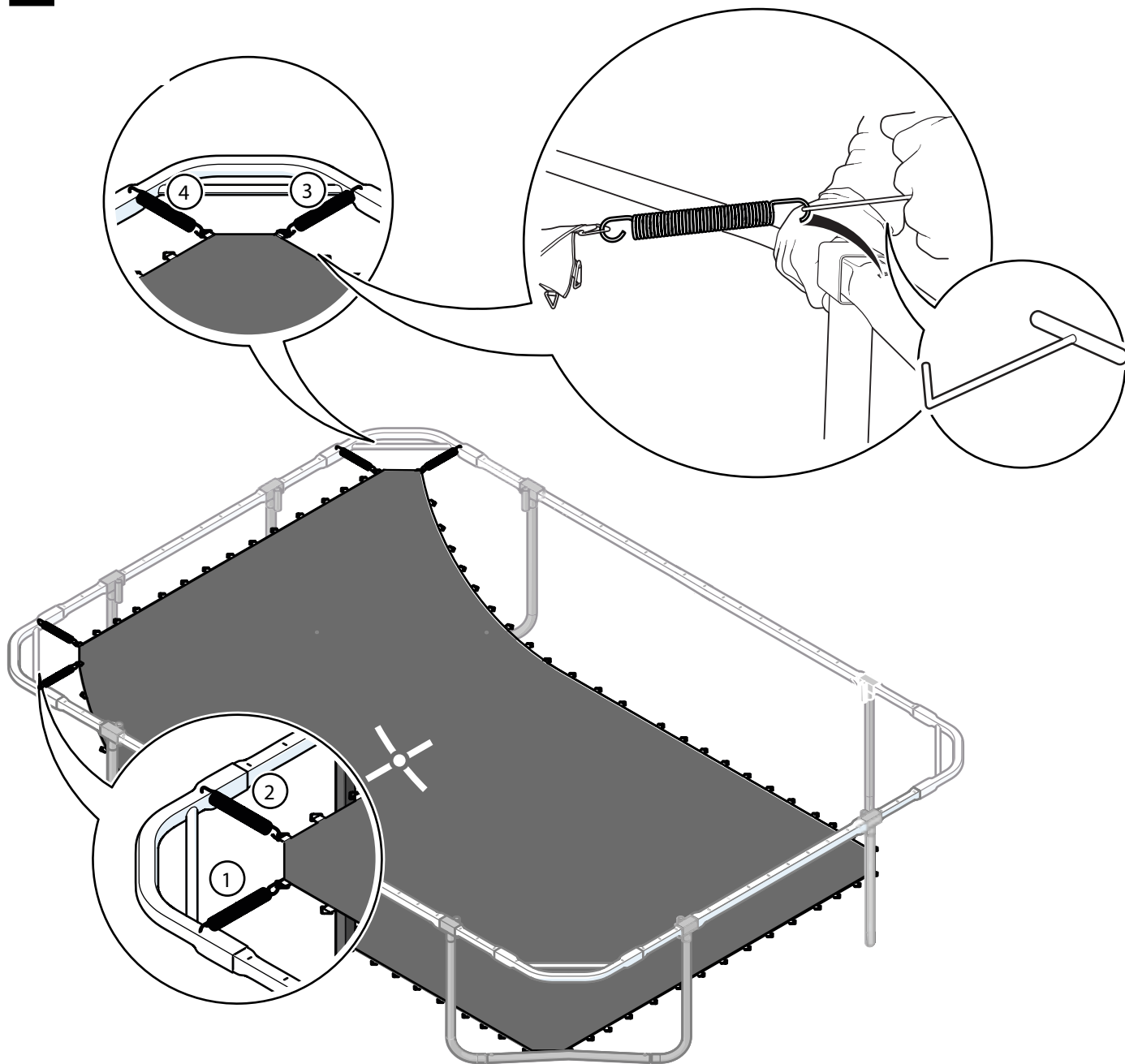

3

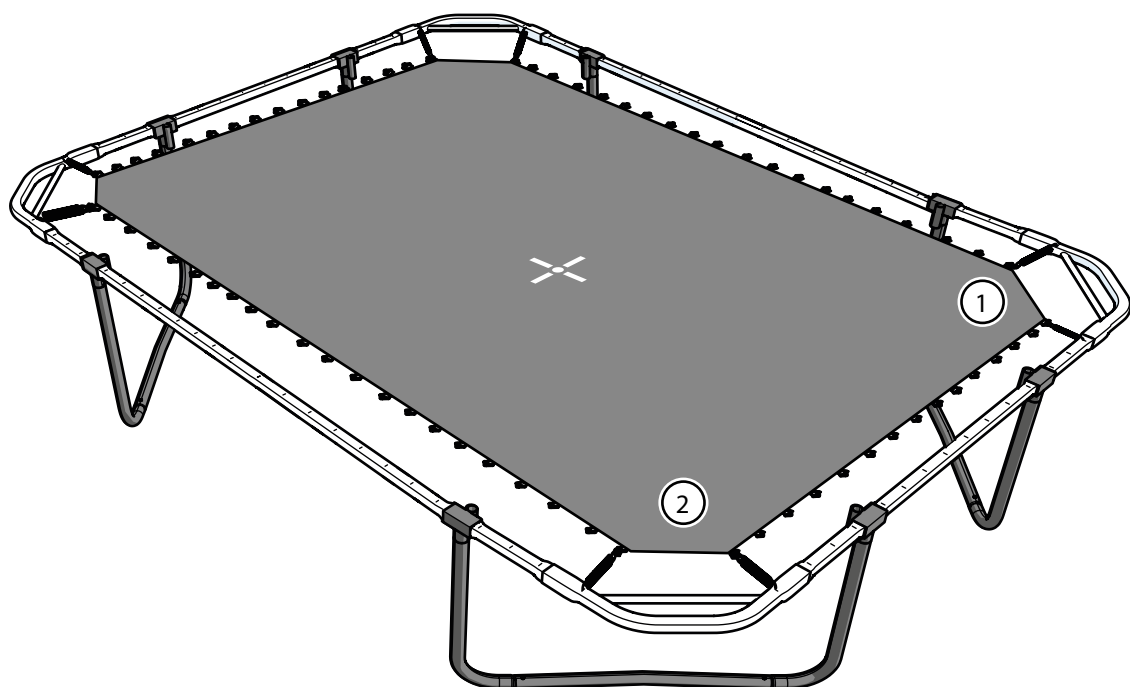

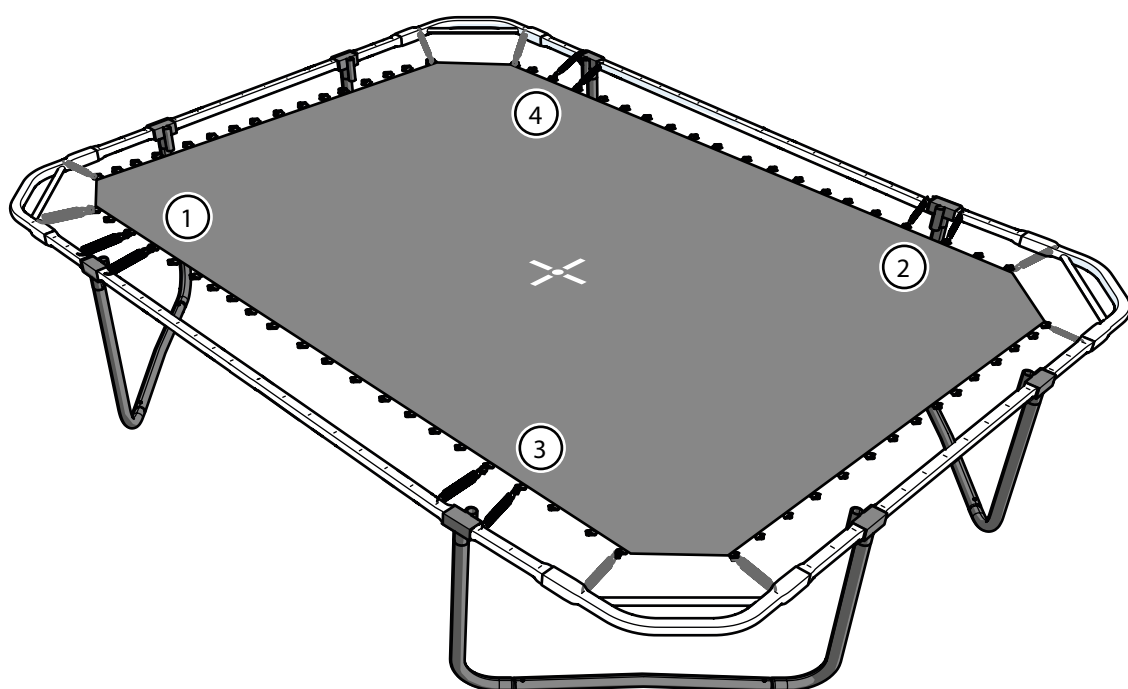

5

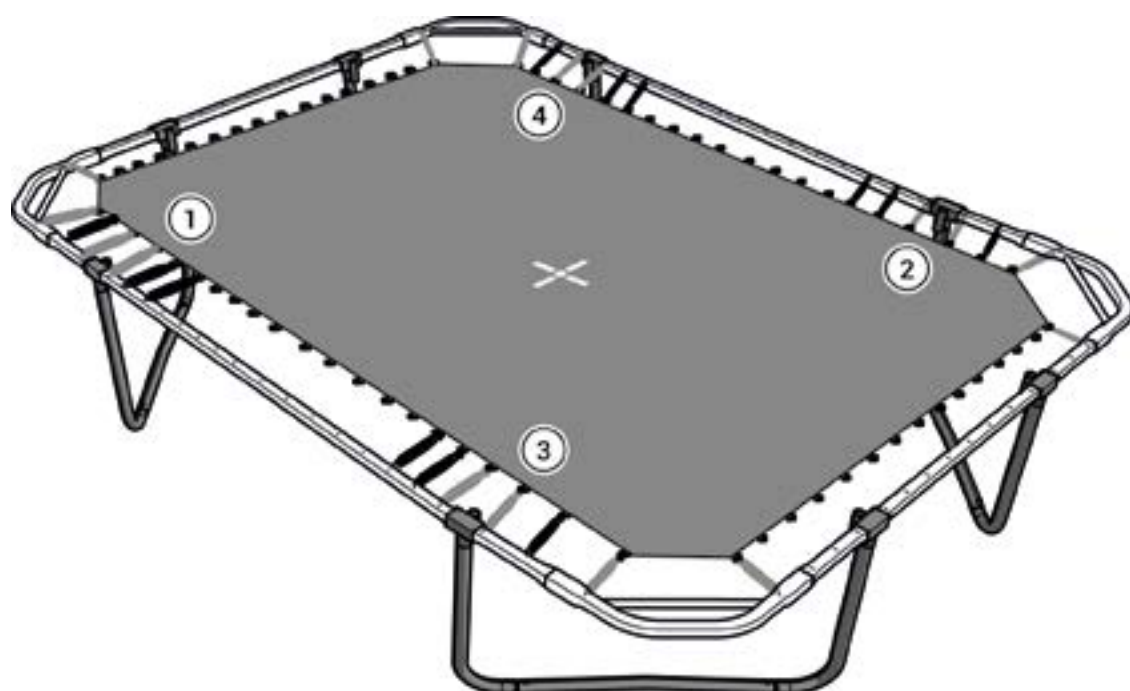

6

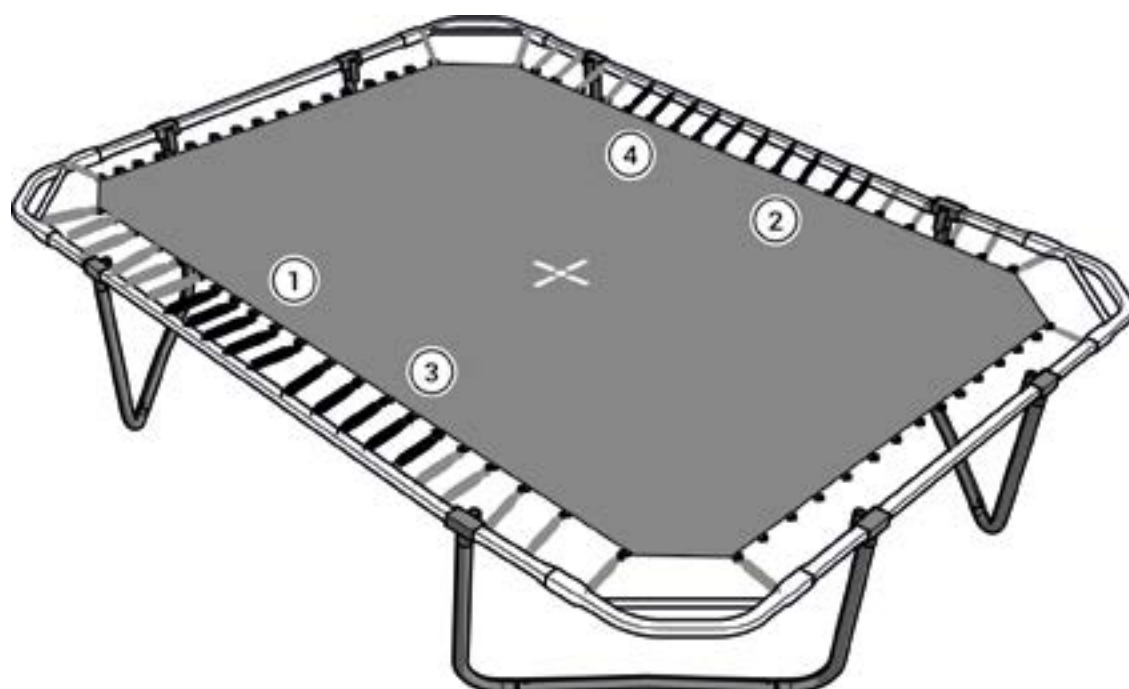

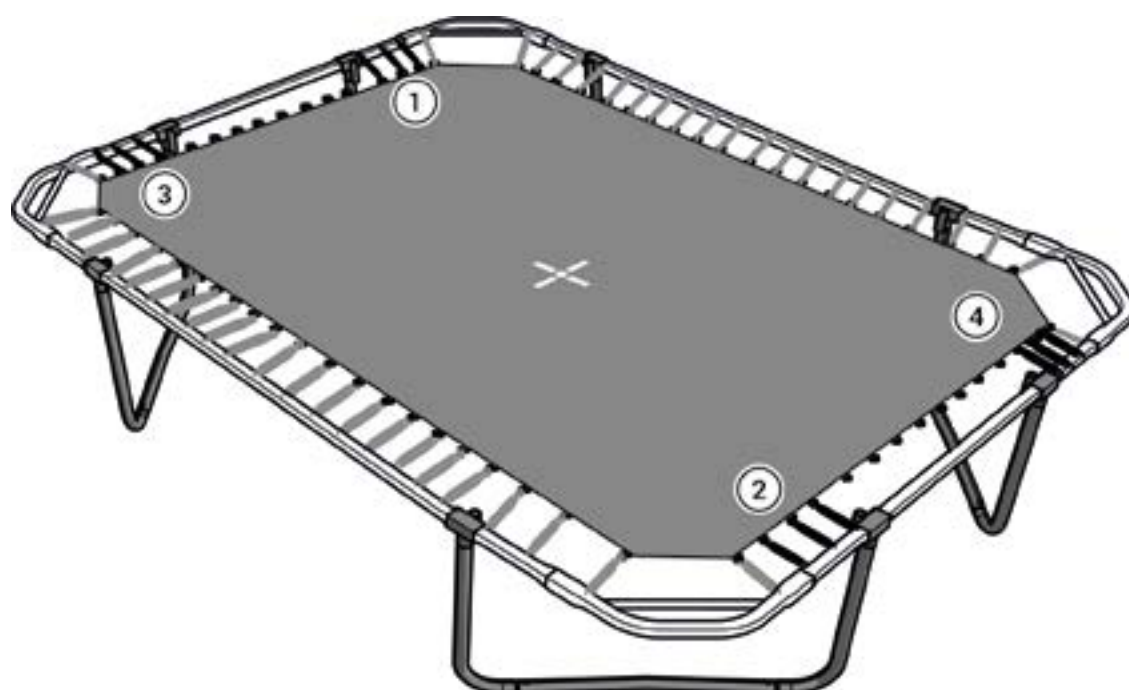

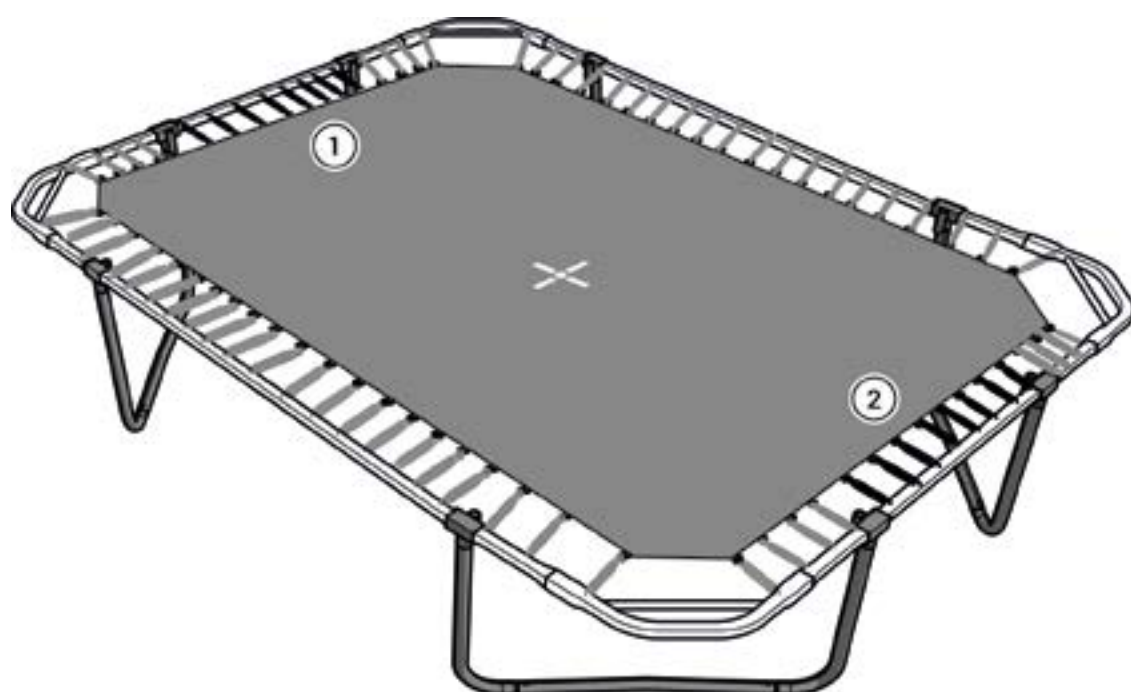

ATTACH THE FRAME PAD

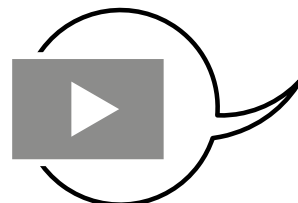
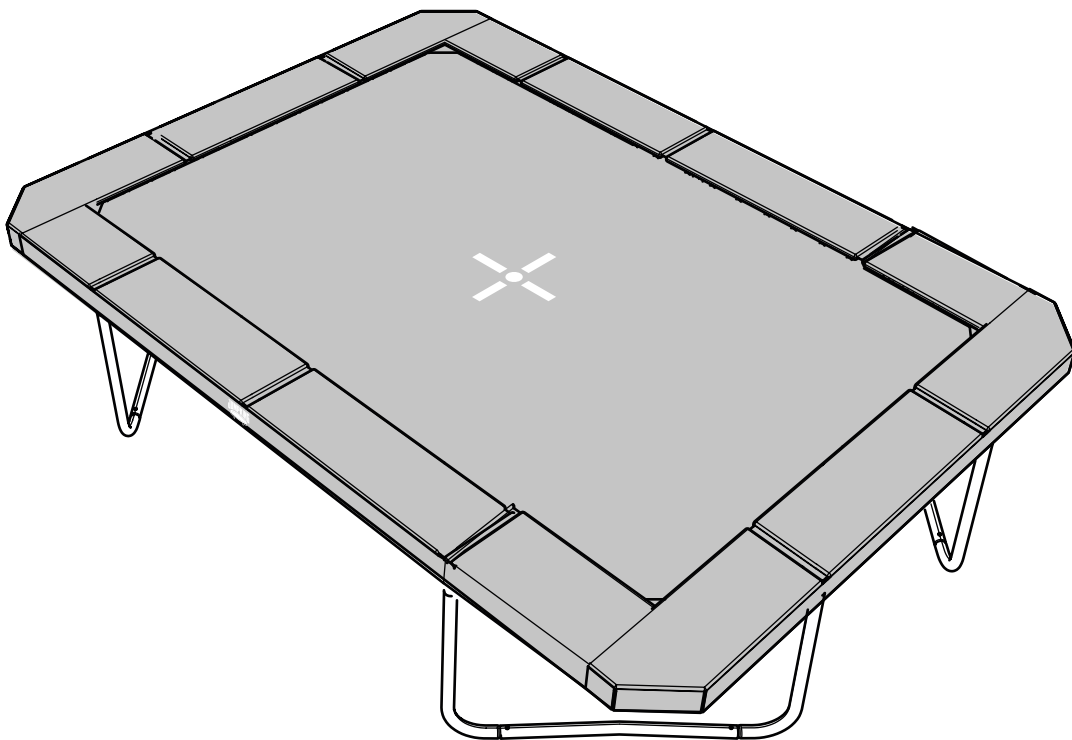

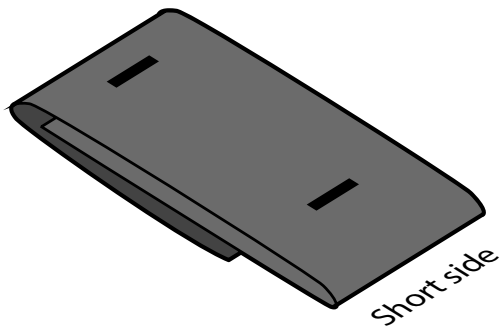
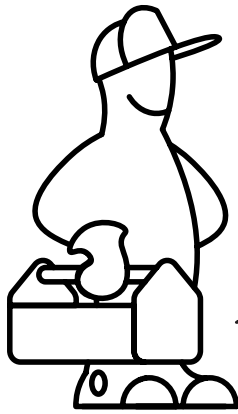

x2
(box 1)

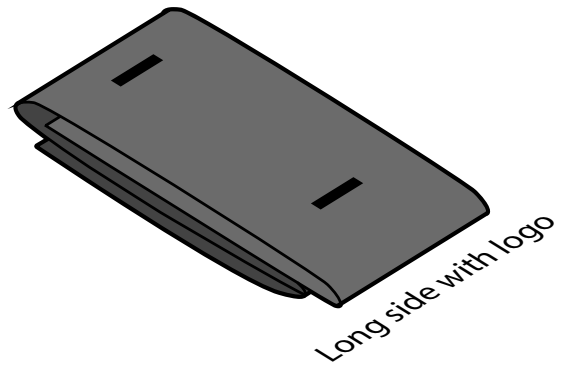

x2
(box 1)

1

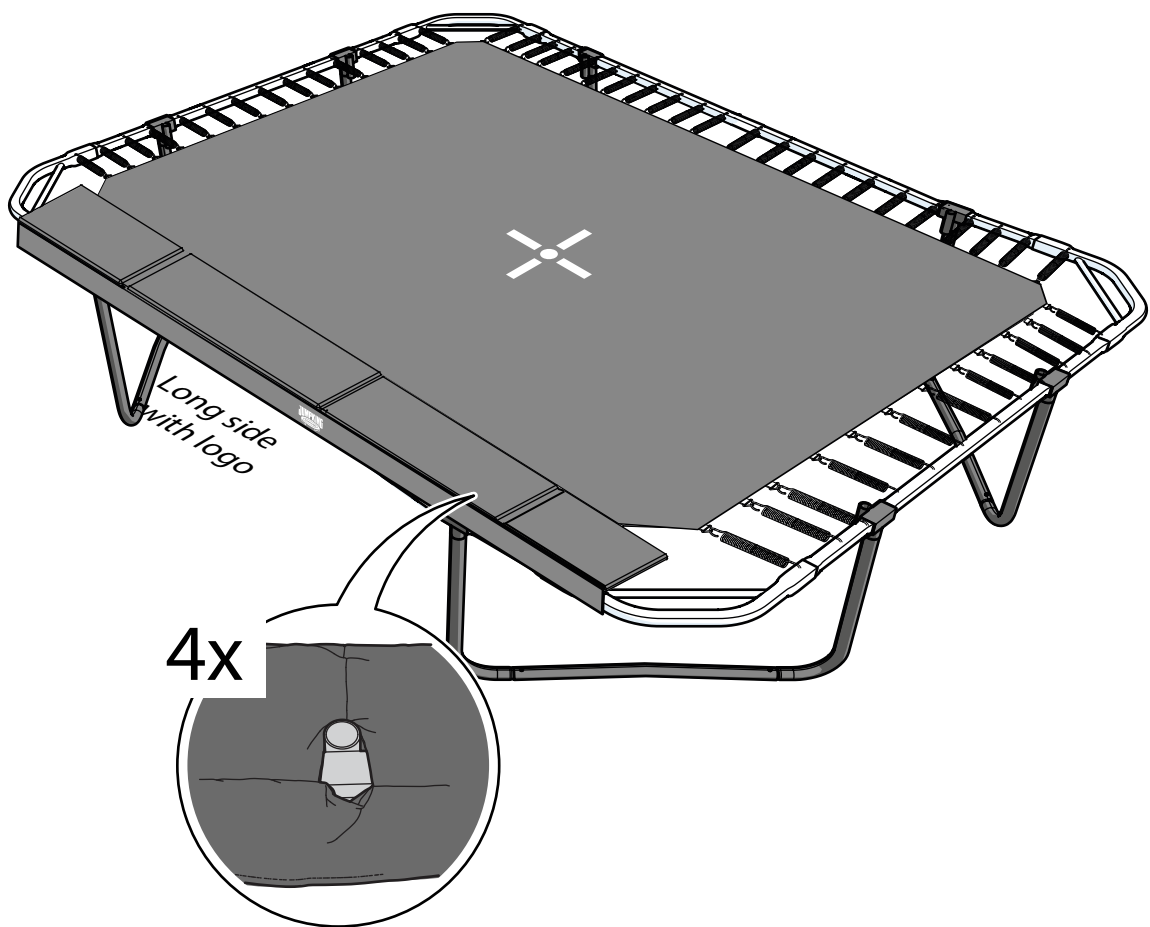

2

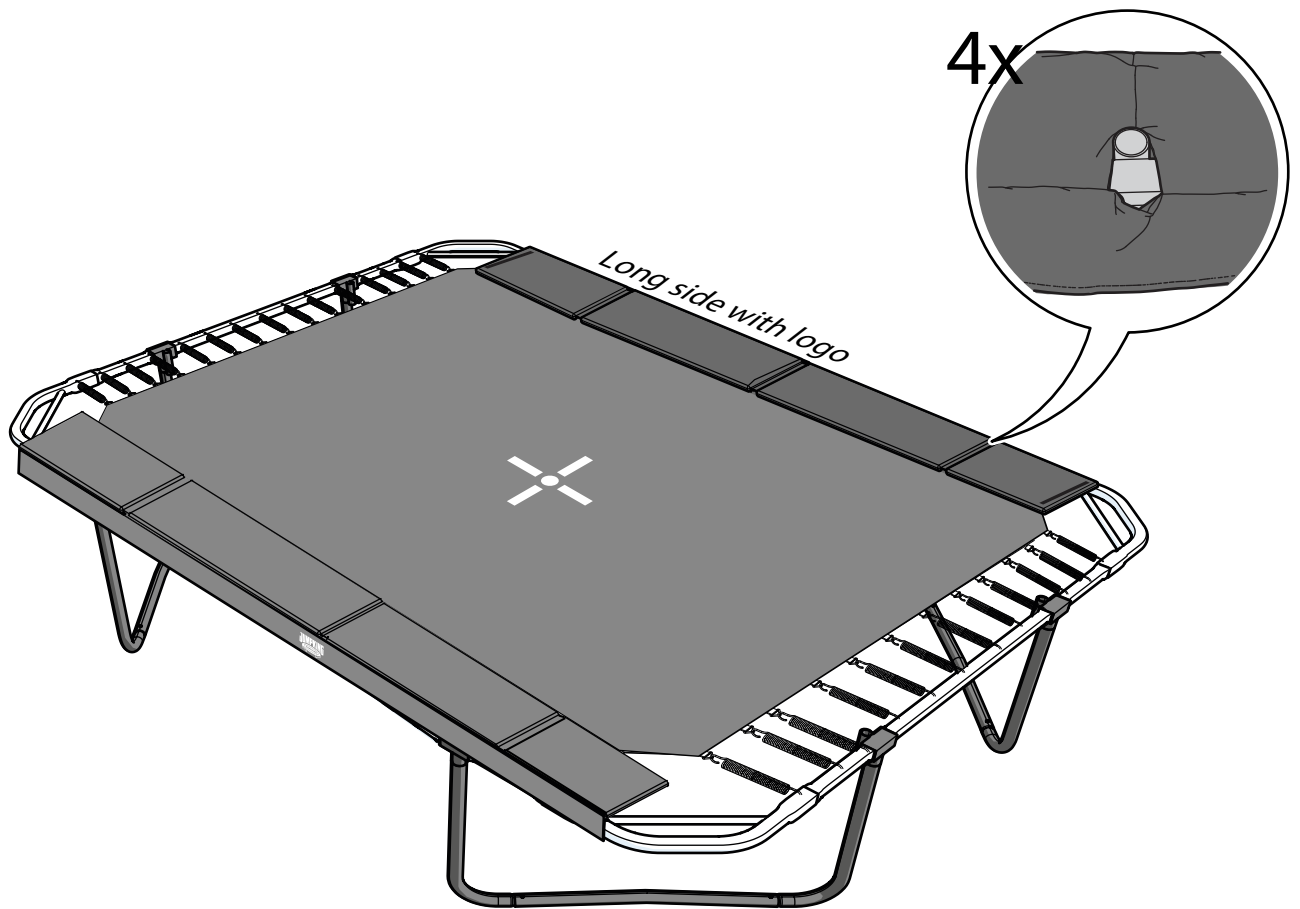

3

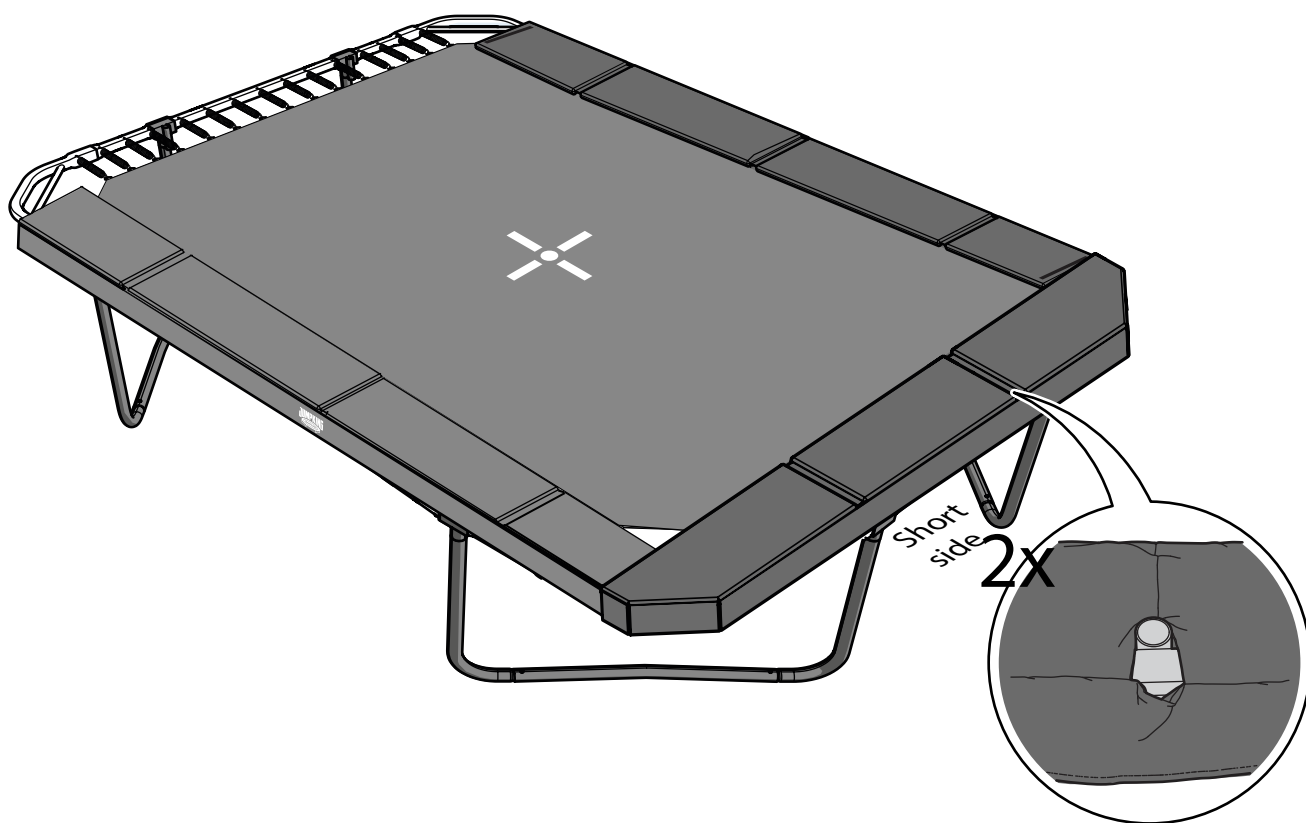

4

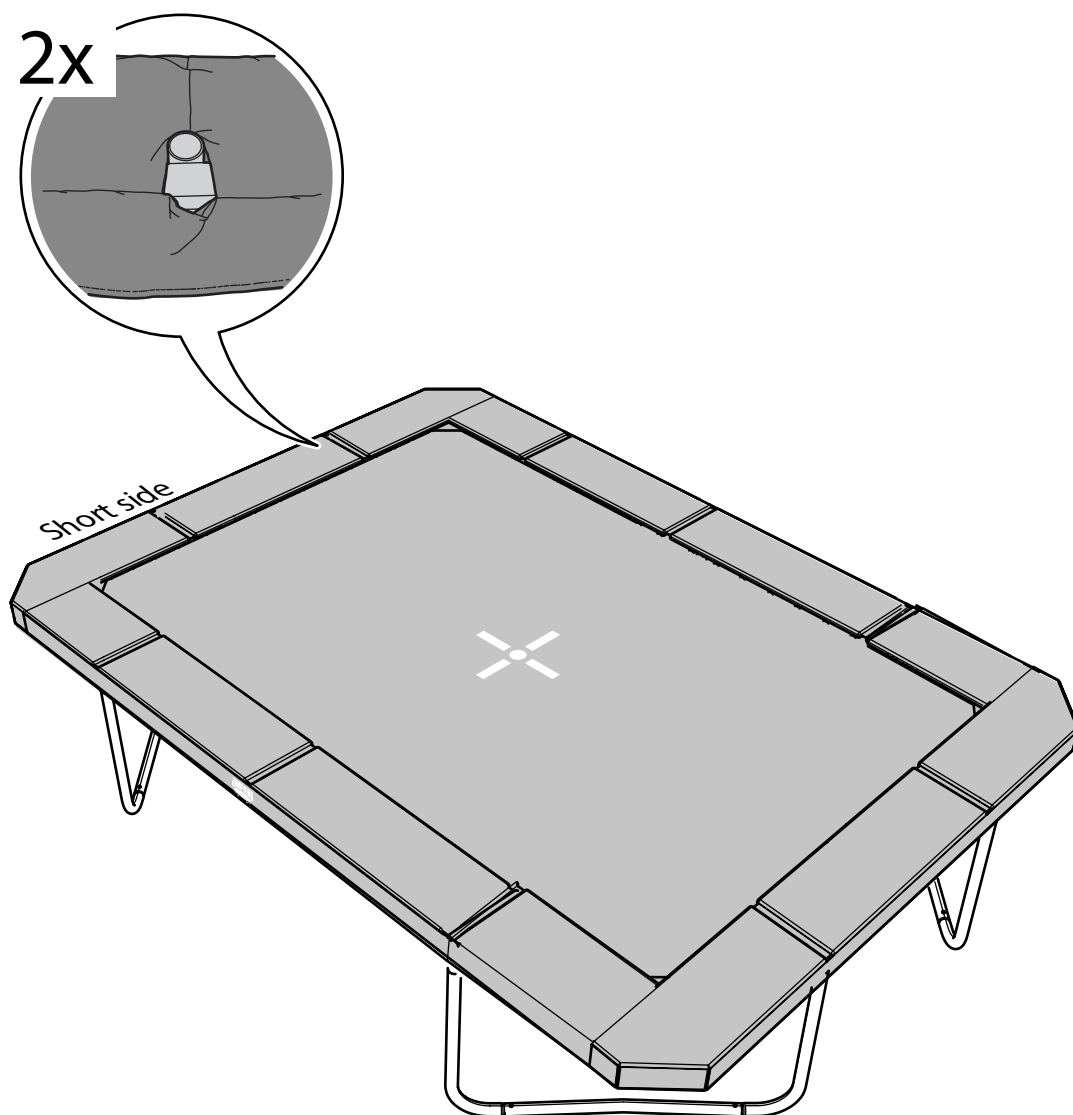

5

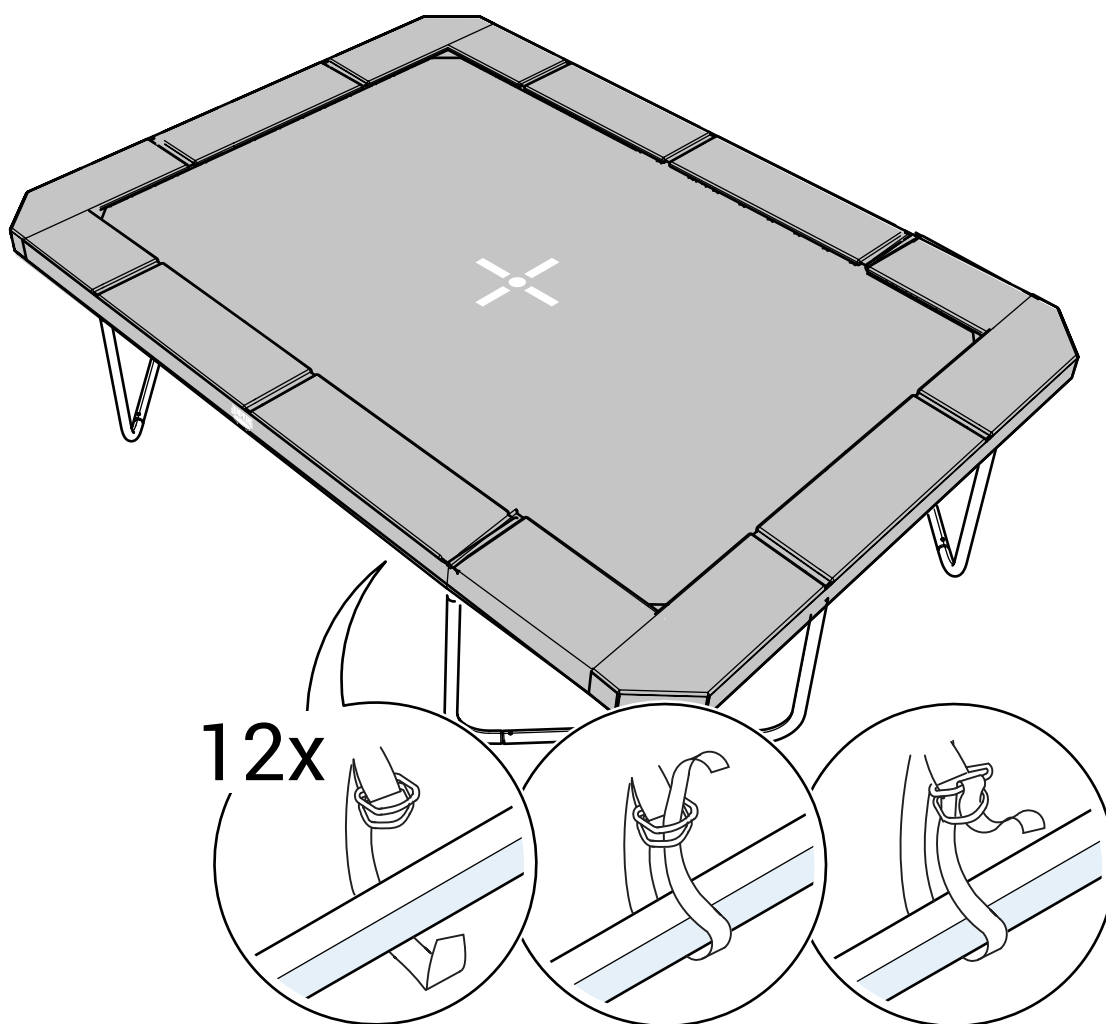

INSTALL THE ENCLOSURE NET POLES

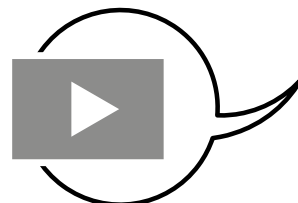
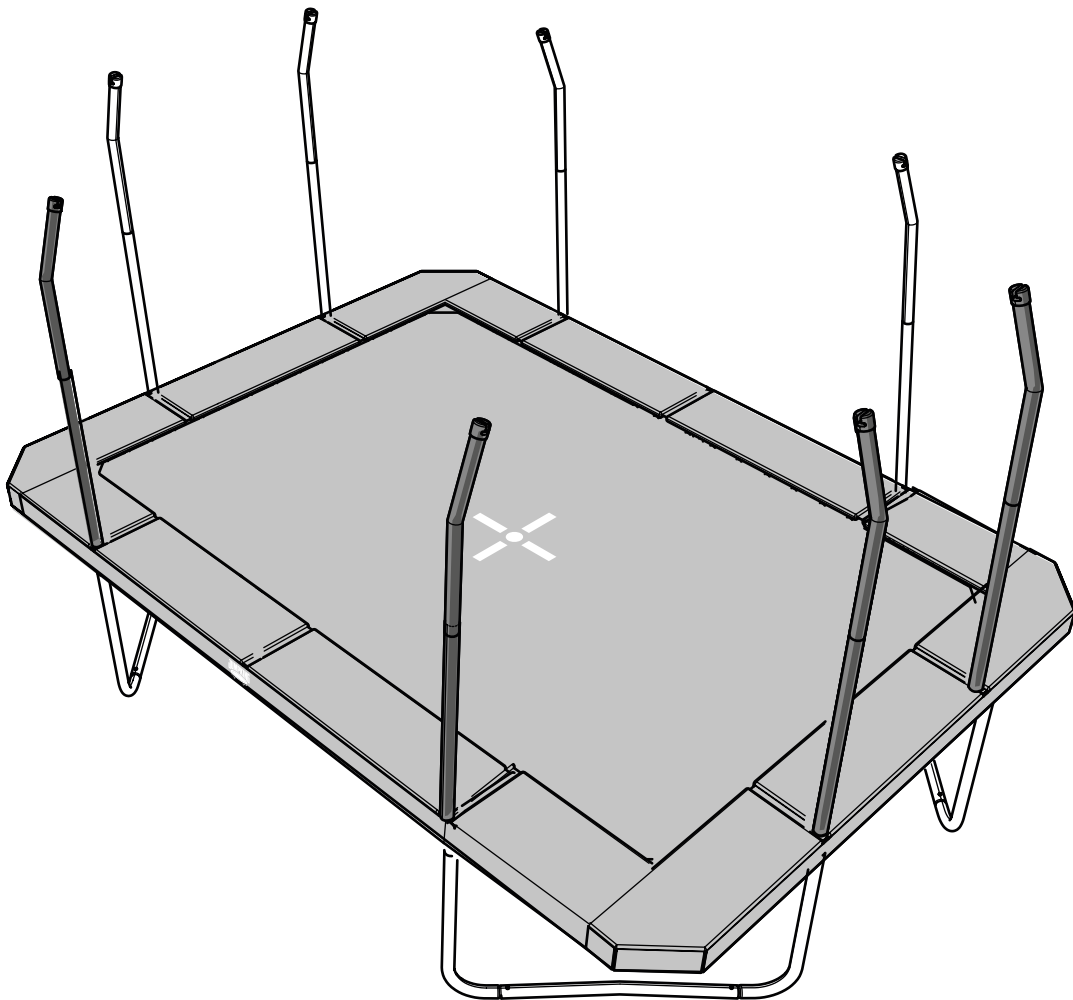

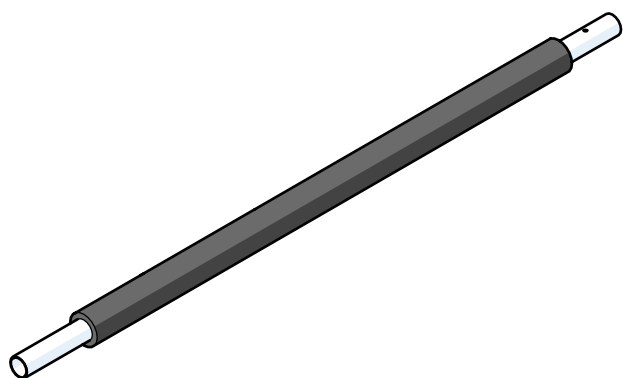
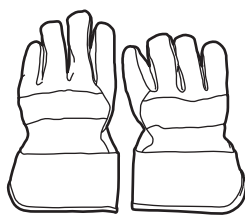
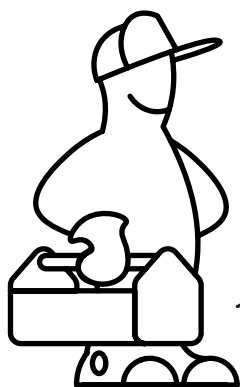

x8
(box 2)

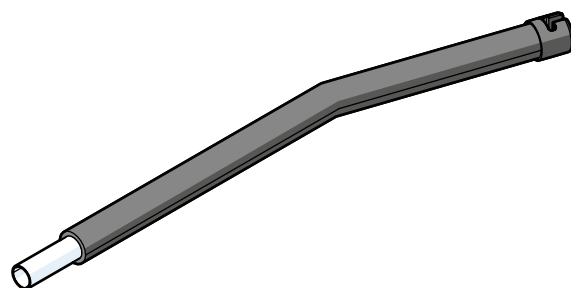

x8
(box 2)



x8
(box 1)

1

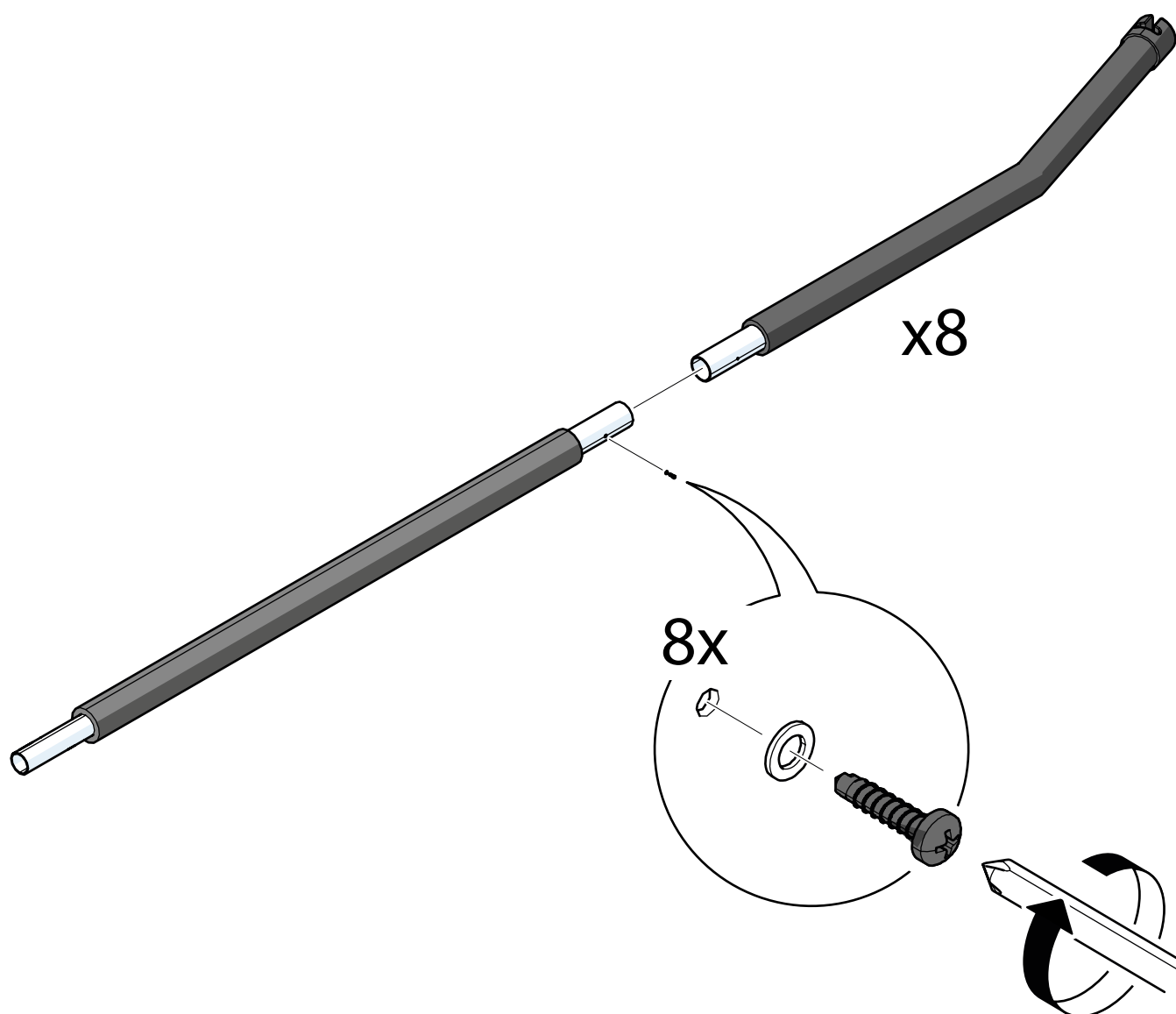

2

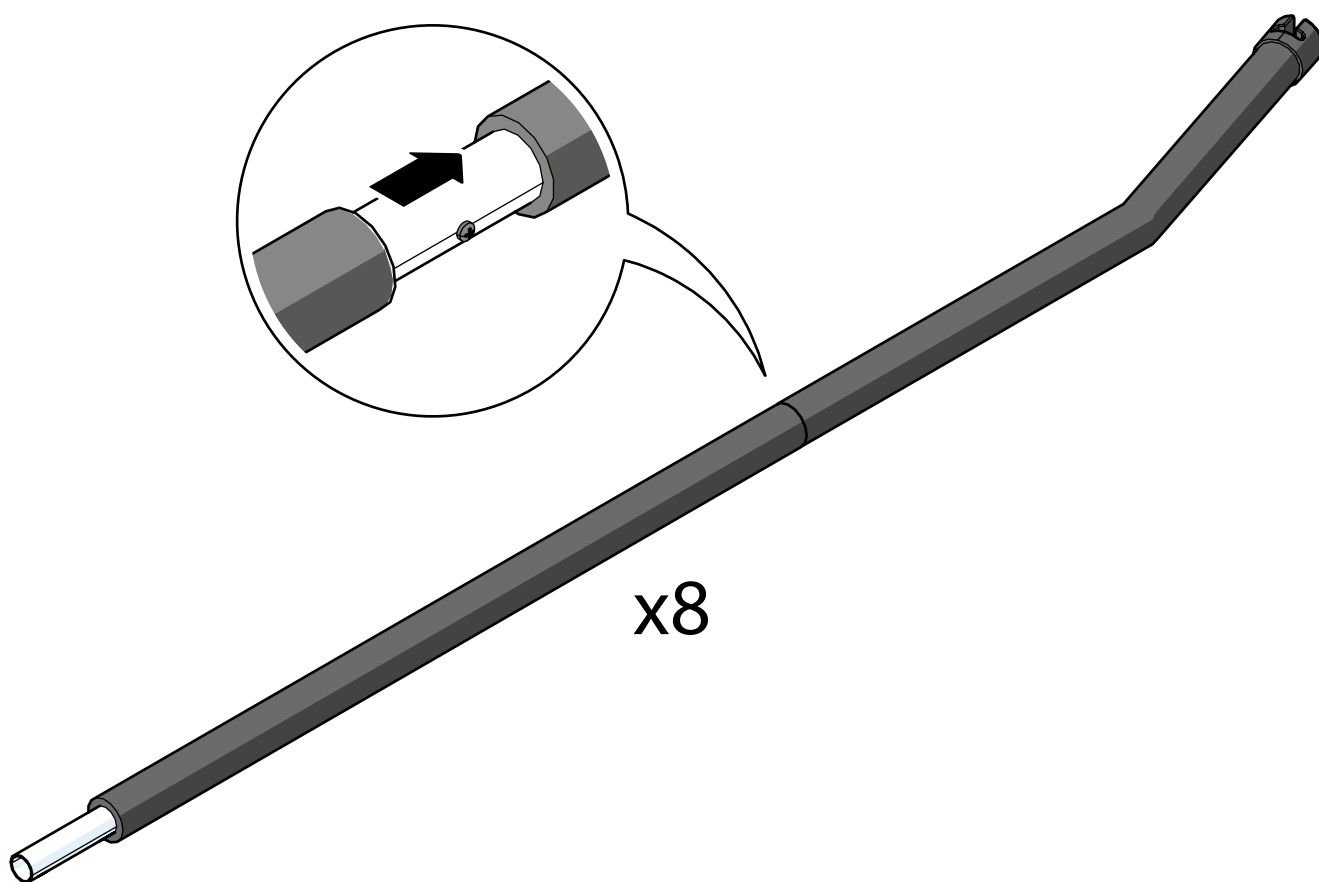

3

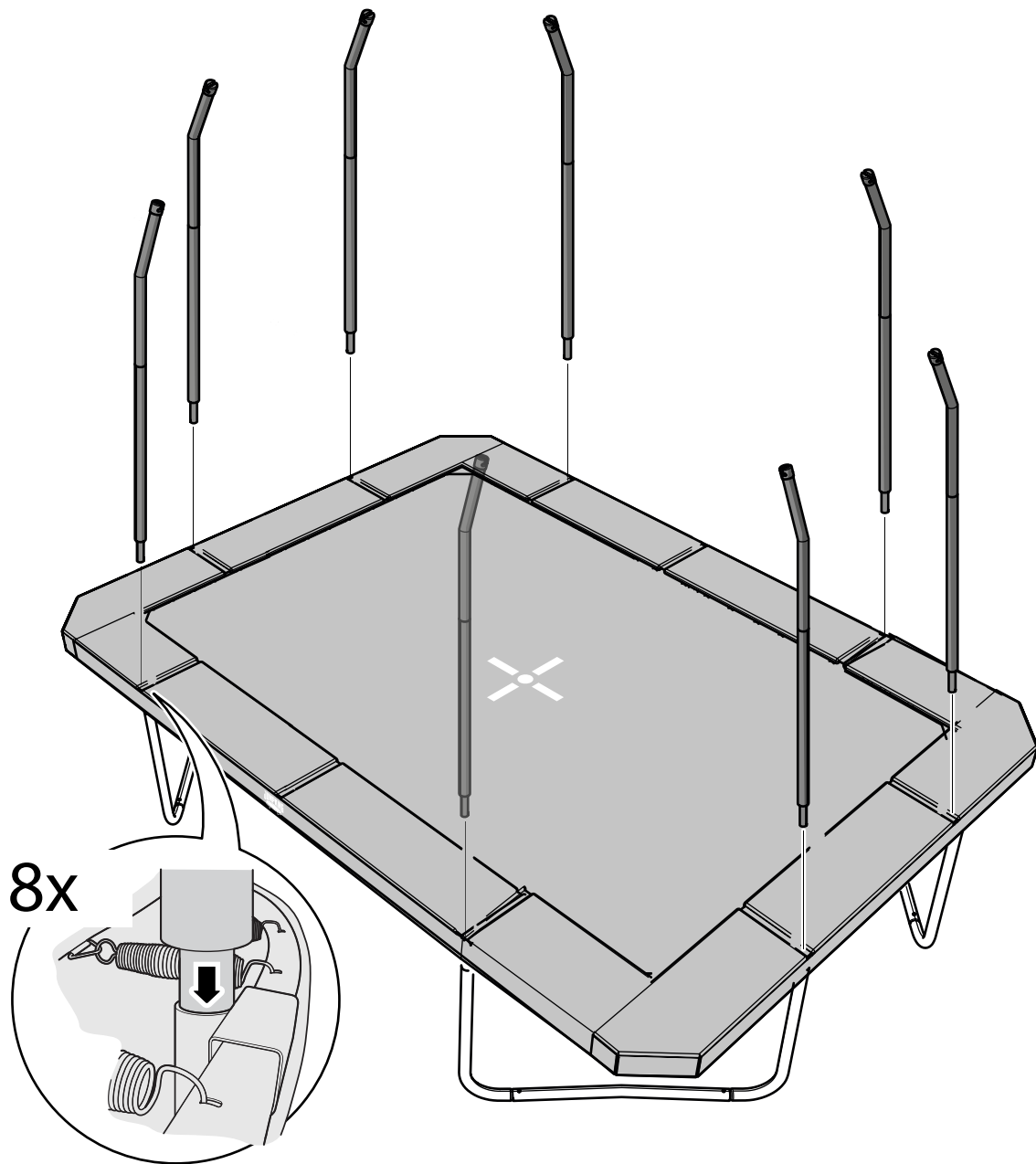

ATTACH THE TOP OF THE ENCLOSURE NET

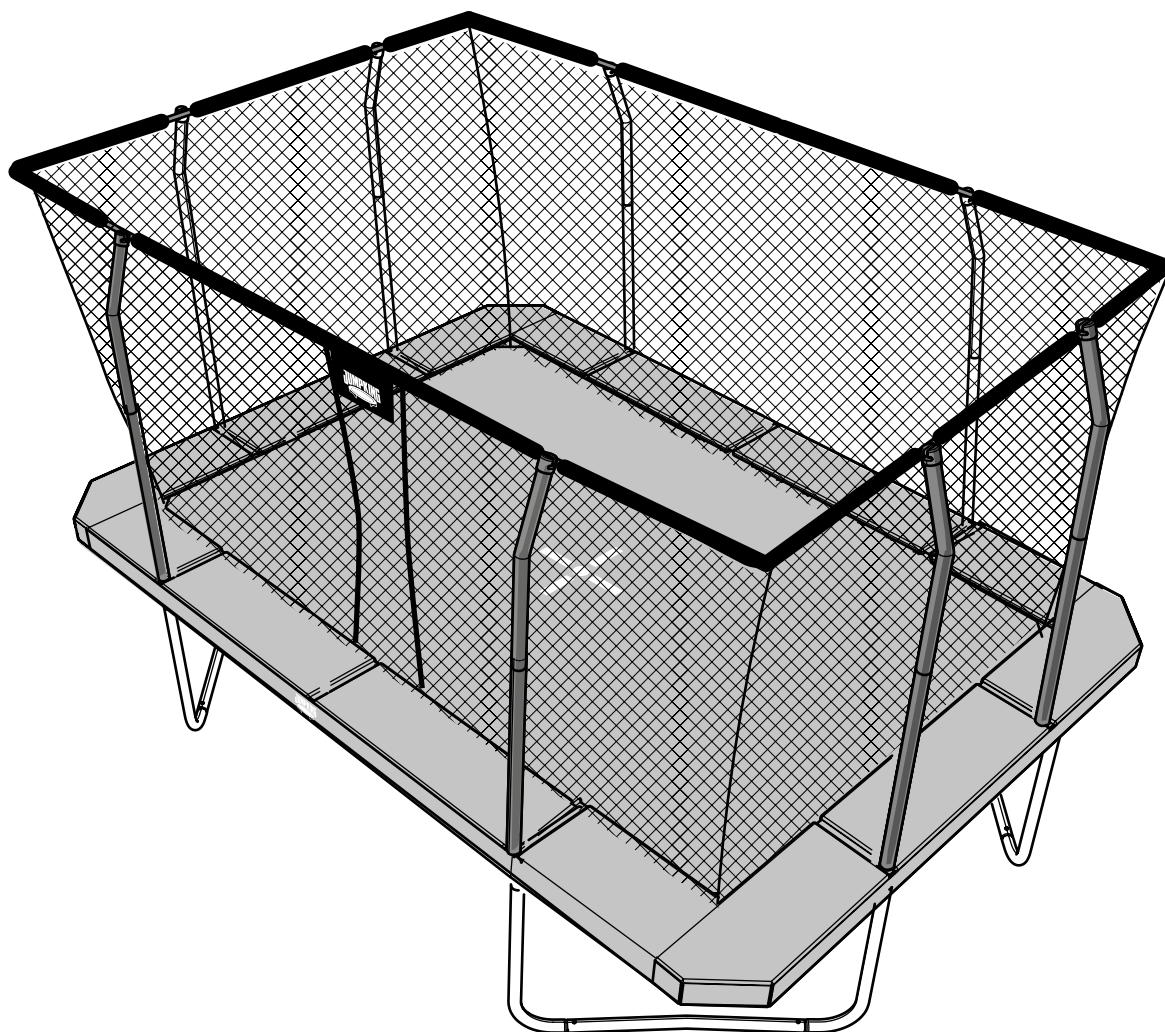

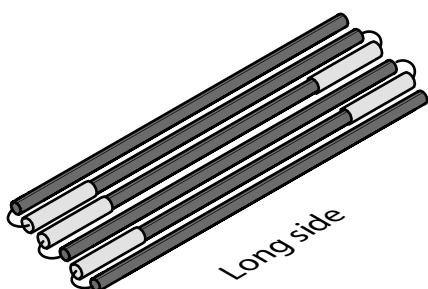
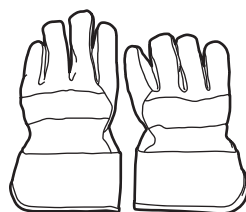
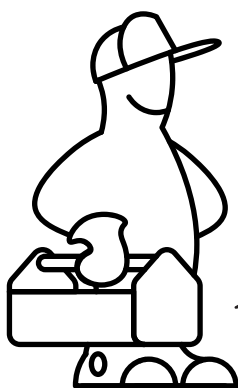

x2
(box 1)

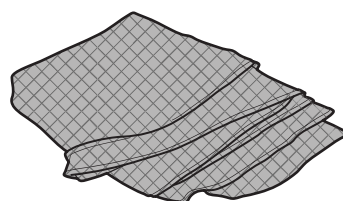

x1
(box 2)

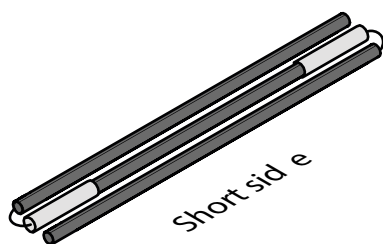

x2
(box 1)



x4
(box 1)

1

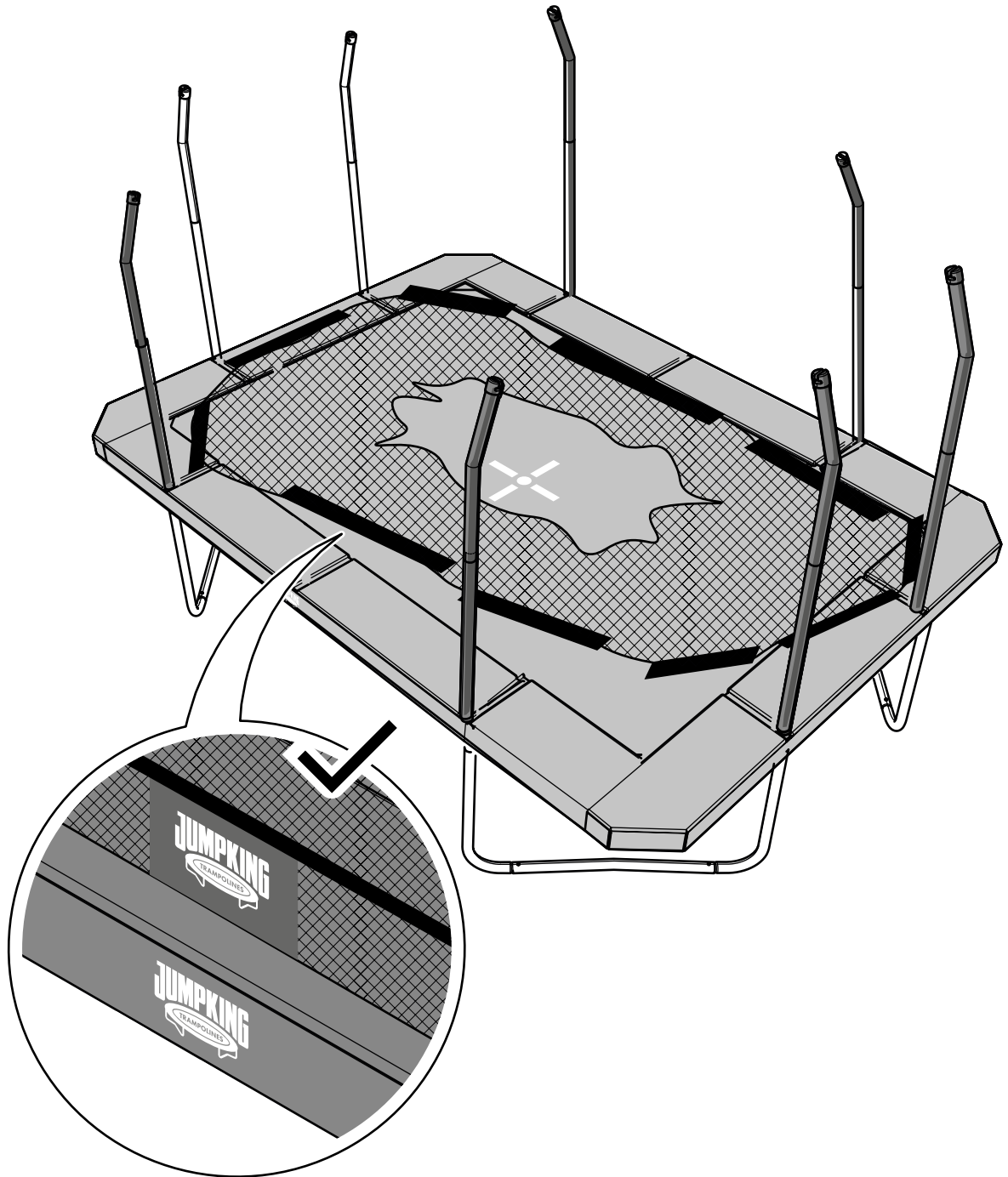

2

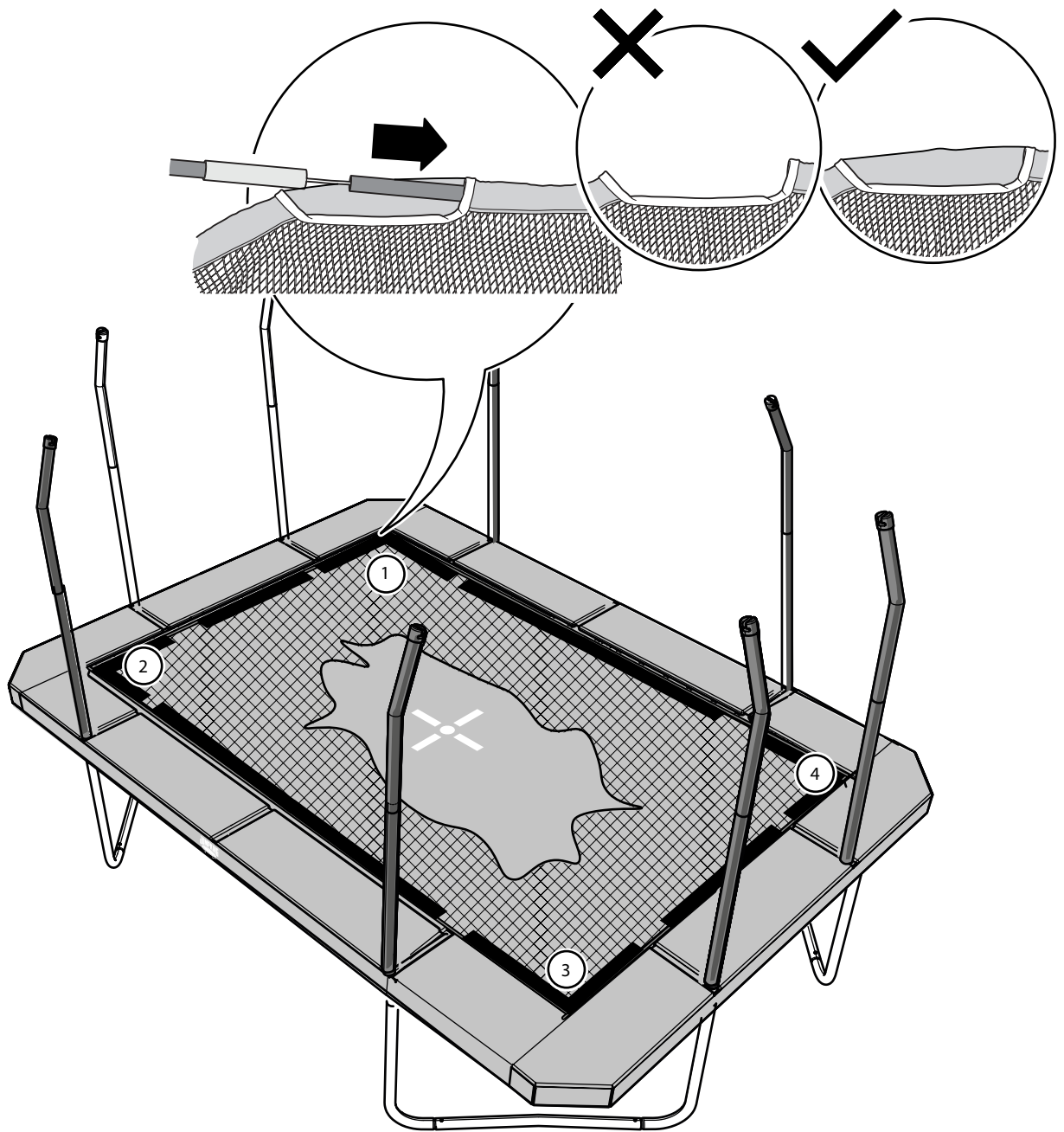

3

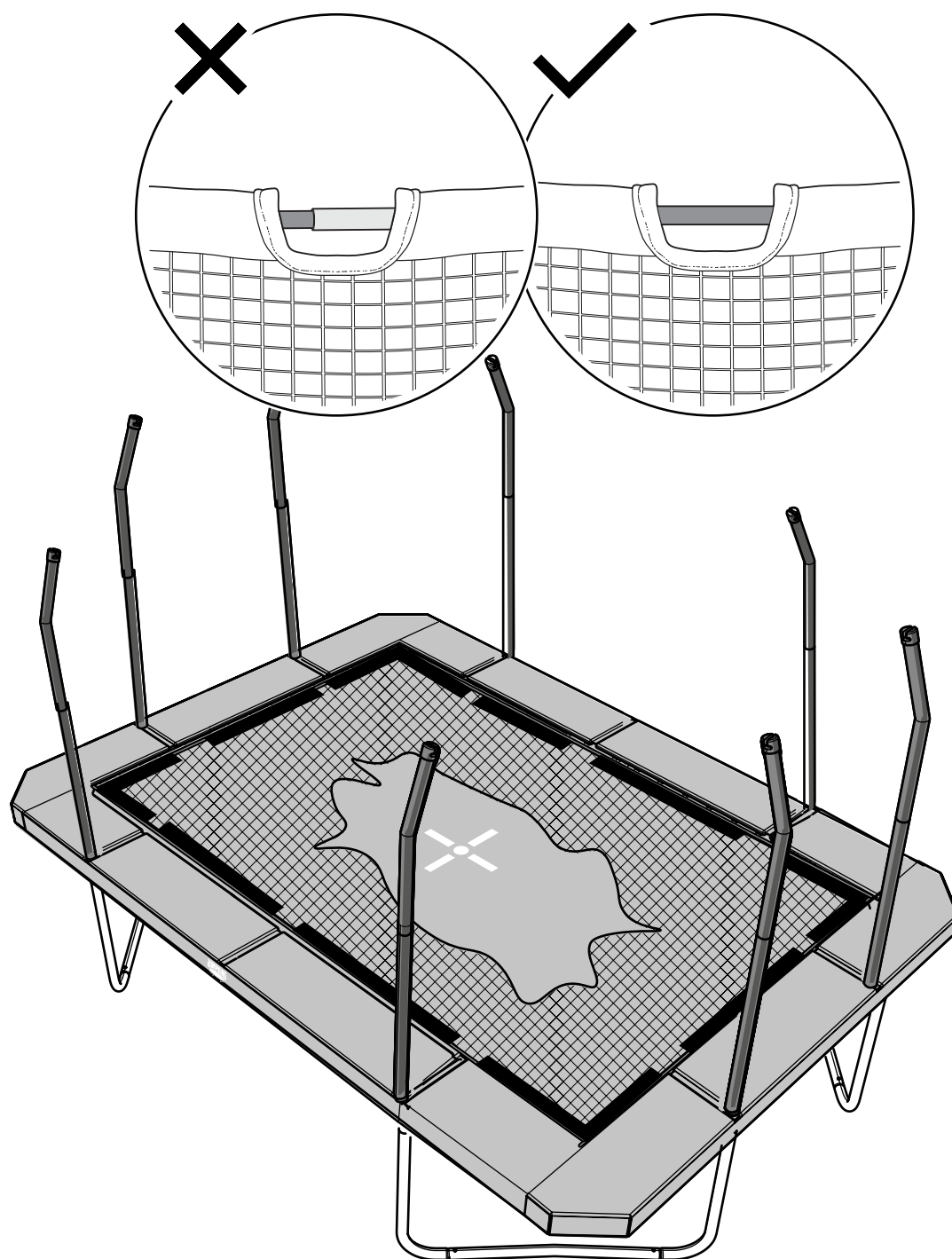

4

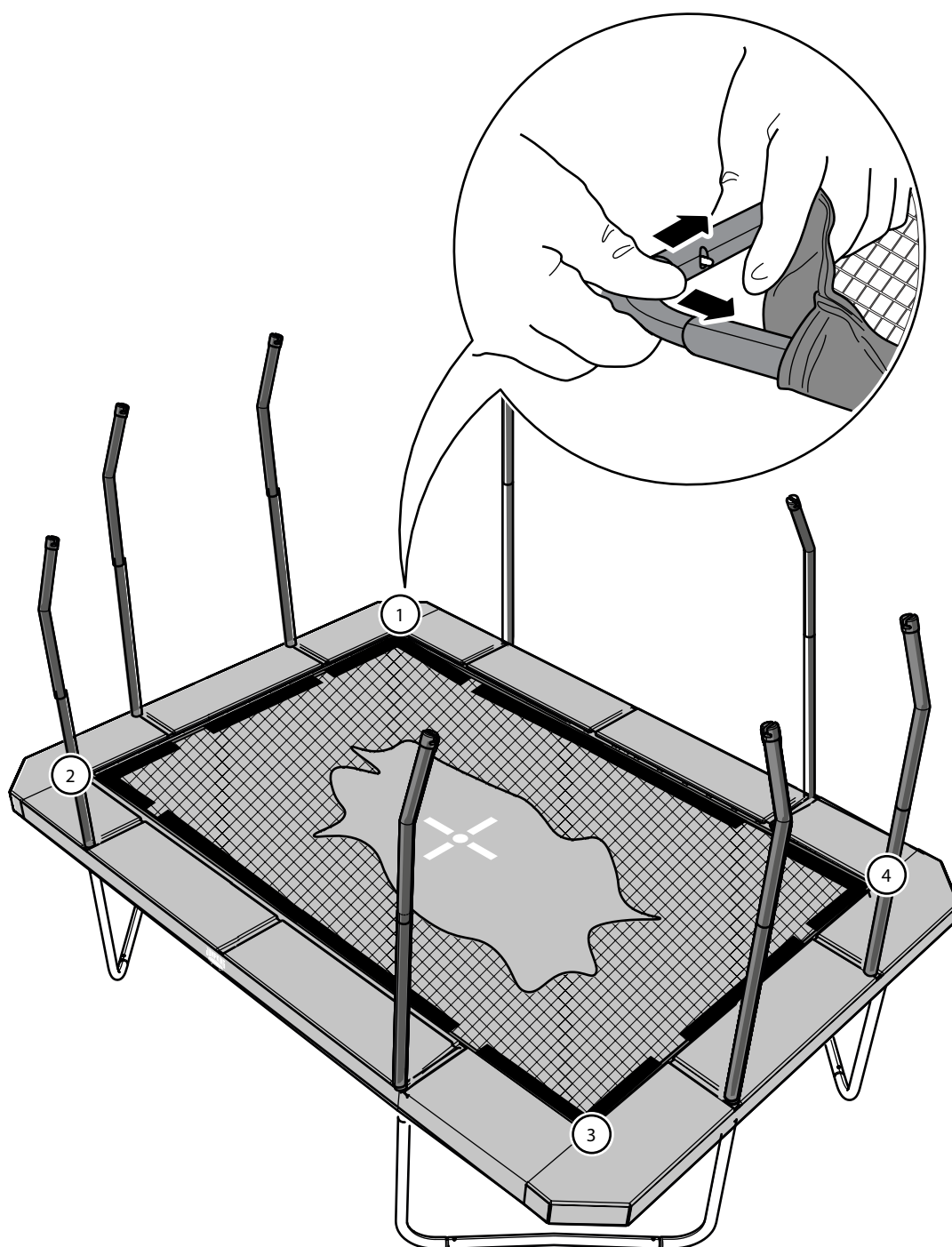

5

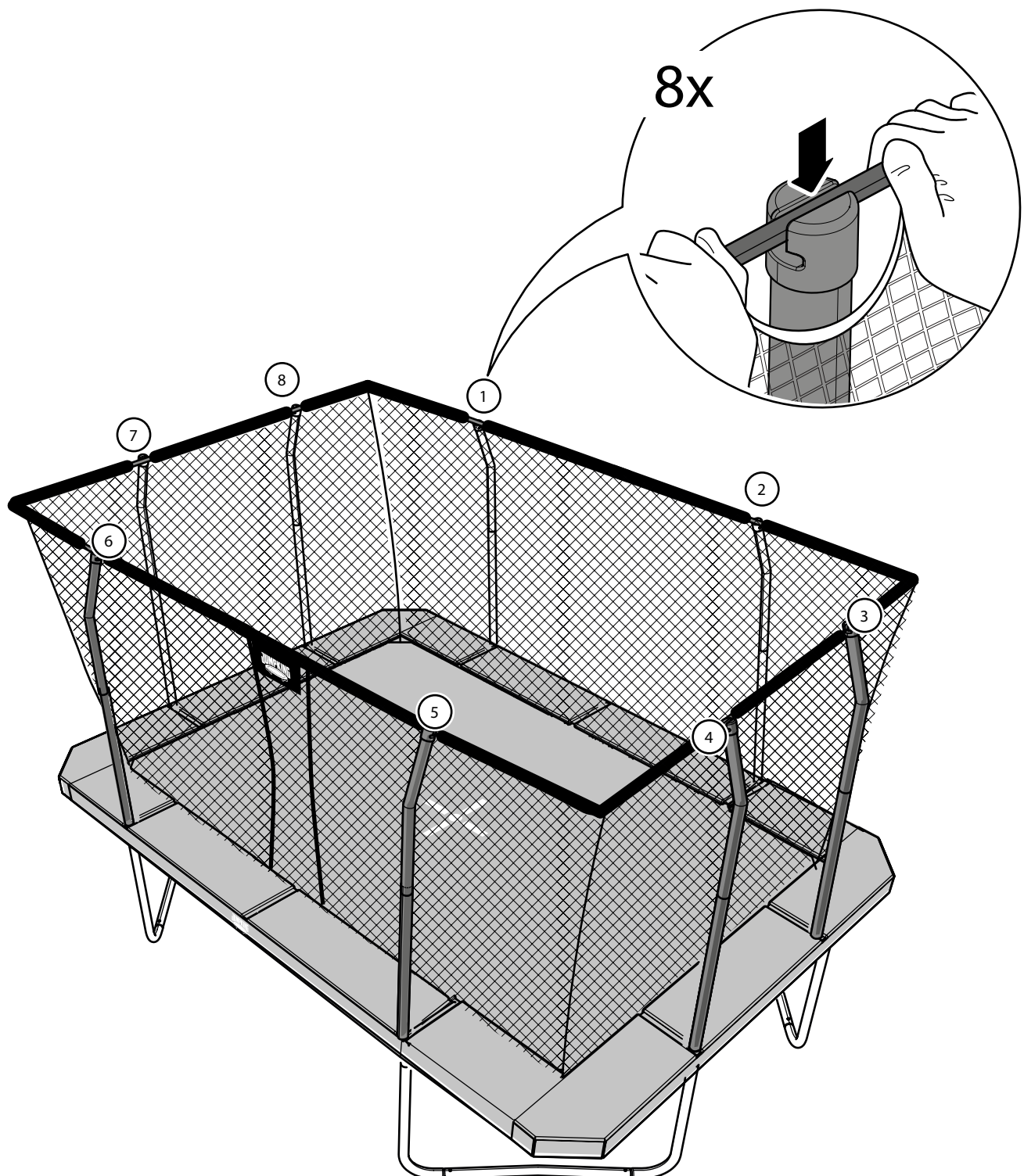

ATTACH THE BOTTOM OF THE ENCLOSURE NET

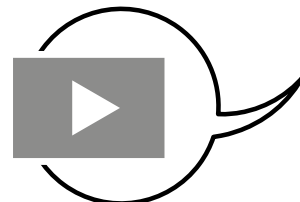
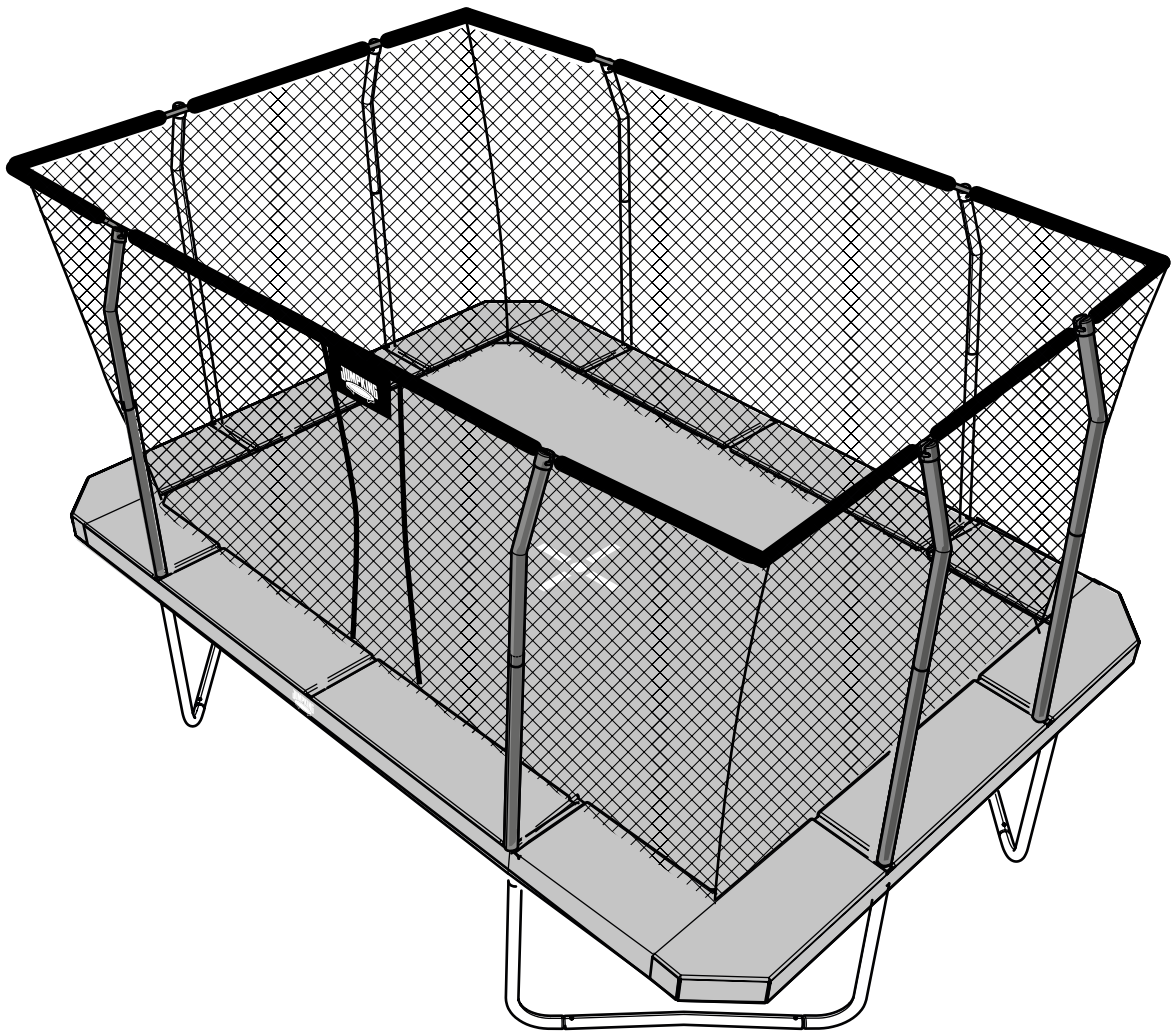

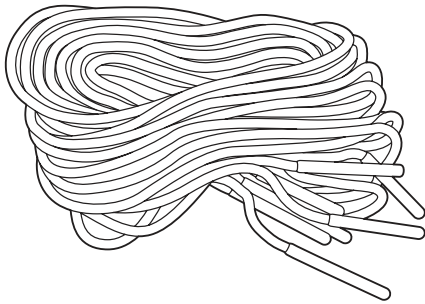

x8
(box 1)

1

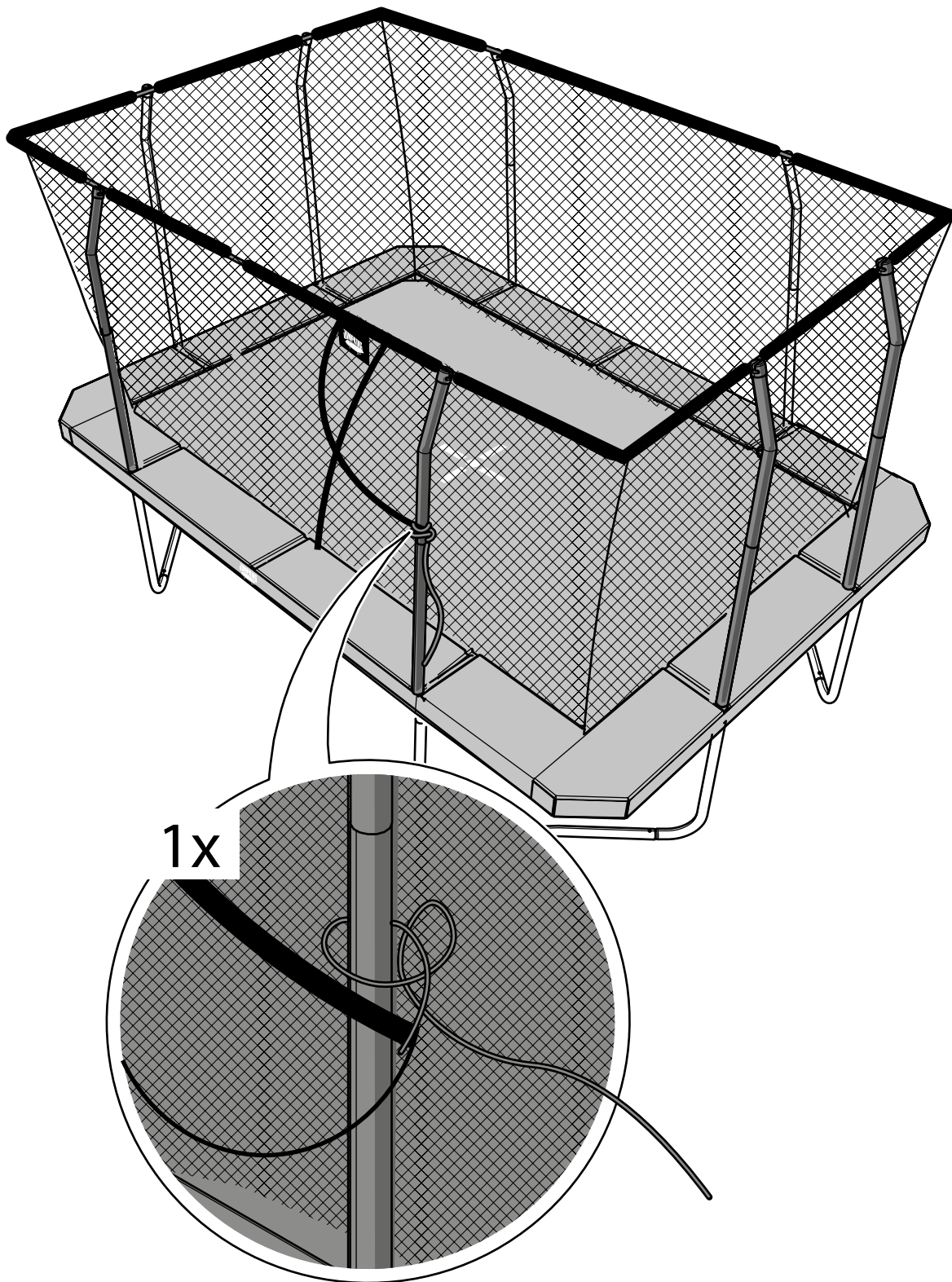

2

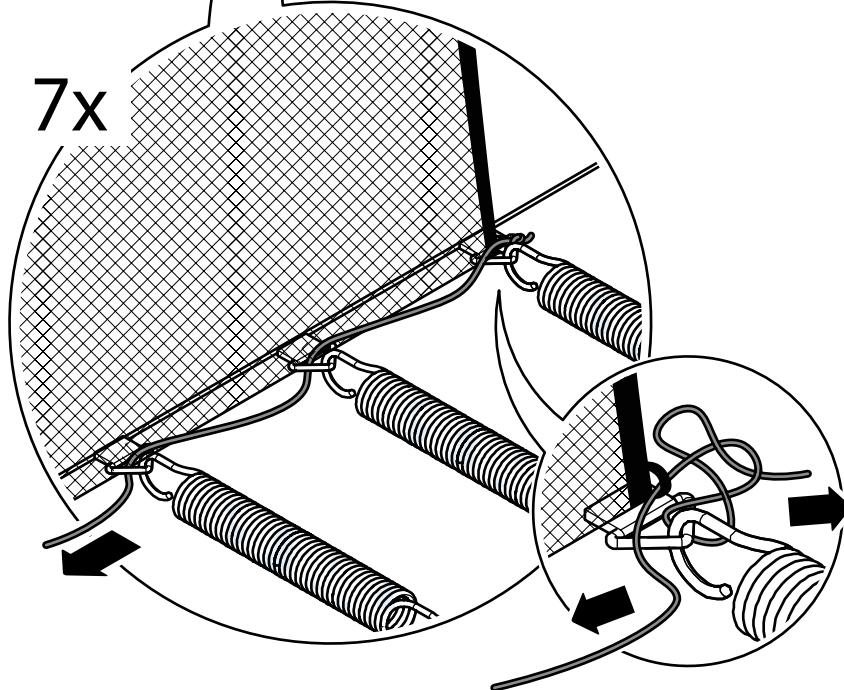
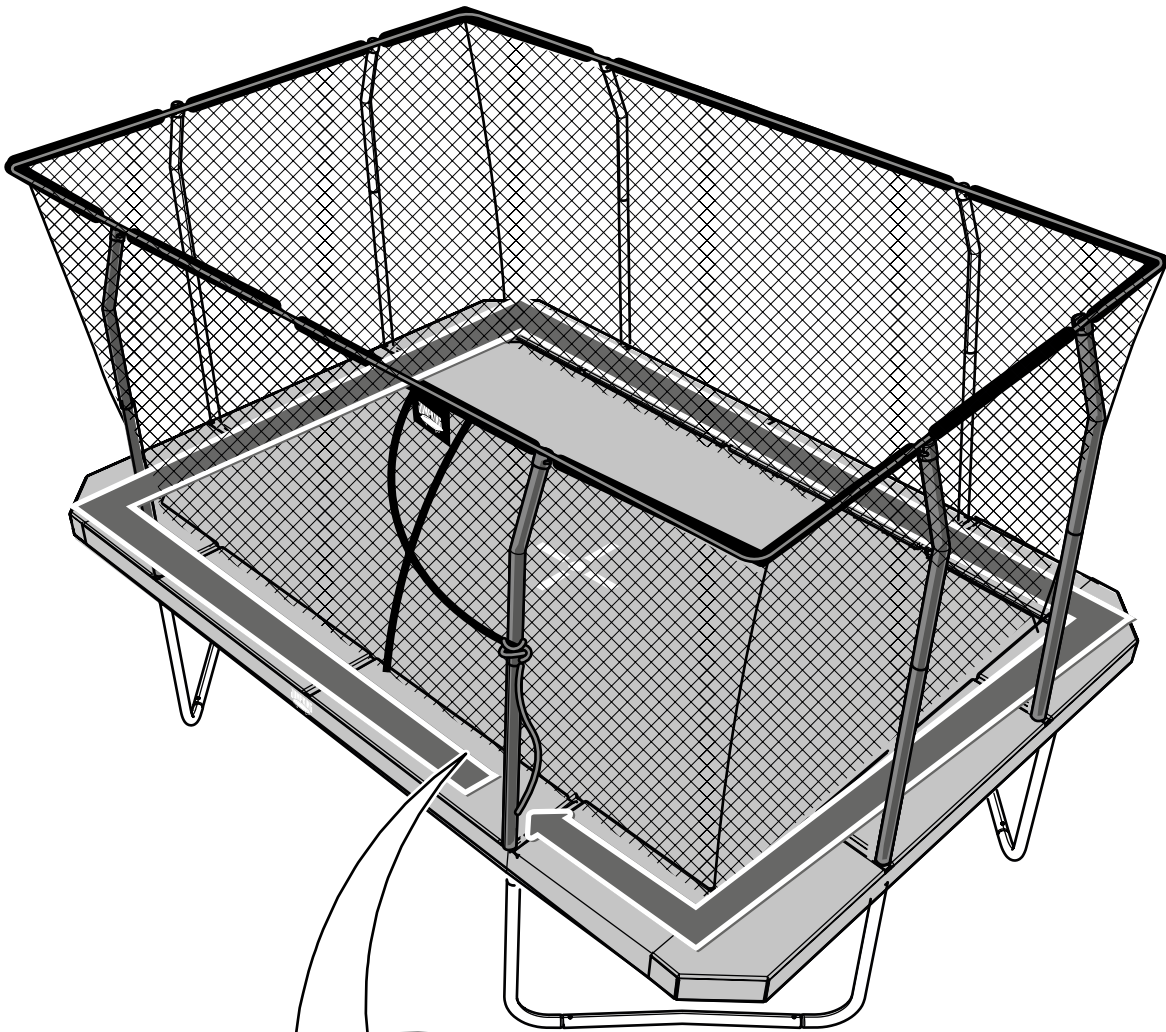

3

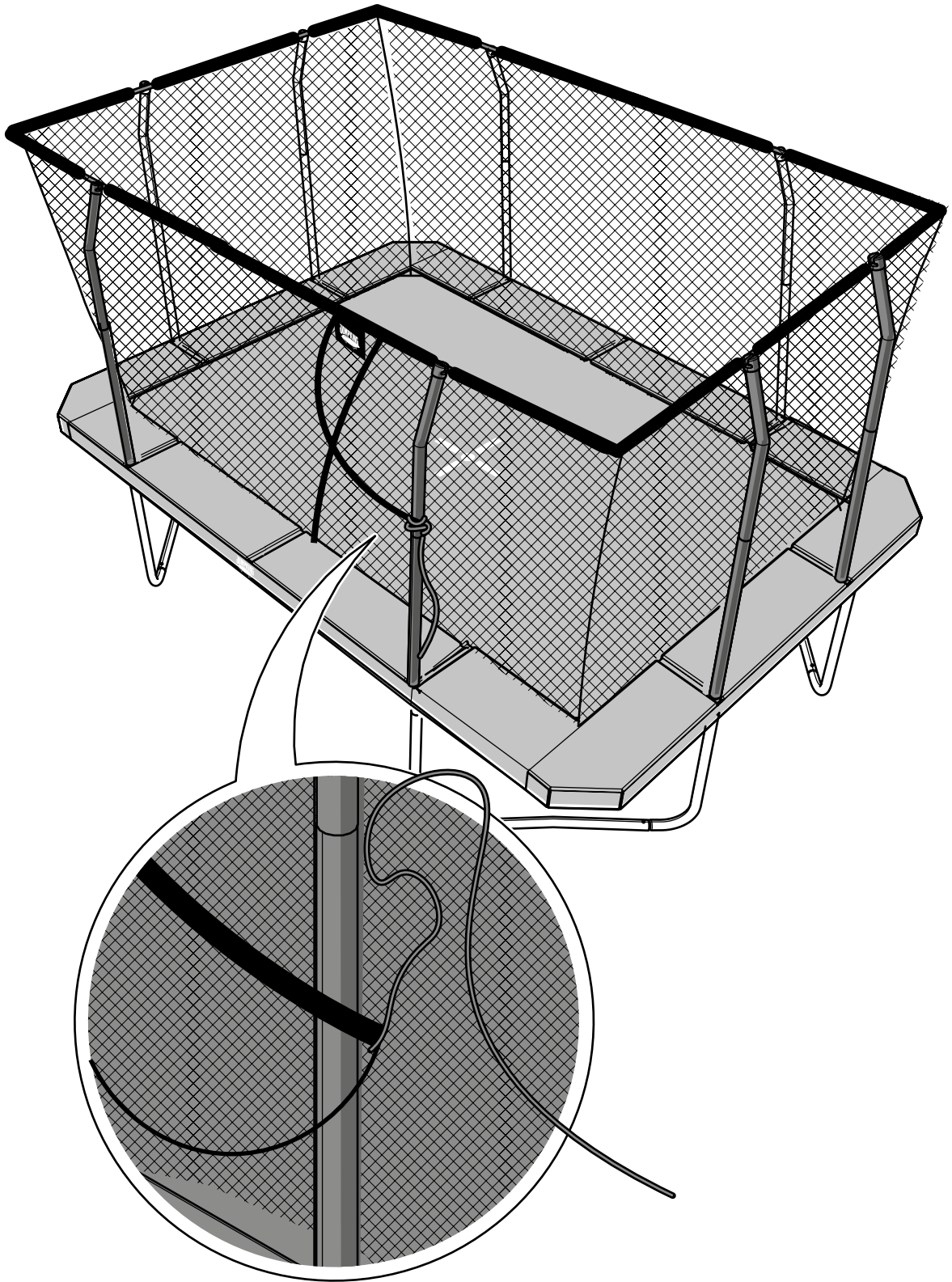

4

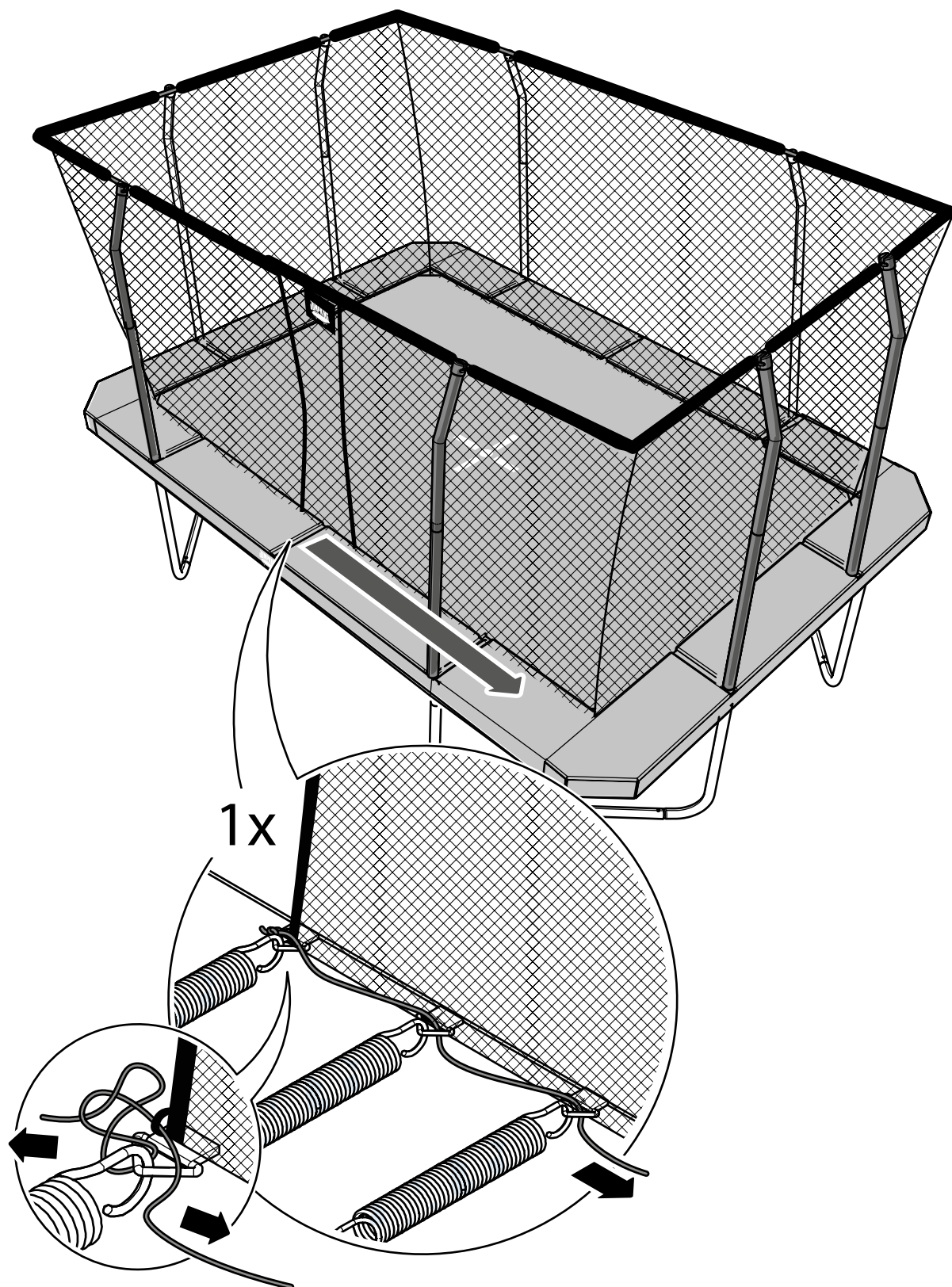

5

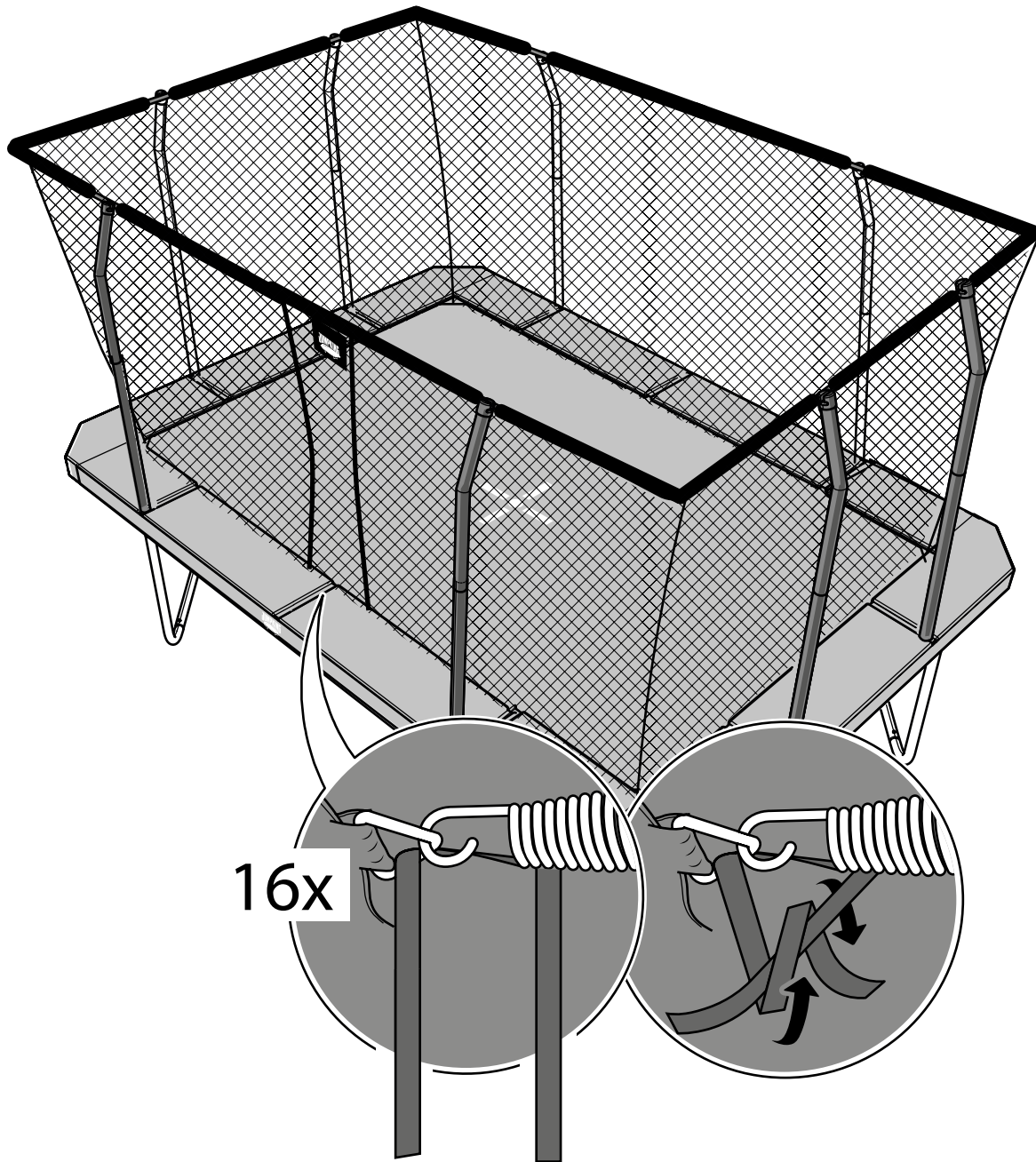

FRAME PART LIST

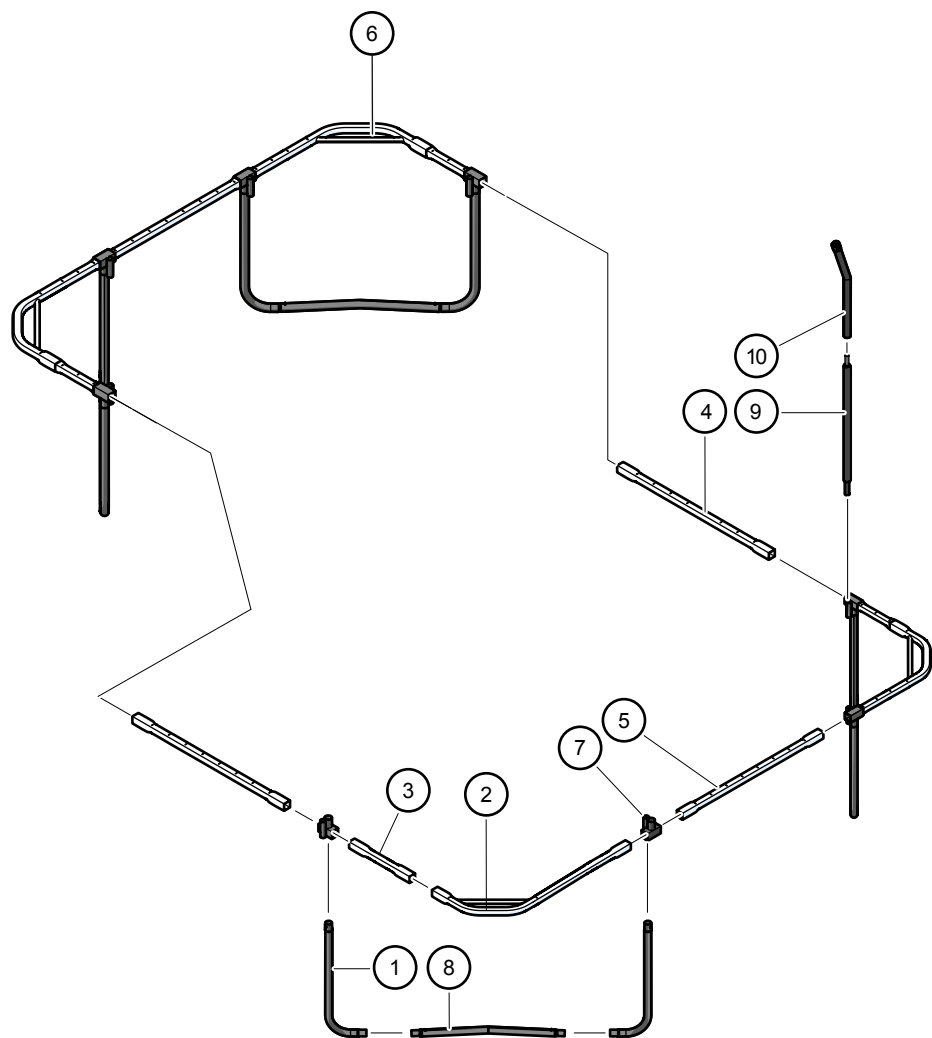

Pos	Description	Quantity
1	L-leg	8
2	L-Top tube "A"	2
3	Top tube "B"	4
4	Top tube "C"	2
5	Top tube "E"	2
6	L-top tube "D"	2
7	T-connector with 1 welded tube	8
8	Centre leg	4

Pos	Description	Quantity
9	Bottom pole rectangular 32 mm	8
10	Top pole rectangular 32 mm	8

SPARE PART LIST

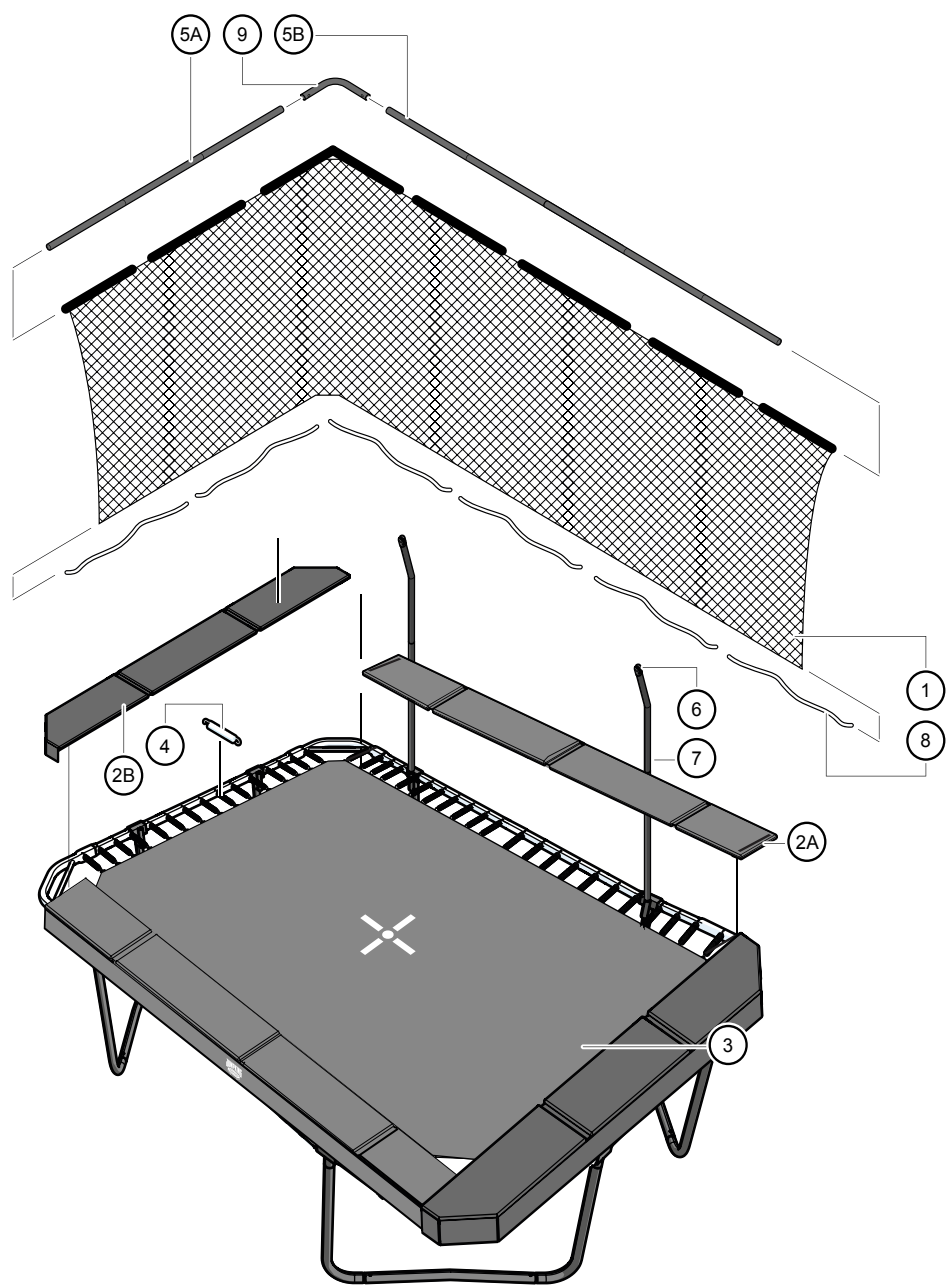

Pos	Description	Quantity
1	Enclosure net	1
2A	Frame pad (long)	2
2B	Frame pad (short)	2
3	Bed	1
4	Spring	72
5A	G3 set (short)	2
5B	G3 set (long)	2
6	G3 cap	8
7	Foam sleeve	16

Pos	Description	Quantity
8	Enclosure net cord	8
9	G3 connector	4
-	Spring tool	1
-	Self tapping screw	24

